

Features

- 1 **Small and low profile design (12mm height)**
- 2 **Excellent high frequency characteristic for ETC* frequency**
- 3 **Wide key and pin count varieties**
- 4 **Through hole reflow**

*Electric Toll Collection system

Dimensions

Receptacle

GT36A-4P-DSA

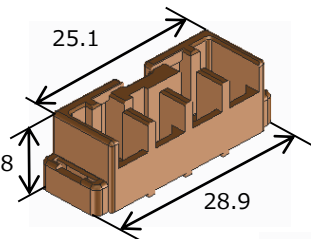

Plug

Housing : GT36A-4S-HU
Cover : GT36A-4S-HU

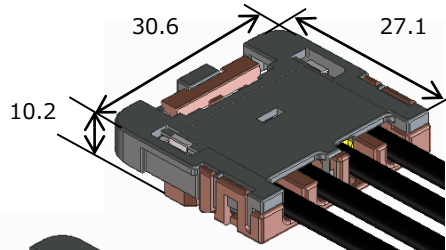

Mated

12

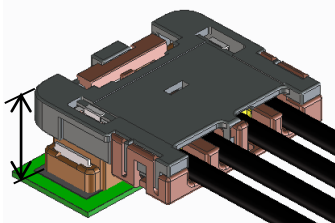

Excellent Contact Design for ETC* Frequency Range (5.9GHz)

[Contact for GPS, Mobile, Bluetooth]
Up to 2.5GHz V.S.W.R. 1.5 Max.

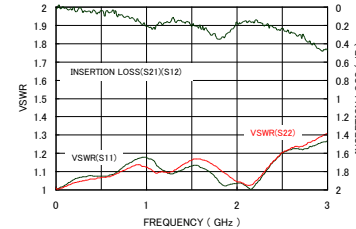

[Contact for ETC*]
Up to 5.9GHz V.S.W.R. 1.5 Max.

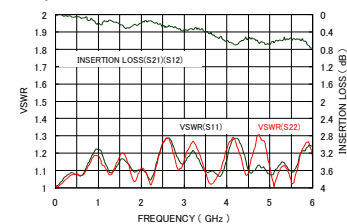

Specifications

Rated Current	1A
Rated Voltage	50V DC
Operating Temperature	-40 to +105°C*
Contact Resistance	50mΩ Max. (1A DC)
Withstanding Voltage	125V AC for 1 min.
Insulation Resistance	100MΩ Min. (500V DC)
V.S.W.R	V.S.W.R. 1.5 Max. (Up to 5.9GHz) *Measured with GT36G

* Includes the temperature rise by current flow.