

MATERIALS AND FINISHES

BODY, OUTER CONDUCTOR: BRASS
PLATED TRI-M

COUPLING NUT, REAR BODY: BRASS
PLATED NICKEL

CONTACT PIN: BRASS
PLATED SILVER

CENTER CONDUCTOR: PHOSPHOR BRONZE
PLATED SILVER

INSULATOR: TEFLON

O-RING: SILICONE RUBBER

DUST CAP: PE

PERFORMANCE REQUIREMENTS:

FREQUENCY RANGE: 0-3000MHz
IMPEDANCE: 50 OHM
INSULATION RESISTANCE: 5000M OHM
WITHSTAND VOLTAGE(AC): 2000V @0.5mA
VSWR: ≤1.10(0-2200MHz); ≤1.15(2200-3000MHz)
PIM3(2x20W): ≤-145dBc @1800MHZ

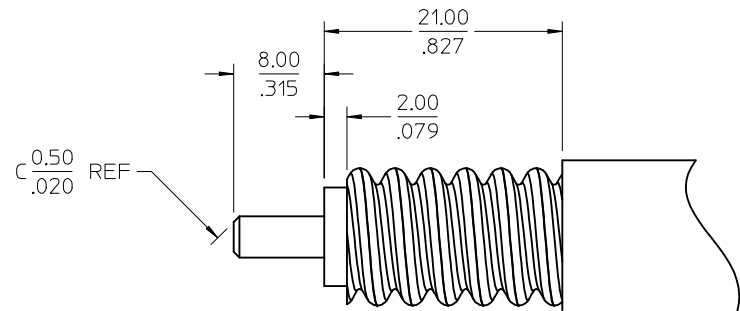
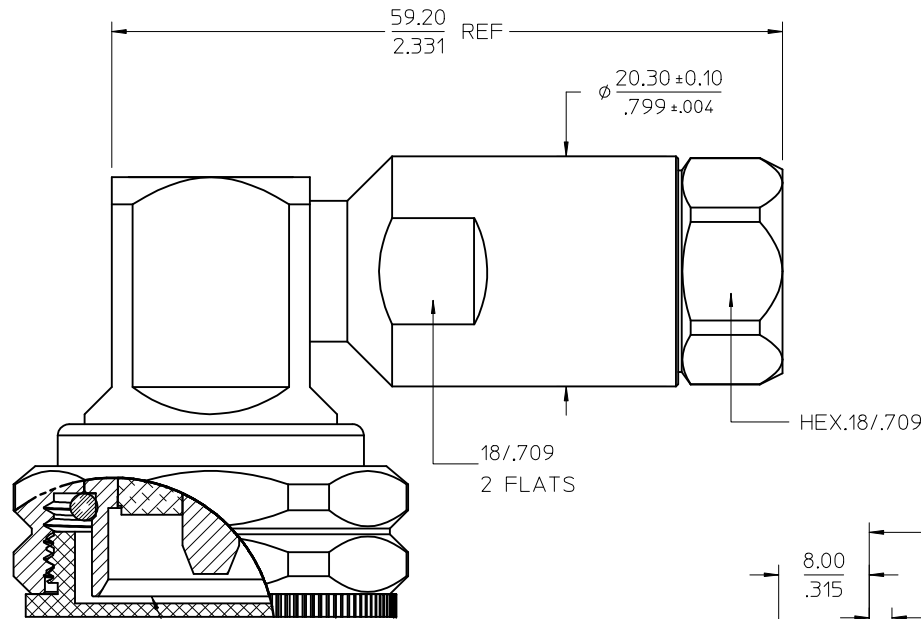
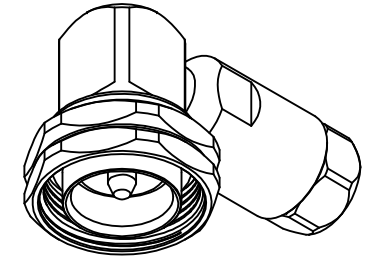

1/2 SUPERFLEXIBLE CABLE
RECOMMENDED STRIP DIMENSION

73134-0401	BOX
73134-0400	-----
PART NO.	PACKAGING

PS-89675-335	PRODUCT SPECIFICATION
IEC60169-4	INTERFACE
SPECIFICATION	DESCRIPTION

CHG: ADD PS. EC NO: URF2016-0361 DRWN:YHUANG11 2015/11/04 CHKD: APPR:MYE08 2015/11/06	QUALITY SYMBOLS ∇=0 ∇=0 ∇=0	GENERAL TOLERANCES (UNLESS SPECIFIED)	DIMENSION STYLE	SCALE	DESIGN UNITS	THIRD ANGLE PROJECTION
			MM/IN		METRIC	
		4 PLACES ± --- ± ---	DRAWN BY	DATE	TITLE	
		3 PLACES ± --- ± ---	YHUANG11	2013/07/22	7/16 PLUG R/A	
2 PLACES ± --- ± ---	CHECKED BY	DATE	50 OHM, FOR 1/2SF CA			
1 PLACE ± --- ± ---	MXU11	2013/07/22				
0 PLACE ± --- ± ---	APPROVED BY	DATE				
	SRZHAO	2013/10/25				
	ANGULAR ± 2 °	MATERIAL NO.	DOCUMENT NO.	SHEET NO.		
	DRAFT WHERE APPLICABLE MUST REMAIN WITHIN DIMENSIONS	SEE TABLE	SD-73134-040	1 OF 1		
THIS DRAWING CONTAINS INFORMATION THAT IS PROPRIETARY TO MOLEX INCORPORATED AND SHOULD NOT BE USED WITHOUT WRITTEN PERMISSION						