

PCB LAYOUT: COMPONENT SIDE 4 TO 8 CKT  
RECOMMEND PCB THICKNESS: 1.57mm

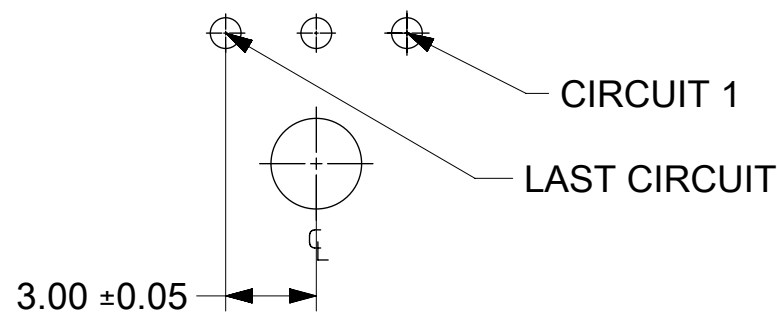

PCB LAYOUT: 3 CKT HEADER

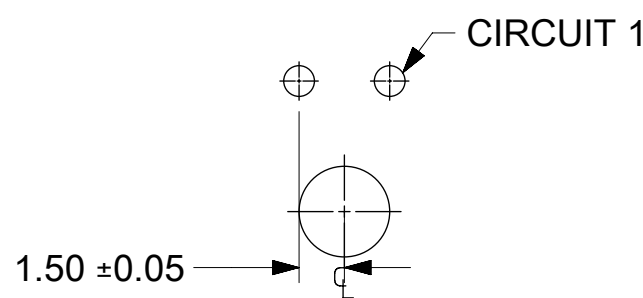

PCB LAYOUT: 2 CKT HEADER

TIN PLATING					
CIRCUIT	PART NUMBER	A	B	C	D
2	215760-1002	6.85	3.00	NA	2.95
3	215760-1003	9.85	6.00	NA	2.95
4	215760-1004	12.85	9.00	4.70	7.70
5	215760-1005	15.85	12.00	7.70	10.70
6	215760-1006	18.85	15.00	10.70	13.70
7	215760-1007	21.85	18.00	13.70	16.70
8	215760-1008	24.85	21.00	16.70	19.70

15 MICROINCH GOLD					
CIRCUIT	PART NUMBER	A	B	C	D
2	215760-2002	6.85	3.00	NA	2.95
3	215760-2003	9.85	6.00	NA	2.95
4	215760-2004	12.85	9.00	4.70	7.70
5	215760-2005	15.85	12.00	7.70	10.70
6	215760-2006	18.85	15.00	10.70	13.70
7	215760-2007	21.85	18.00	13.70	16.70
8	215760-2008	24.85	21.00	16.70	19.70

30 MICROINCH GOLD					
CIRCUIT	PART NUMBER	A	B	C	D
2	215760-3002	6.85	3.00	NA	2.95
3	215760-3003	9.85	6.00	NA	2.95
4	215760-3004	12.85	9.00	4.70	7.70
5	215760-3005	15.85	12.00	7.70	10.70
6	215760-3006	18.85	15.00	10.70	13.70
7	215760-3007	21.85	18.00	13.70	16.70
8	215760-3008	24.85	21.00	16.70	19.70

LEGEND

215760 - \* \* \* \*

SERIES NO. \_\_\_\_\_

PLATING OPTION  
1 :TIN  
2: 15MICROINCH AU  
3. 30MICROINCH AU

CKT NO. \_\_\_\_\_

NOTES:

- HOSING MATERIAL: GLASS FILLED LIQUID CRYSTAL POLYMER, UL 94V-0, GLOW WIRE ,COLOR: BLACK  
TERMINAL MATERIAL: HIGH COPPER ALLOY
- FINISH:  
OPTION 1: REFLOW MATTE TIN OVER NICKEL  
OPTION 2: SELECT 15MICROINCH GOLD AND SELECT MATTE TIN OVER NICKEL.  
OPTION 3: SELECT 30MICROINCH GOLD AND SELECT MATTE TIN OVER NICKEL.
- PRODUCT SPECIFICATION : 2064600000-PS
- PRODUCT TEST SUMMARY: 2157590005-TS
- TRAY PACK : 2157600002-PK
- MATE WITH RECEPTACLE 215759
- THIS PART CONFORMS TO CLASS 'B' REQUIREMENTS OF COSMETIC SPECIFICATION PS-45499-002.

FUNCTIONAL SYMBOLS		THIS DRAWING CONTAINS INFORMATION THAT IS PROPRIETARY TO MOLEX ELECTRONIC TECHNOLOGIES, LLC AND SHOULD NOT BE USED WITHOUT WRITTEN PERMISSION		CURRENT REV DESC:			
DIMENSION UNITS		SCALE		EC NO: 691178			
mm		5:1		DRWN: ZIXUAQ 2022/01/06		MICRO-FIT PLUS RA HEADER ASSEMBLY	
GENERAL TOLERANCES (UNLESS SPECIFIED)				CHK'D: XQZHANG 2022/01/19			
ANGULAR TOL ± °				APPR: XQZHANG 2022/01/19		PRODUCT CUSTOMER DRAWING	
DIVISIONAL SYMBOLS				INITIAL REVISION:			
4 PLACES ±				DRWN: HPAN18 2020/10/15		DOCUMENT NUMBER	
3 PLACES ±				APPR: YXZHENG 2021/02/08		2157600003-SD	
2 PLACES ± 0.25						DOC TYPE DOC PART REVISION	
1 PLACE ± 0.36						PSD 000 A2	
0 PLACES ±						MATERIAL NUMBER CUSTOMER SHEET NUMBER	
DRAFT WHERE APPLICABLE MUST REMAIN WITHIN DIMENSIONS		THIRD ANGLE PROJECTION		DRAWING SERIES		SEE NOTES GENERAL MARKET 1 OF 1	