

ORDER NO.	WOODHEAD NO.	COLOR
130145-0067	2909	YELLOW

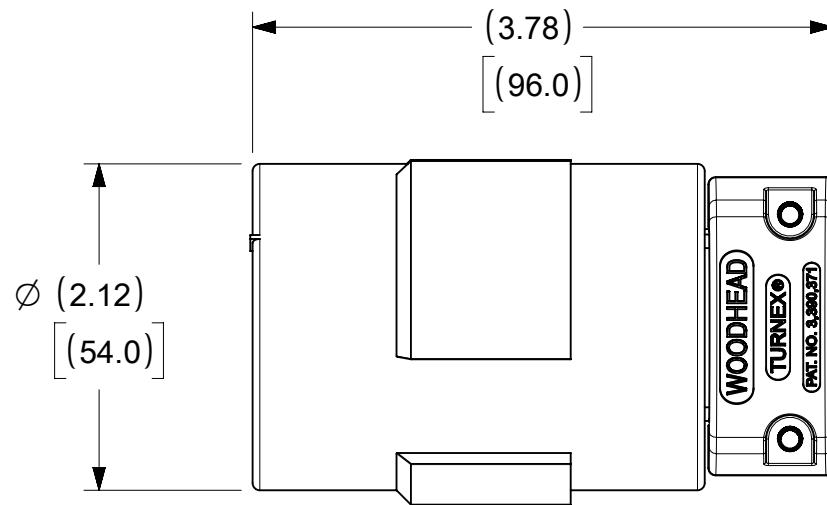

### WIRING TERMINATION

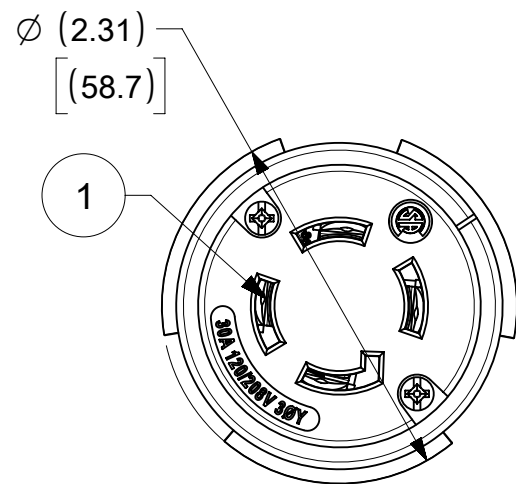
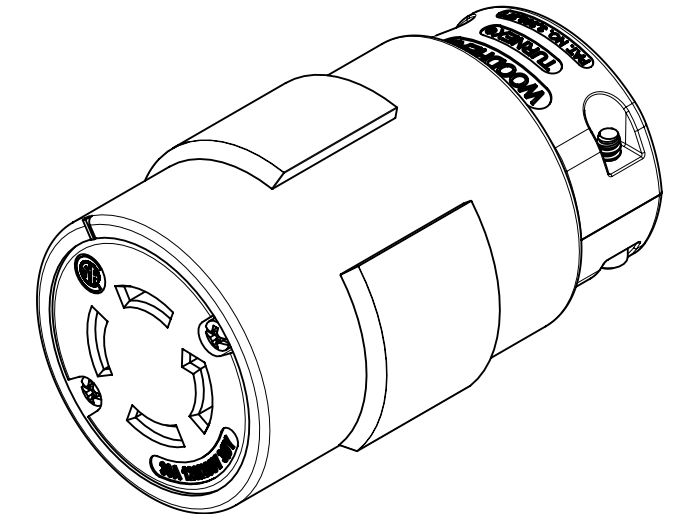
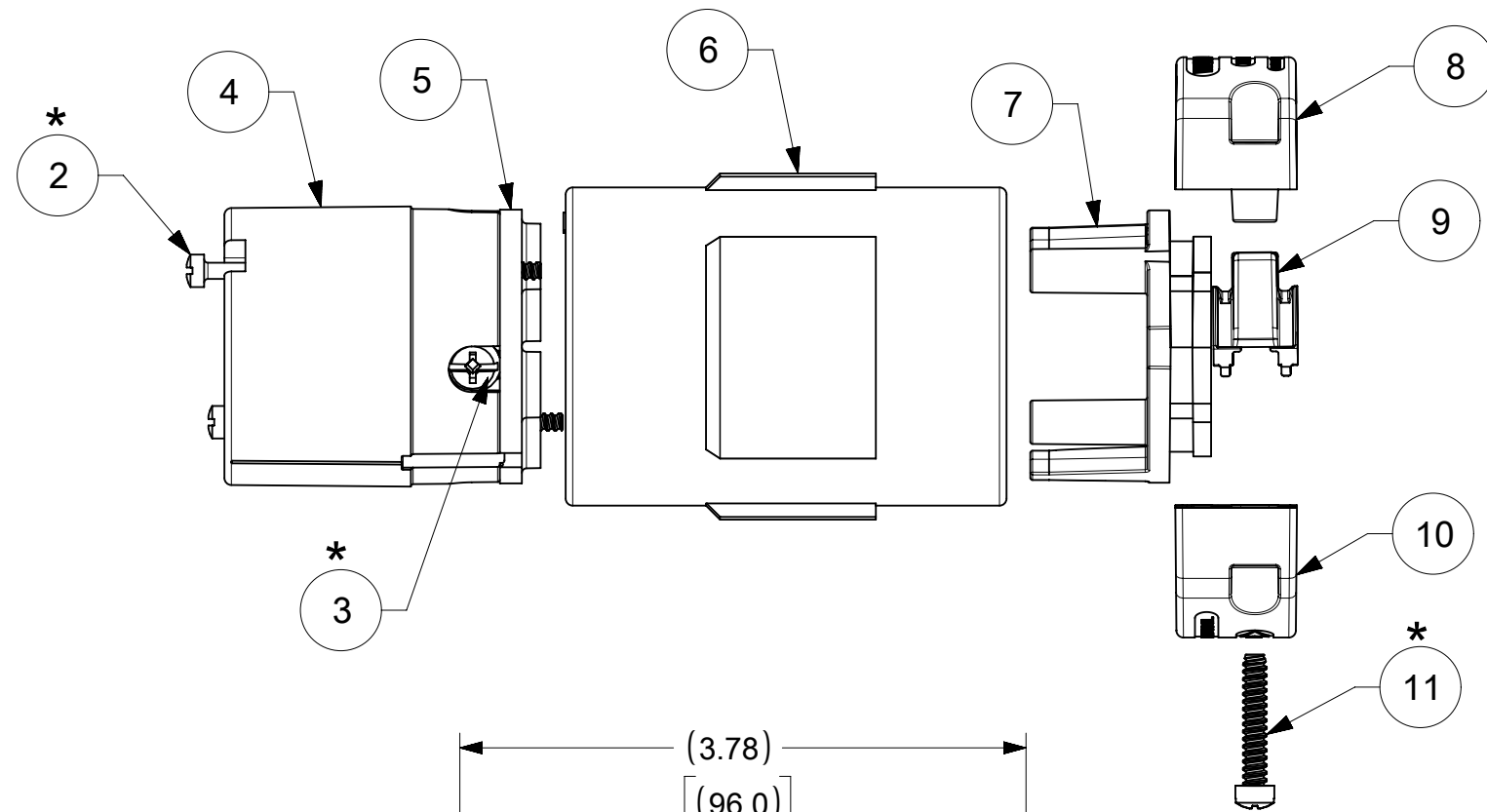
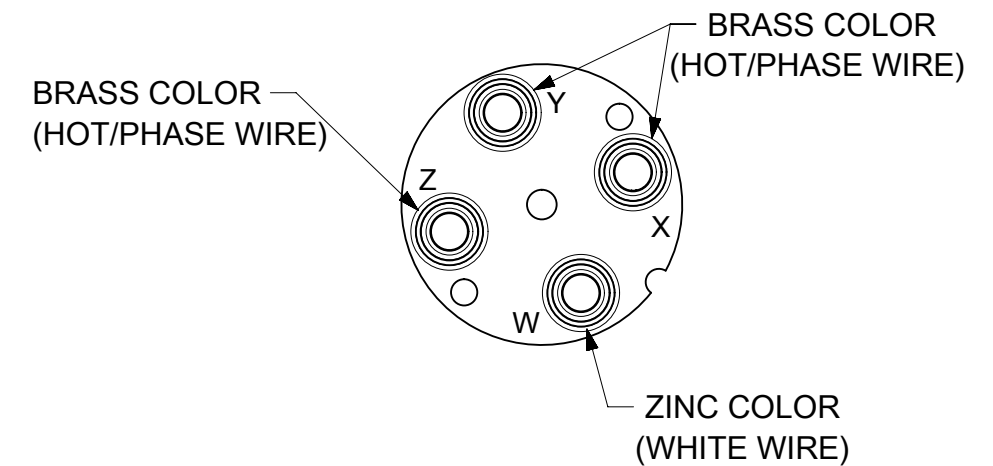

\* FOR SCREW TORQUE, SEE ASSEMBLY INSTRUCTIONS

ITEM NO.	DESCRIPTIONS	MATERIAL	QTY.
1	CLIP ASSEMBLY	BRASS, NICKEL PLATED	4
2	RETAINING SCREWS	STAINLESS STEEL	2
3	TERMINAL SCREWS/CLAMP ASSEMBLY	BRASS, ZINC PLATED	4
4	INSERT	NYLON	1
5	TERMINAL COVER	POLYCARBONATE	1
6	CONNECTOR HUSK	RUBBER	1
7	CLAMP SUPPORT	NYLON	1
8	CLAMP CORD MALE	NYLON	1
9	CLAMP CORD INSERT	NYLON	1
10	CLAMP CORD FEMALE	NYLON	1
11	RETAINING SCREWS	STAINLESS STEEL	2

SYMBOLS	THIS DRAWING CONTAINS INFORMATION THAT IS PROPRIETARY TO MOLEX ELECTRONIC TECHNOLOGIES, LLC AND SHOULD NOT BE USED WITHOUT WRITTEN PERMISSION		CURRENT REV DESC: NEW RELEASE		<b>molex</b>		
	DIMENSION UNITS	SCALE					
▽ = 0	INCH/MM	NTS	EC NO: 627957		SUPER-SAFEWAY CONN 2P3W NON-NEMA		
▽ = 0	GENERAL TOLERANCES (UNLESS SPECIFIED)		DRWN: VHANDI 2020/01/16				
▽ = 0			CHK'D: DNGUYEN62 2020/02/18		PRODUCT CUSTOMER DRAWING		
▽ = 0			APPR: HKNEELAND 2020/06/02				
▽ = 0			INITIAL REVISION:		DOCUMENT NUMBER		
▽ = 0			DRWN: VHANDI 2019/07/01				
▽ = 0			APPR: HKNEELAND 2020/06/02		PSD 000 A1		
▽ = 0			ANGULAR TOL ± °				
▽ = 0			DRAFT WHERE APPLICABLE MUST REMAIN WITHIN DIMENSIONS		CUSTOMER		
▽ = 0			THIRD ANGLE PROJECTION				
▽ = 0			DRAWING		GENERAL MARKET		
▽ = 0			SERIES				
▽ = 0			B-SIZE 130145				