

### 3 Pin 以上

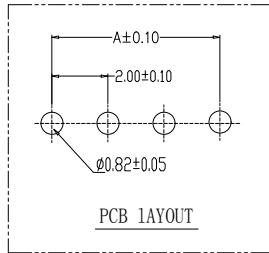

### 2 Pin

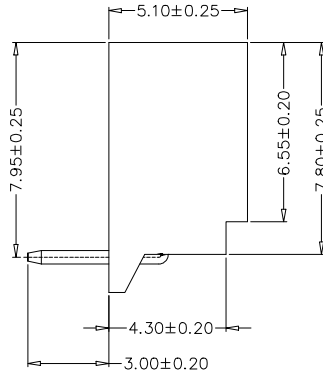
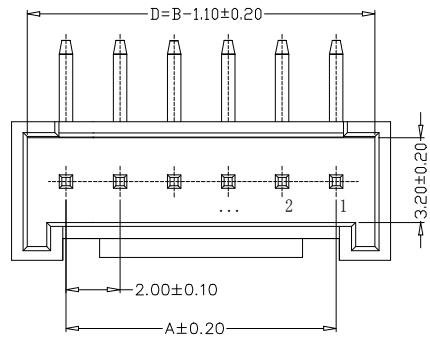
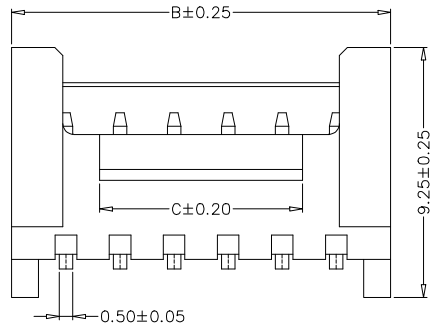
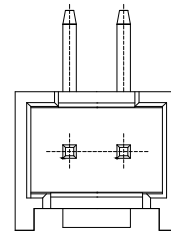
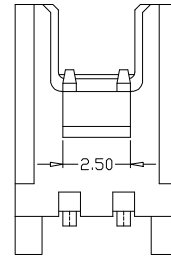

### SPECIFICATIONS

- 1、Current Rating: 2A AC, DC
- 2、Voltage Rating: 250V AC, DC
- 3、Temperatuer Range: -25°C ~ +85°C
- 4、Contact Resistance: 20mΩ Max
- 5、Insulation Resistance: 1000mΩ Min
- 6、Withstanding Voltang: 1000V AC/minute
- 7、Material: Wafer Nylon66 UL94-V0(2)  
PIN Brass Tin-plated

| Circuit | Part NO.   | Dimensions mm |       |       |
|---------|------------|---------------|-------|-------|
|         |            | A             | B     | C     |
| 2       | HC-HY-2AW  | 2.00          | 6.00  | 2.50  |
| 3       | HC-HY-3AW  | 4.00          | 8.00  | 2.50  |
| 4       | HC-HY-4AW  | 6.00          | 10.00 | 3.50  |
| 5       | HC-HY-5AW  | 8.00          | 12.00 | 5.50  |
| 6       | HC-HY-6AW  | 10.00         | 14.00 | 7.50  |
| 7       | HC-HY-7AW  | 12.00         | 16.00 | 9.50  |
| 8       | HC-HY-8AW  | 14.00         | 18.00 | 11.50 |
| 9       | HC-HY-9AW  | 16.00         | 20.00 | 13.50 |
| 10      | HC-HY-10AW | 18.00         | 22.00 | 15.50 |
| 11      | HC-HY-11AW | 20.00         | 24.00 | 17.50 |
| 12      | HC-HY-12AW | 22.00         | 26.00 | 19.50 |
| 13      | HC-HY-13AW | 24.00         | 28.00 | 21.50 |
| 14      | HC-HY-14AW | 26.00         | 30.00 | 23.50 |
| 15      | HC-HY-15AW | 28.00         | 32.00 | 25.50 |
| 16      | HC-HY-16AW | 30.00         | 34.00 | 27.50 |
| 17      | HC-HY-17AW | 32.00         | 36.00 | 29.50 |
| 18      | HC-HY-18AW | 34.00         | 38.00 | 31.50 |
| 19      | HC-HY-19AW | 36.00         | 40.00 | 33.50 |
| 20      | HC-HY-20AW | 38.00         | 42.00 | 35.50 |

### Ordering Information

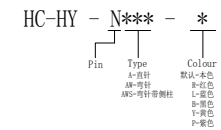

|           |                        |                   | GENERAL TOLERANCE | 制图<br>DRAWING    | 深圳市华灿天禄电子有限公司<br>ShenzhenhuacantianluELECTRONICS CO., LTD |               |             |     |
|-----------|------------------------|-------------------|-------------------|------------------|---|---------------|-------------|-----|
|           |                        |                   | DIM TOL           | 审核<br>CHECK      | 产品名称<br>TITLE   | HY (2.0) 单排弯针 | 版本<br>REV.  | A   |
|           |                        |                   | X.X ±0.30         | 批准<br>APPROVAL   | 产品料号<br>PART NO.  | HC-HY-NAW     | 单位<br>UNITS | mm  |
|           |                        |                   | X.XX ±0.20        | 比例<br>SCALE      | 材料<br>MATERIAL  |               | 页次<br>SHEET | 1/1 |
|           |                        |                   | X.XXX ±0.10       | 投影<br>Projection |   |               |             |     |
| 1         | 初版发行                   | 日期                | Angle ±3.0°       |                  |   |               |             |     |
| 序号<br>No. | 变更内容<br>MODIFY CONTENT | 日期<br>MODIFY DATE |                   |                  |   |               |             |     |