

GT-TC036B-H035-L1

G-Switch

Operating Force

A=180gf
B=250gf
D=350gf

Switch Height

H030=3.0mm
H035=3.5mm

Switch Lifetime (Force)

L1=100,000 Cycles
L3=300,000 Cycles

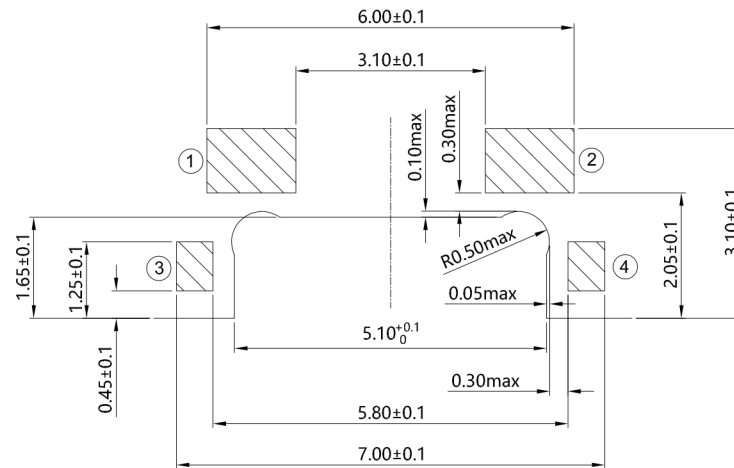
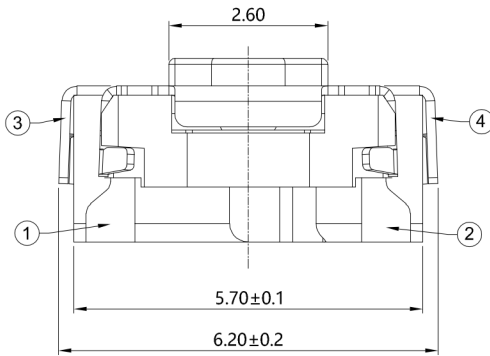

RECOMMENDED PCB LAYOUT
TOLERANCE:±0.05

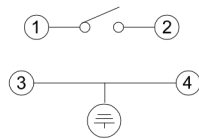

CIRCUIT DIAGRAM

G-Switch Specification:

1. Operating temperature range: -40°C ~ +85°C
2. Rating: 20mA, 15V DC
3. Insulation resistance: 100MΩ min, 100V DC
4. Dielectric strength: 250V AC for 1 min
5. Contact resistance: 100mΩ max.
6. Travel: 0.2±0.10mm

| | | | |
|-----|-----------|--------------------------|------------|
| 6 | COVER | SUS | |
| 5 | STEM | LCP-130i | WIHTE |
| 4 | GLUE | PI | |
| 3 | CONTACT | STAINLESS STEEL | Ag PLATING |
| 2 | TERMINAL | COPPER ALLOY | Ag PLATING |
| 1 | BASE | HIGH TEMPERATURE PLASTIC | BLACK |
| NO. | PART NAME | MATERIAL | REMARK |



SCALE: 1:1 UNIT: mm
SIZE: A4

Unless otherwise
General Tolerance:
X. ±0.25
X.x ±0.20
X.xx ±0.15
X° ±5°
X.x° ±3°

Title: Horizontal Tact Switch
SMT Mid-Mount 2.15 6.2×3.5×H3.5mm

Molde Code: GT-TC036B-H035-L1

| | | | |
|-------|---------|----------|------------|
| DRAWN | CHECKED | APPROVED | DATE |
| Xia | Chen | Chen | 2023.02.01 |



REV: A0 SHEET: 1/1