

1 2 3 4 5 6 7 8 9

G

F

E

D

C

B

A

SPECIFICATIONS

Current Rating: 1.5 Amps
 Insulation Resistance: 1000MΩ Min
 Contact Resistance: 20mΩ Max
 Withstanding Voltage: AC 500V
 Operation Temperature: -40° to +105°
 Contact Material: Brass
 Standard: PA6T
 Insulator Material: Polyester
 Contact Plating: Gold Flash
 Max. Processing Temp: 240° C for 30-60seconds
 (260° C for 5 seconds)

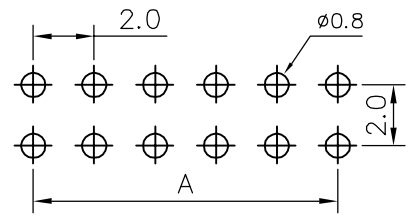
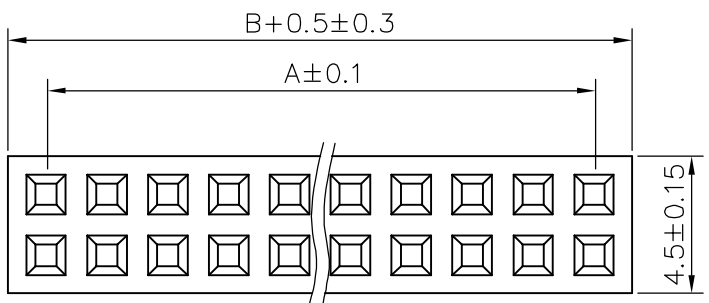

RECOMMEND P. C. B LAYOUT
 PCB TOLERANCE: ± 0.05 (TOP VIEW)

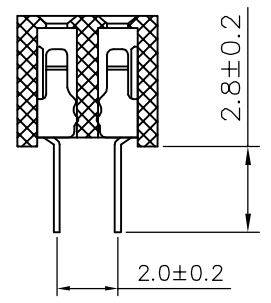
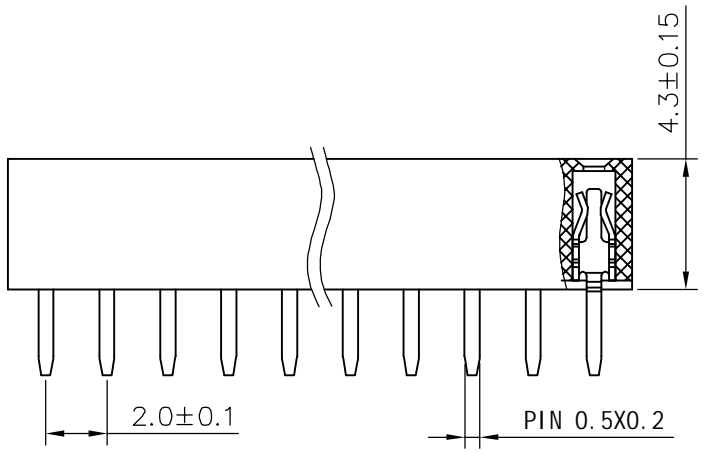

深圳市虹成电子有限公司

| No. of | DIM. A | DIM. B | No. of | DIM. A | DIM. B | No. of | DIM. A | DIM. B | No. of | DIM. A | DIM. B |
|--------|--------|--------|--------|--------|--------|--------|--------|--------|--------|--------|--------|
| 1 | 0.00 | 2.00 | 11 | 20.00 | 22.00 | 21 | 40.00 | 42.00 | 31 | 60.00 | 62.00 |
| 2 | 2.00 | 4.00 | 12 | 22.00 | 24.00 | 22 | 42.00 | 44.00 | 32 | 62.00 | 64.00 |
| 3 | 4.00 | 6.00 | 13 | 24.00 | 26.00 | 23 | 44.00 | 46.00 | 33 | 64.00 | 66.00 |
| 4 | 6.00 | 8.00 | 14 | 26.00 | 28.00 | 24 | 46.00 | 48.00 | 34 | 66.00 | 68.00 |
| 5 | 8.00 | 10.00 | 15 | 28.00 | 30.00 | 25 | 48.00 | 50.00 | 35 | 68.00 | 70.00 |
| 6 | 10.00 | 12.00 | 16 | 30.00 | 32.00 | 26 | 50.00 | 52.00 | 36 | 70.00 | 72.00 |
| 7 | 12.00 | 14.00 | 17 | 32.00 | 34.00 | 27 | 52.00 | 54.00 | 37 | 72.00 | 74.00 |
| 8 | 14.00 | 16.00 | 18 | 34.00 | 36.00 | 28 | 54.00 | 56.00 | 38 | 74.00 | 76.00 |
| 9 | 16.00 | 18.00 | 19 | 36.00 | 38.00 | 29 | 56.00 | 58.00 | 39 | 76.00 | 78.00 |
| 10 | 18.00 | 20.00 | 20 | 38.00 | 40.00 | 30 | 58.00 | 60.00 | 40 | 78.00 | 80.00 |

UNLESS OTHERWISE SPECIFIED TOLERANCE
 X : ± 0.3 X° : $\pm 5^\circ$
 X.X : ± 0.2 X.X° : $\pm 1^\circ$
 X.XX : ± 0.1 X.XX° : $\pm 0.5^\circ$

DRAWING NAME: 2.0FH 2xPi n H4.3 DIP

| | | | | | |
|----------|------------|----------|----------|-------------|----------------------|
| SIZE | A4 | SCALE | N:1 | PROJECT NO. | HC-PM200-4.3H-2x15PZ |
| REV | A | UNIT | mm | PROJECT | |
| CHECKED: | LI BEI LIN | 12/03/07 | CHECKED: | / / | APPROVED: |

1 2 3 4 5 6 7 8 9