

电气功能 Function		
ON	NA	ON
	/	

MODEL CODE

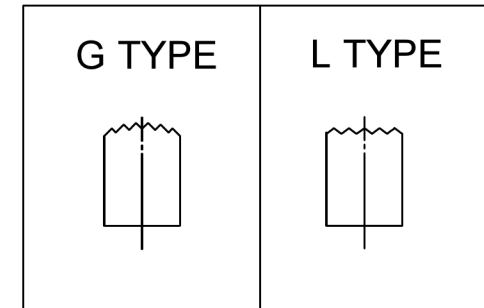
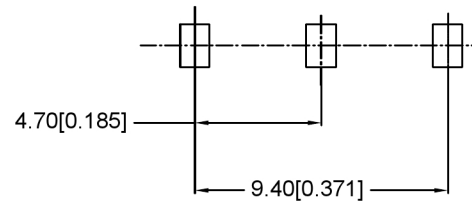
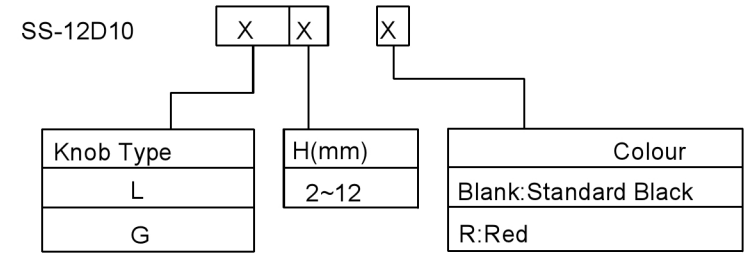

规格 Specification:

1. 额定值 Rating: 1A 250VAC
2. 电气功能 Function: ON-ON
3. 接触电阻 Contact resistance: <30 mΩ
4. 绝缘电阻 Insulation resistance: ≥100 MΩ(DC500V/Min)
5. 电气寿命 Electronics life: >10000 cycles
6. 操作力 Operation force: 250±100gf
7. 所有材料符合Rohs要求 All materials are Rohs compliant

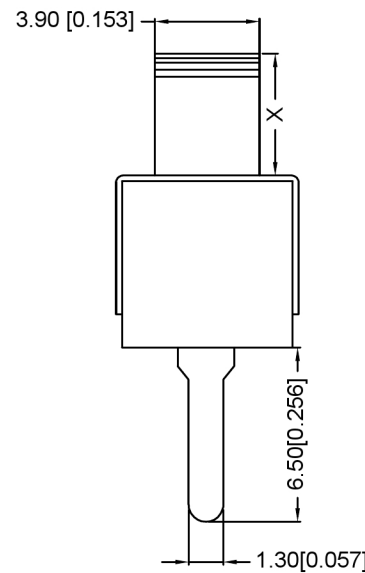
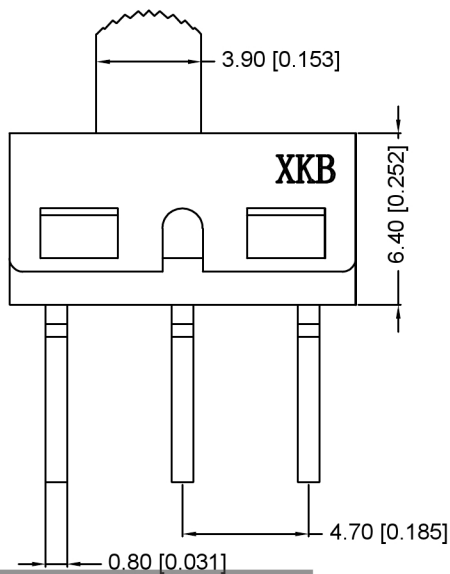

P.C.B LAYOUT
BOTTOM VIEW

ITEM	PAPT NAME	TER,NO	QTY	MATERIAL	FINISHING	REMARK
⑤	Terminal	—	3	Copper Alloy	silver plated	—
④	Contact	—	1	Copper Alloy	silver plated	—
③	Housing	—	1	Stainless Steel		—
②	Slide Handle	—	1	Nylon		—
①	Case	—	1	Diallyl Phthalate (DAP)		—

广东星坤科技股份有限公司

Δx	日期
Δx	日期
Δx	日期
MARK	DESCRIPTION

文件工程章

REVISIONS	DATE	REVISED	APPROVED	UNSPECIFIED TOLERANCES
ANGLAR				±5°
L ≤ 4				±0.2
4 < L ≤ 16				±0.3
16 < L ≤ 63				±0.4
L > 63				±0.5



DSND	SCALE: N/A	MODEL TYPE: SLIDE SWITCH
DWN	VIEW:	PART NO.: SS-12D10XXX
CHKD	UNIT: mm/in	DWG NO.:
APPD	SIZE: A4	
XKB INDUSTRIAL PRECISION CO., LIMITED		WEIGHT
		SHEET
		REVISIC
		1/1
		A0