

- 主要技术规格:**
1. 额定值: 50mA DC12V
  2. 接触电阻: 100mΩ
  3. 操作力: 250±50gf
  4. 行程: 0.12±0.1mm
  5. 绝缘电阻: 100MΩ
  6. 抗电强度: 250V 50HZ 1Min.
  7. 寿命: 7万次

**材料:**  
 本体:LCP (原色)  
 按钮:PPA (白色)  
 卡件:磷铜 (镀银)  
 弹片:不锈钢 (镀银)  
 盖板:磷铜 (镀铜锡)

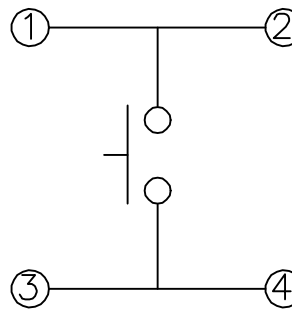

PAPT NO	TS1145-X-X
Operating Force	160 : 160gf ; 260 : 260gf
Height	25 : 2.5mm

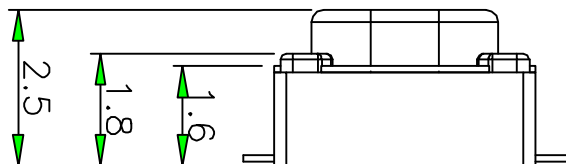
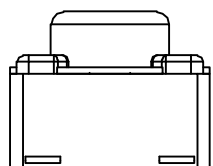

		new		2015/5/3	A	瀚源
ECN BO.		DESCRIPTION.		DATE.	REV.	
DESIGNED	CHECKED	APPROVAL	DRAWING NUMBER	SCALT: 1/2		SCALE: 3:1
Mikey	Tom	Jerry	PART NAME	TS1145-X-X	UNLESS OTHERWISE SPECIFIED,TOLERANCE:	X. ±0.25
			MODEL NAME	TS1145-X-X		X.x ±0.20
			3RD ANGLE PROJ	HanElectricity Co.,LTD		X.xx ±0.15
					ANGULAIR	±3
					FILE.NO.	