

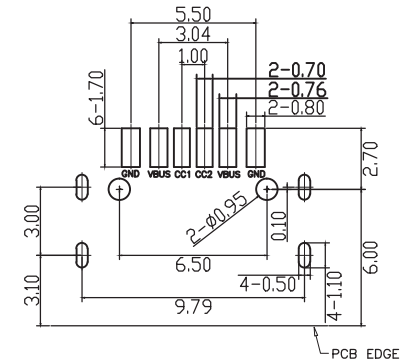

RoHS Compliant

Kinghelm®

REV.	ZONE	DESCRIPTION	DESIGN	DATE
B		NEW		

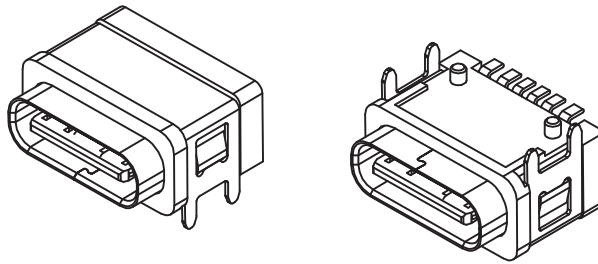
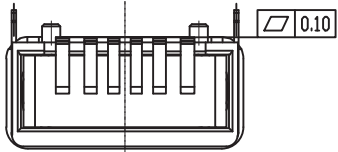

NOTES:

SPECIFICATION:

- CURRENT RATING: 3.0A MAX
- VOLTAGE: 100 VAC
- TEMPERATURE RANGE: -30°C~+85°C
- CONTACT RESISTANCE: 40 MILLION HM MAX
- INSULATION RESISTANCE: 100 MEG OHMS MIN
- INSERTION FORCE: 5N~20N
- UNMATING FORCE: 8N~20N
- DURABILITY: 10000 CYCLES
- WATER PROOFNESS: THIS PRODUCT IS BASED ON IPX7.

USB TYPE-C PIN ASSIGNMENTS

A5	CC1	B12	GND
A9	VBUS	B9	VBUS
A12	GND	B5	CC2
PIN	SIGNAL NAME	PIN	SIGNAL NAME

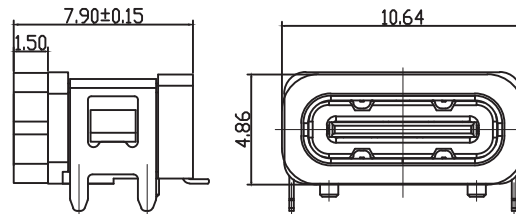
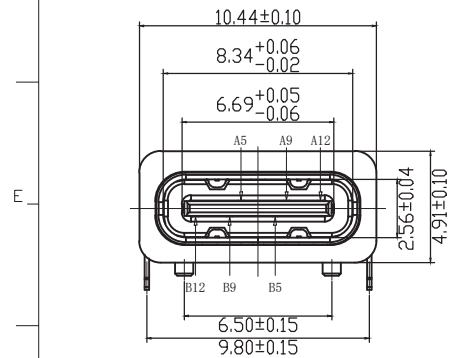
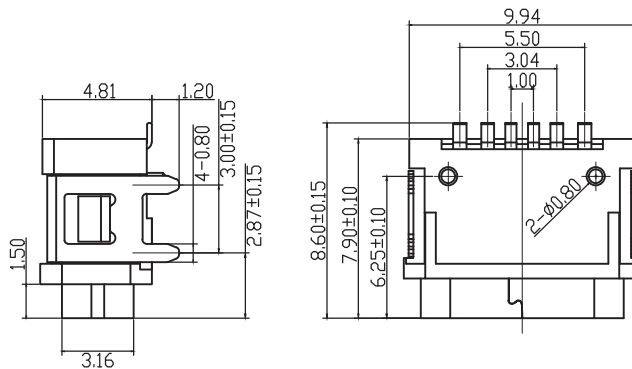
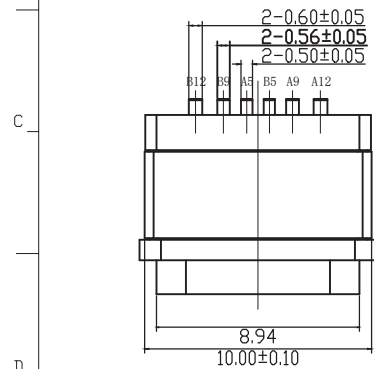

加防水圈示意图

TABLE:

NO	PART	Q'TY	Material
1	SHELL	1	STAINLESS STEEL,NI PLATED
2	CONTACT	6	COPPER STEEL,TIN/Au/NI PLATED
3	MID PLATE	1	STAINLESS STEEL,NO PLATING
4	1MD HOUSING	1	HIGH TEMPERATURE RESISTANT PLASTIC BLACK UL94 V-0
5	2MD HOUSING	1	HIGH TEMPERATURE RESISTANT PLASTIC BLACK UL94 V-0
6	SHIELDING PLATE	1	STAINLESS STEEL,NI PLATED

X. ± 0.50	X.* ± 2*	UNITS	深圳市金航标电子有限公司	www.kinghelm.com.cn
.X ± 0.30	.X* ± 1*	mm	KH-TYPE-C-W.FS-6P-STM	0755-28190160
.XX ± 0.10	.XX* ± 0.5*	MAT'L	TITLE:	
.XXX ± 0.05			TYPE-C 6PIN板上四脚插板SMT防水母座 后柱 IPX7级	
		FINISH	APPD:	DWG NO:
			CHKD:	1020002
		Q'TY	DR:	SCALE SHEET REV.
				1/1 1/1 A1



Kinghelm®

REV.	ZONE	DESCRIPTION	DESIGN	DATE
B		NEW		

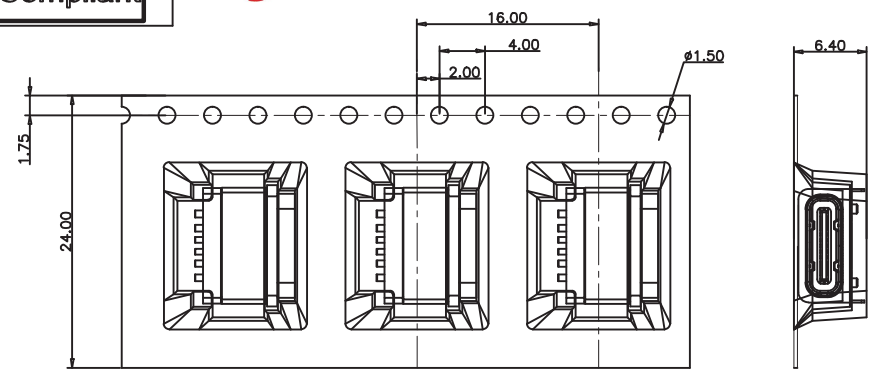

① 产品入载带示意图

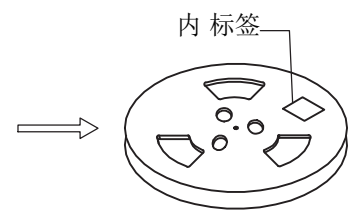

② 卷盘贴标签示意图

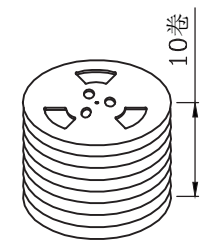

③ 12盘产品叠层示意图

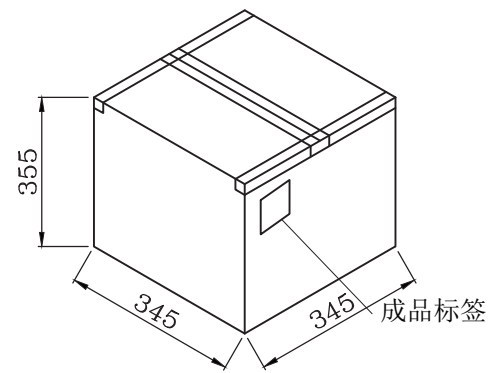

⑤ 外箱封箱示意图

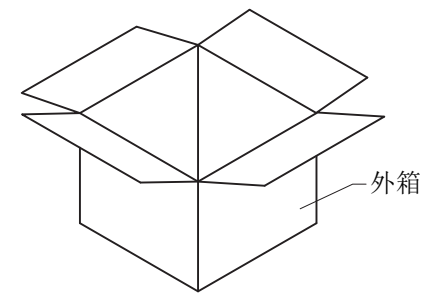

④ 产品入外箱示意图

包装说明:

1. 将检验好的成品;对插口朝前放入载带;每卷装700PCS产品;具体如图一所示
2. 将包装好的产品;每盘必需贴上内标签;具体如图二所示
3. 将贴好内标签的产品每12盘叠;具体如图三所示
5. 装好后并封好纸箱及贴好相关标签;具体如图五所示;
(产品包装的标签,如客户有要求,请按客户要求包装出货)
6. 载带前面留16PCS空格,后面留16PCS空格
7. COVER与CARRY剥离力:50-125g,速度:300mm/分钟左右,剥离角度:165°-180°

	REEL	CARTON
CONNECTOR (PCS)	700	8400

X. ±0.50	X.° ± 2°	UNITS mm	深圳市金航标电子有限公司	www.kinghelm.com.cn
.X ±0.30	.X° ± 1°		KH-TYPE-C-W.FS-6P-STM	0755-28190160
.XX ±0.10	.XX° ± 0.5°	MAT'L	TITLE:	
.XXX ±0.05			TYPE-C 6PIN板上四脚插板SMT防水母座 后柱 IPX7级	
		FINISH	APPD:	DWG NO:
		Q'TY	CHKD:	1020002
			DR:	SCALE SHEET REV.
				1/1 1/1 A1