

NOTES :

- 1.Circuit : ON/OFF
- 2.Rating : 16A 125/250VAC 3/4HP 125/250VAC(CUL)
16(4)A 125/250V~ T125/55 5E4 (ENEC17;NEMKO;CB)
16(4)A 250~ T125/55 1E4 (CQC)
- 3.Contact resistance : <50mΩ
- 4.Insulation resistance : >100MΩ(500VDC between open contacts)
- 5.Dielectric strength : >1500Vac 0.5mA 1 mintute
- 6.SILVER CONTACT : $\varnothing 2.6$ AgSnO₂In₂O₃(t=0.3mm)/Cu

TEL: 0769-82310511-867

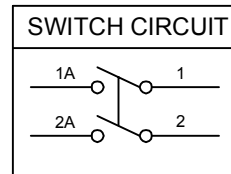
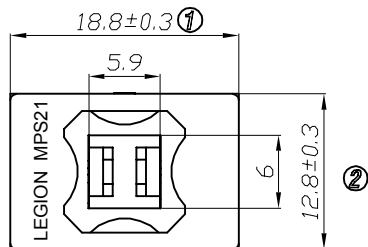

WHEN THE SWITCH IS ON THE "ON" STATE,
DIMENSION A IS 3.0 mm, AND THE "OFF"
STATE, DIMENSION A IS 6.0 mm

PANEL CUTOUT DIMENSION:

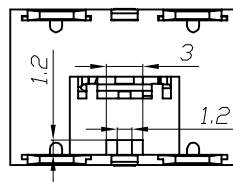
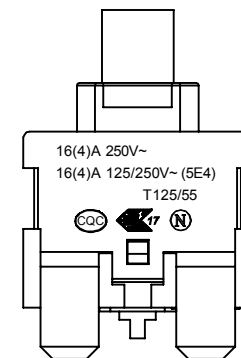
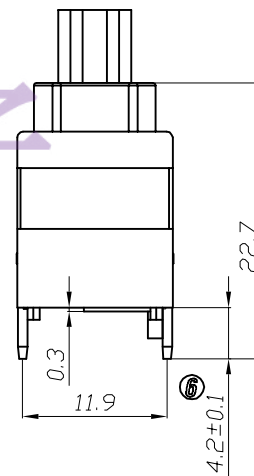
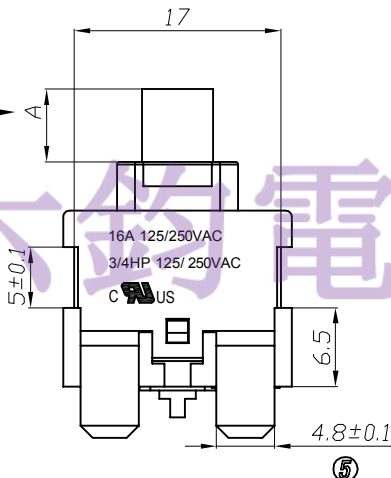
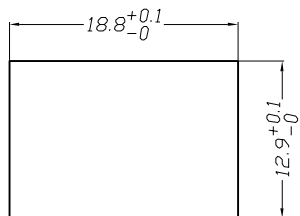

⑤	→	⑩	→	DIMENSIONAL TOLERANCES		APPROVED	CHECKED	DESIGN	DRAWN	ALL SIZE ARE IN	MM		
④	→	⑨	→	RANGE	TOLERANCE				LMC	SCALE	NO		
③	→	⑧	→	X	±0.30				2019.05.20	MAT'L	***		
②	→	⑦	→	X.X	±0.20					MATERIAL NO.		DRAWING NO.	REV.
①	→	⑥	→	X.XX	±0.10							WIF120114	AO
NO	DESCRIPTION	NO	DESCRIPTION	ANGLES	±1'	LEGION ELECTRONIC & HARDWARE CO., LTD.				MPS21-WWBCE-R			