

1. 跷板开关型号 ROCKER SWITCH MODEL NO.SS21-BBAWG-R
2. 快插端子 QUICK CONNECTOR TYPE
3. 额定值 RATING:10A 125/250VAC(C-U/L)
12(4)A 250V~T85/55(ENEC17;NEMKO;CQC)
- CUL APPROVAL FILE NO.E1533399
- ENEC17 CERTIFICATE NO.3704
- NEMKO CERTIFICATE NO.P15219978
- CQC CERTIFICATE NO.CQC10002046596
- CB CERTIFICATE NO.87398
- KC CERTIFICATE NO.SU02099-17001

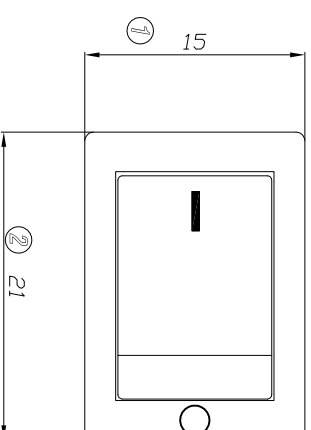

4. 柄的颜色 ACTUATOR COLOR:BLACK
5. 基座的颜色 HOUSING COLOR: BLACK
6. 柄的印字形式 ACTUATOR PRINTING:" I "白色 WHITE COLOR
7. 所有部件均使用环保材料
- ALL MATERIALS USING MEET THE ROHS DIRECTIVE
8. 操作力 OPERATION FORCE:800±200gf

PANEL CUTOUT DIMENSION

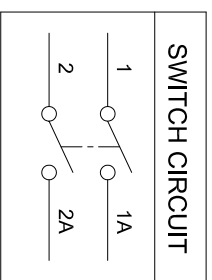
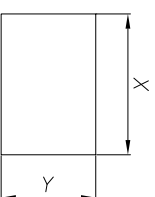

PANEL THICKNESS	X	Y
0.75~1.25mm	19.2 ⁺⁰ _{-0.1} mm	12.9 ^{+0.1} ₋₀ mm
1.25~2.0mm	19.4 ⁺⁰ _{-0.1} mm	12.9 ^{+0.1} ₋₀ mm
2.0~3.0mm	19.8 ⁺⁰ _{-0.1} mm	12.9 ^{+0.1} ₋₀ mm

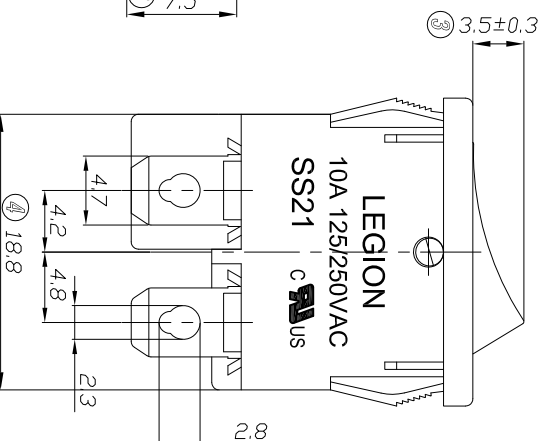
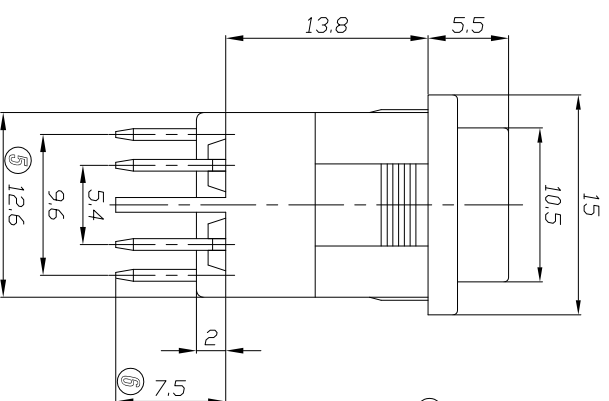
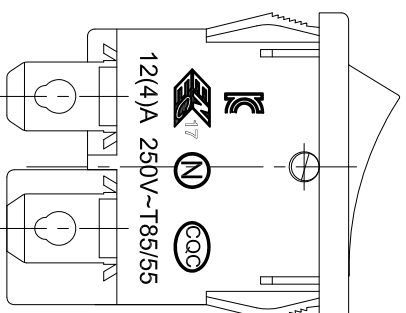

修正 REVISION	說明 DESCRIPTION	修訂者 REVISED BY	SPECIFICATION				公差 TOLERANCES		TOLERANCES UNLESS OTHERWISE SPEC.±0.3/0.05,ANG.±2°			
			製圖 DRAWN BY	設計 DESIGNED BY	校對 CHECKED BY	核准 APPROVED BY	單位 UNIT	mm	機種名稱 MODEL NAME	ROCKER SW	機種編號 MODEL NO.	SS21-BBAWG-R
			管林华 22-Aug-2018	刘美昌 22-Aug-2018	刘美昌 22-Aug-2018	刘美昌 22-Aug-2018	比例 SCALE	1/1	六鈞電子五金有限公司 LEGION ELECTRONIC & HARDWARE CO., LTD.			
							日期 DATE	2018.8.22				