

P	LTR	DESCRIPTION	DATE	DWN	APVD
02		REVISED PER ECO-09-027788	05JAN2010	SS	CR
A		PART STATUS UPDATED	07JUL2021	SB	SS
A1		NEW PART 1-1776134-6 IS ADDED	22SEP2023	SP	PS

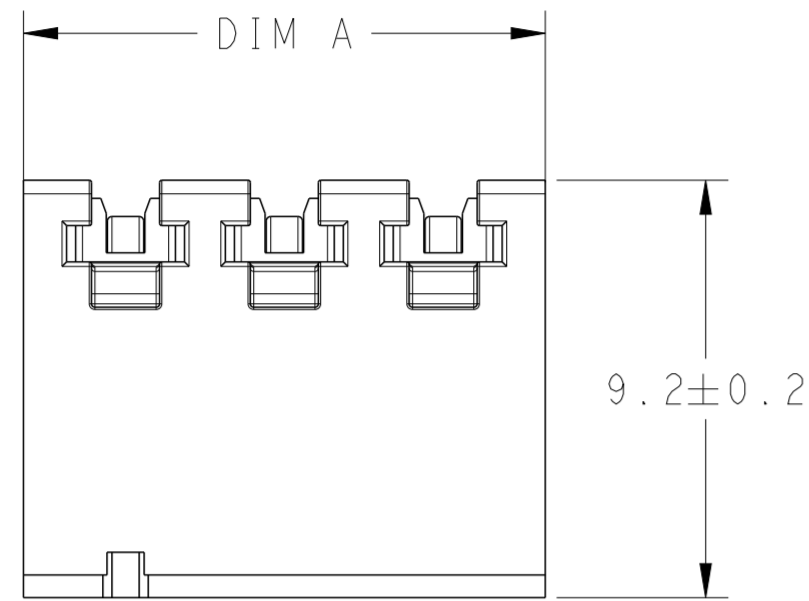

NOTES :

1. MATERIAL AND FINISH :
 HOUSING : HIGH TEMPERATURE POLYAMIDE UL94 V0
 HOUSING COLOR : BLACK
 TERMINAL : COPPER ALLOY ,TIN PLATED OVER NICKEL UNDERPLATED.
2. ELECTRICAL PROPERTIES:
 RATED VOLTAGE: 300V
 RATED CURRENT: 11A
 CONTACT RESISTANCE : <15 m Ohm
 INSULATION RESISTANCE : >1000 M Ohm (500V DC)
3. NOT CUMULATIVE TOLERANCE
4. MECHANICAL PROPERTIES:
 RECOMENDED PCB THICKNESS : 1.6mm-2.4mm
 WIRE STRIPPING LENGTH : 6mm
5. OPERATING TEMPERATURE RANGE : -40°C TO +105°C.
6. OBSOLETE
7. PACKAGING: BULK PACKING AS PER 107-160052
8. PACKAGING: T & R PACKING AS PER 107-160194

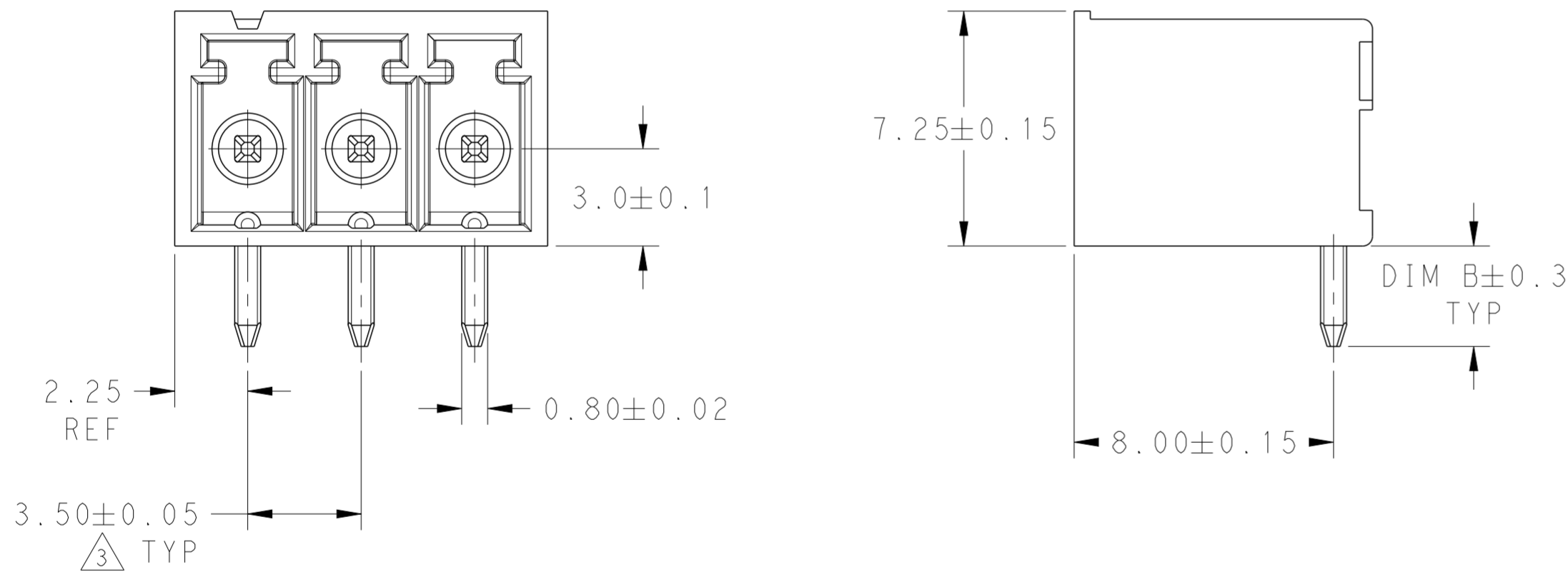

6	TAPE & REEL	3.4	22.0	6	1-1776134-6
6	TAPE & REEL	2.6	18.5	5	1-1776134-5
6	TAPE & REEL	2.6	11.5	3	1-1776134-3
	BULK	3.4	43.0	12	1-1776134-2
	BULK	3.4	39.5	11	1-1776134-1
	BULK	3.4	36.0	10	1-1776134-0
	BULK	3.4	32.5	9	1776134-9
	BULK	3.4	29.0	8	1776134-8
	BULK	3.4	25.5	7	1776134-7
	BULK	3.4	22.0	6	1776134-6
	BULK	3.4	18.5	5	1776134-5
6	BULK	3.4	15.0	4	1776134-4
	BULK	3.4	11.5	3	1776134-3
	BULK	3.4	8.0	2	1776134-2
	PACKAGING	DIM B	DIM A	NO. OF POS.	PART NUMBER

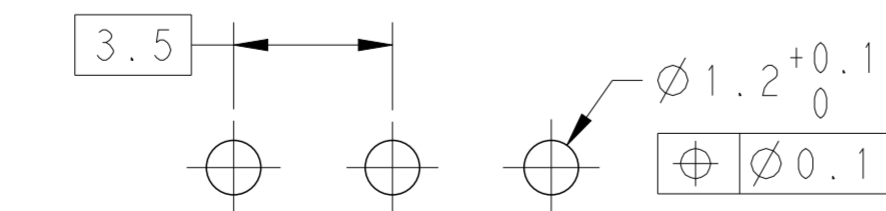

RECOMMENDED PC BOARD LAYOUT

THIS DRAWING IS A CONTROLLED DOCUMENT.		DWN S. SCHLEGEL 05JAN2010	TE Connectivity	
DIMENSIONS: mm		CHK C. RICHARD 05JAN2010		
TOLERANCES UNLESS OTHERWISE SPECIFIED:		APVD C. RICHARD 05JAN2010	NAME TERMINAL BLOCK HEADER, 90 DEGREE, CLOSED ENDS, 3.5mm PITCH	
0 PLC ± 1 PLC ±0.3 2 PLC ±0.25 3 PLC ± 4 PLC ±		PRODUCT SPEC 108-161088	RESTRICTED TO	
ANGLES ±2°		APPLICATION SPEC 114-20079	SIZE A2	CAGE CODE 00779
MATERIAL		FINISH	DRAWING NO C-1776134	SCALE 6:1
1		1	SHEET 1 OF 1	REV A1
CUSTOMER DRAWING				