

## SQ Series

- Counter-plan product for safety
- Load life 5,000 hours at 105°C



### SPECIFICATIONS

Item	Performance Characteristics			
Category Temperature Range	-25 ~ +105°C			
Working Voltage Range	160 ~ 450Vdc			
Capacitance Range	22 ~ 680 μF			
Capacitance Tolerance	±20% (at 25°C and 120Hz)			
Dissipation Factor (tanδ) (at 25°C, 120Hz)	Rated Voltage (V)	160 ~ 250	400 ~ 450	
	tanδ(Max)	0.12	0.15	
Leakage Current	I=0.02CV or 3000 μA whichever is smaller I : Leakage current (μA) C : Rated capacitance (μF) V : Rated voltage (V) . Impress the rated voltage for 2 minutes			
Low Temperature Characteristics Impedance Ratio(MAX)	Rated voltage (V)	160~250	400	420 ~ 450
	Z(-25°C)/Z(+20°C)	3	5	6
Endurance	The following specifications shall be satisfied when the capacitors are restored to 25°C after subjected to DC voltage with the rated ripple current is applied for 5,000 hours at 105°C.			
	Capacitance change	≅ ±20% of the initial value		
	Dissipation factor(tanδ)	≅ 200% of the specified value		
	Leakage current	≅ specified value		
Shelf Life	The following requirements shall be satisfied when the capacitor are restored to 25°C after the rated voltage applied for 1,000 hours at 105°C without voltage applied.			
	Capacitance change	≅ ±20% of the initial value		
	Dissipation factor(tanδ)	≅ 200% of the specified value		
	Leakage current	≅ 200% of the specified value		
Others	Conforms to JIS-C-5101-4 (1998), characteristic W			

### DIMENSIONS (mm)

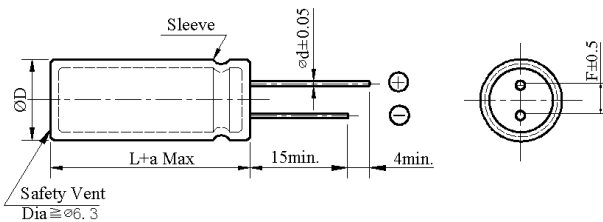

ΦD	10	12.5	16	18
ΦD	ΦD + 0.5 Max			
Φd	0.6	0.6	0.8	0.8
F	5.0	5.0	7.5	7.5
a	L + 1.5 Max	≤ 35 L+1.5Max ≥ 40 L+2.0 Max	L + 1.5 Max	

### PART NUMBER SYSTEM (Example : 450V 47μF)

S	Q	2	W	4	7	0	M	N	N	1	2	4	5						
---	---	---	---	---	---	---	---	---	---	---	---	---	---	--	--	--	--	--	--

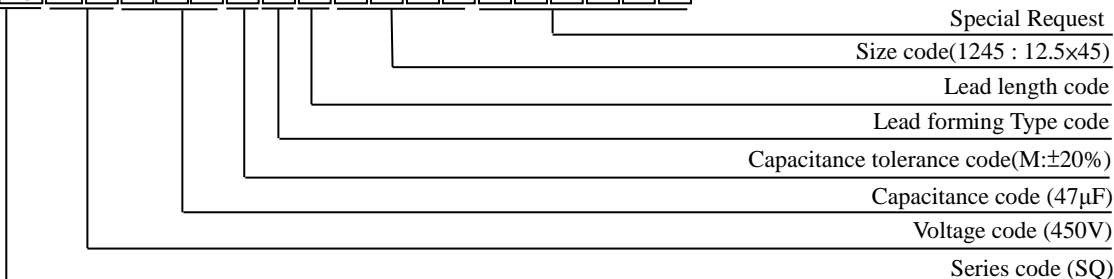

## Aluminum Electrolytic Capacitor

<b>Customer</b>	<b>Digi-Key</b>	<b>SERIES</b>	<b>SQ</b>	<b>NO.:</b>	<b>PUBLISH DATE</b>	<b>2022-03-25</b>
-----------------	-----------------	---------------	-----------	-------------	---------------------	-------------------

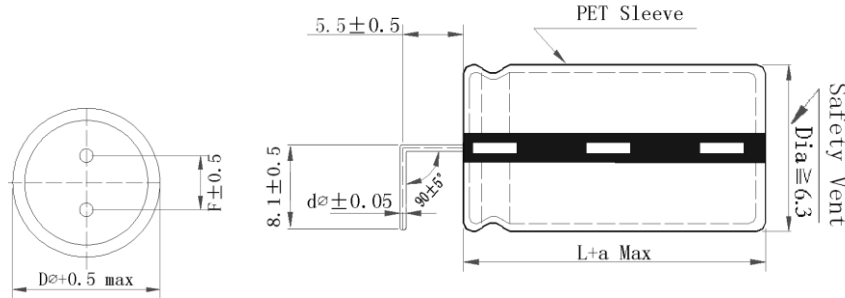

**FIG-1**

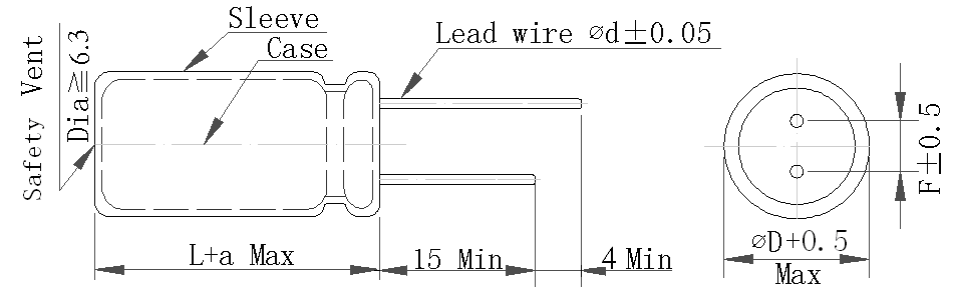

**FIG-2**

No.	CHINSAN Part No.	Customer Part No.	Capacitance (uF)	Tolerance On rated Capacitance (%)	Working Voltage (Vdc)	Surge Voltage (Vdc)	Category Temp Range (°C)	Tanδ @ 25°C (120Hz) (Max)	Leakage Current (uA) (2 min.)	Rated Ripple Current (mA rms) @ 105°C 120Hz	Rated Ripple Current (mA rms) @ 105°C 100kHz	ESR @25°C (mΩ max/ 120Hz)	Impedance @20°C (mΩ max/ 100kHz)	Endurance @ 105°C (Hours)	Dimensions (mm)					Appearance Drawing No
															D Φ	L	a	d	F	
1	SQ2E151MU01635	/	150 μF	±20%	250 V	/	-25~+105	/	/	900	/	/	/	5000	16	35	/	/	7.5	FIG-1
2	SQ2W101MNN1840	/	100 μF	±20%	450 V	/	-25~+105	/	/	750	/	/	/	5000	18	40	/	/	7.5	FIG-2

※Test leakage current before testing dissipation factor and capacitance during the electric characteristic test.

<b>REMARKS:</b>	<b>APPROVED BY</b>	<b>CHECKED BY</b>	<b>PREPARED BY</b>
Sleeve Color: Black. S specified product.	张洪斌	曾爱娥	梁慧妍