

H3-TC1-1T-152X+ 5-1500MHz 50Ω 1:1 Balun

• APPLICATIONS

• Ideally suited for VHF/UHF, cellular, GPS and communication.

• FEATURES

- Surface mount
- Impedance ratio: 1:1
- Available on tape and reel
- RoHS compliant and Pb free
- 260°C reflow compatible
- CT on Secondary

DIMENSIONS

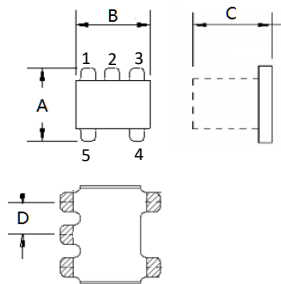

A	B	C
3.81	3.81	2.90
D		
1.27		

Land Pattern

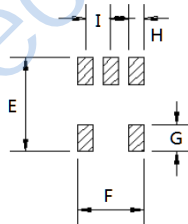

E	F	G
4.83	3.30	1.40
H	J	
0.76	1.27	

Unless otherwise stated dimensions are in mm

Tolerance: .xx ± 0.25, .xxx ± 0.05

ELECTRICAL SPECIFICATIONS@25°C:

Parameters (P#: ENA PORT)	frequency band	Min.	Typ.	Max.	Unit
Port Impedance, Z0			50		Ohm
Insertion Loss	5-870MHz		0.8	1.6	dB
	870-1000MHz		1.4	1.7	dB
	1000-1500MHz		1.7	2.5	dB
Return Loss	5-870MHz	12.0	15.0		dB
	870-1000MHz	10.0	13.0		dB
Amplitude Balance	5-870MHz		0.1	0.7	dB
	870-1000MHz		0.2	0.9	dB
	1000-1500MHz		0.5	1.8	dB
Phase Balance	5-870MHz		2.0	6.0	Deg
	870-1000MHz		2.0	8.0	Deg
	1000-1500MHz		2.0	10	Deg
Common mode rejection	5-1000MHz	22.0	33.0		dB
	1000-1500MHz	20.0	29.0		dB

FUNCTIONAL SCHEMATIC

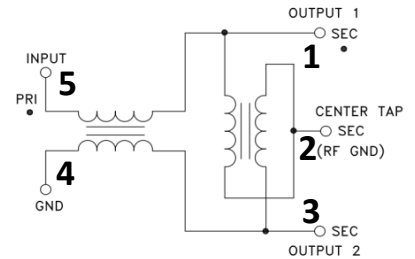

PIN CONFIGURATION

Pin No.	Function
1	Secondary Dot
2	Secondary CT
3	Secondary
4	Primary
5	Primary Dot

ABSOLUTE MAXIMUM RATINGS

Parameter	Value
RF Power	0.5W MAX
DC Current	200mA MAX
Operating Temperature Range	-45 to 85°C
Storage Temperature	-55 to 100°C

## TEST CURVE

