

TECHNICAL SPECIFICATIONS
 Material: Zinc
 Plating: Nickel
 Operating Temperature: -25°C to +90°C
 Thumbscrews: UNC 4-40
 No. of contacts: 09-15-25-37

Item	QTY	Part description
1	1	Upper Cover
2	1	Lower Cover
3	3	CSK M2.5x11.5 Screw
4	1	Grommet Set
5	1	Jackscrew UNC4-40x28.5
6	1	Jackscrew UNC4-40x19.5

RoHS compliant
 Unit: mm

Scale	Free				Date	Name	Customer-No.
TOLERANCE					Drawn	17.08.2017	S.Bölling
0~6	±0.10				Approved	17.08.2017	S.Bölling
6~30	±0.20						
30~120	±0.30						
120~400	±0.50	①	add assembly instruction	08.04.2020	S.Bölling		
DIM	Tol	②	Drawn	17.08.2017	S.Bölling		
Angle	±1°						
Angle	Tol	Id.	Modification	Date	Name		

Grommet Set



ASSMANN WSW-No. ACOV-SUB-09MB39	
Drawing-No. ASS_5280_CO	rev01
Replace	Sheet 1/5

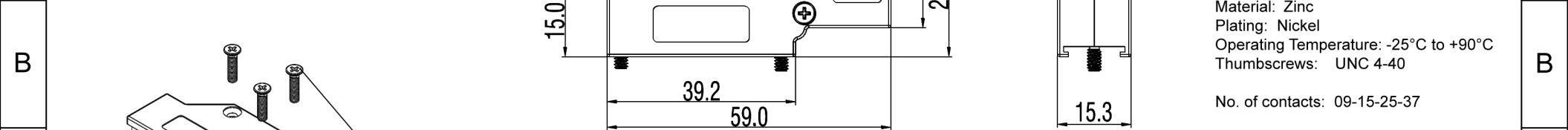
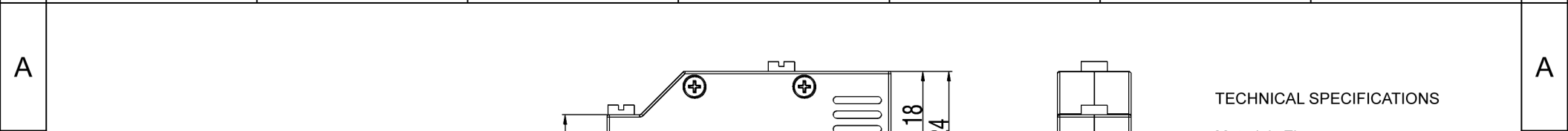

TECHNICAL SPECIFICATIONS
 Material: Zinc
 Plating: Nickel
 Operating Temperature: -25°C to +90°C
 Thumbscrews: UNC 4-40
 No. of contacts: 09-15-25-37

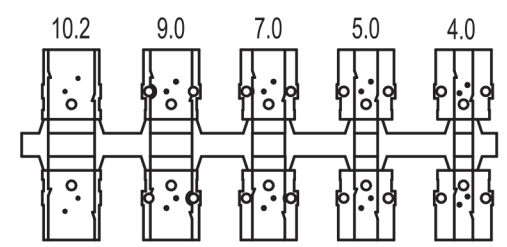
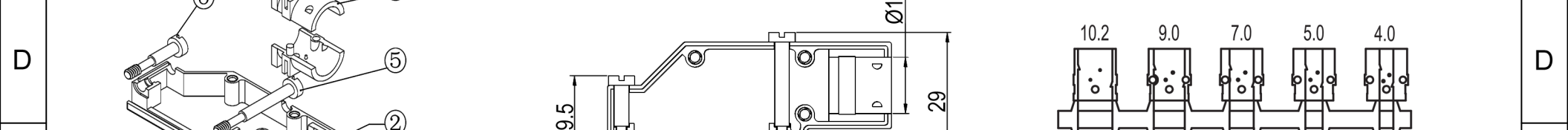

Grommet Set

Item	QTY	Part description
1	1	Upper Cover
2	1	Lower Cover
3	3	CSK M2.5x11.5 Screw
4	1	Grommet Set
5	1	Jackscrew UNC4-40x28.5
6	1	Jackscrew UNC4-40x19.5

G	RoHS compliant Unit: mm	Scale	Free				Date	Name	Customer-No.	
		TOLERANCE					Drawn	17.08.2017	S.Bölling	ASSMANN WSW-No. ACOV-SUB-15MB39
		0~6	±0.10				Approved	17.08.2017	S.Bölling	
6~30	±0.20									
		30~120	±0.30							
		120~400	±0.50	①	add assembly instruction	08.04.2020	S.Bölling			
		DIM	Tol	②	Drawn	17.08.2017	S.Bölling			
		Angle	±1°							
		Angle	Tol	Id.	Modification	Date	Name			



Drawing-No.
ASS_5280_CO rev01
 Replace Sheet 2/5

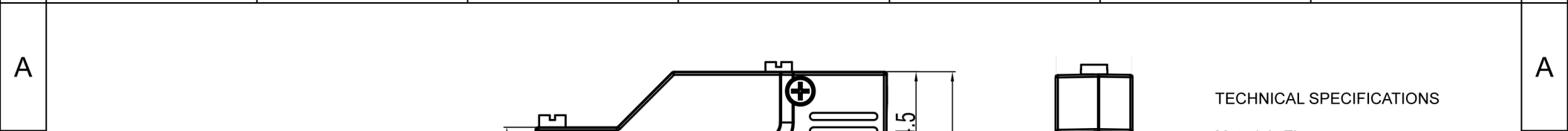

TECHNICAL SPECIFICATIONS
 Material: Zinc
 Plating: Nickel
 Operating Temperature: -25°C to +90°C
 Thumbscrews: UNC 4-40
 No. of contacts: 09-15-25-37

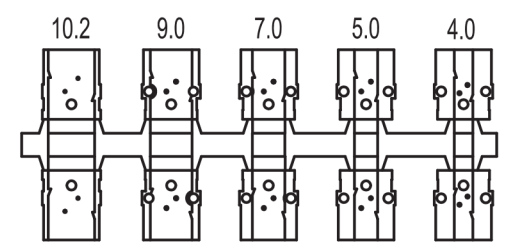
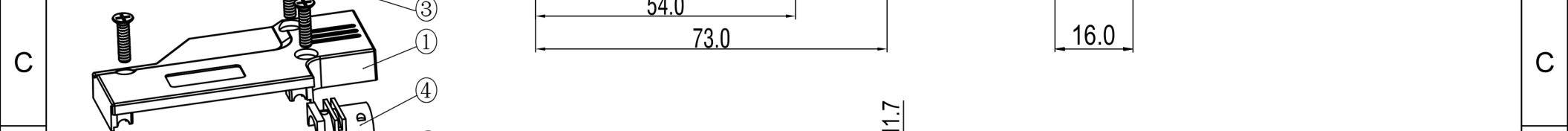
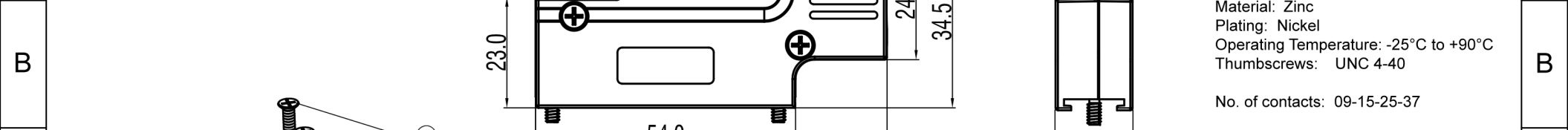

Grommet Set

Item	QTY	Part description
1	1	Upper Cover
2	1	Lower Cover
3	3	CSK M3x12 Screw
4	1	Grommet Set
5	1	Jackscrew UNC4-40x39.5
6	1	Jackscrew UNC4-40x28.5

G	RoHS compliant Unit: mm	Scale	Free				Date	Name	Customer-No.	
		TOLERANCE					Drawn	17.08.2017	S.Bölling	ASSMANN WSW-No. ACOV-SUB-25MB39
		0~6	±0.10				Approved	17.08.2017	S.Bölling	
		6~30	±0.20							
H		30~120	±0.30						Drawing-No.	
		120~400	±0.50	①	add assembly instruction	08.04.2020	S.Bölling	ASSMANN WSW components	ASS_5280_CO	rev01
		DIM	Tol	②	Drawn	17.08.2017	S.Bölling		Replace	Sheet 3/5
		Angle	±1°							
		Angle	Tol	Id.	Modification		Date	Name		

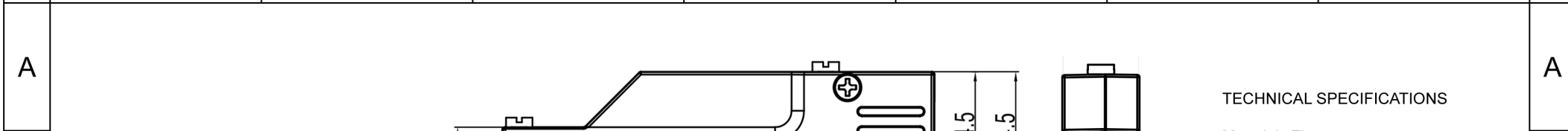

TECHNICAL SPECIFICATIONS

Material: Zinc
 Plating: Nickel
 Operating Temperature: -25°C to +90°C
 Thumbscrews: UNC 4-40

No. of contacts: 09-15-25-37

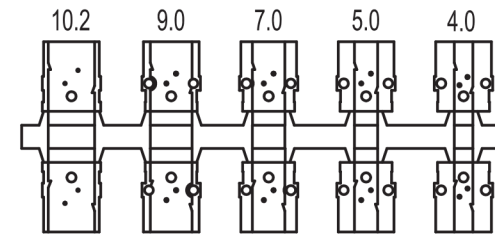
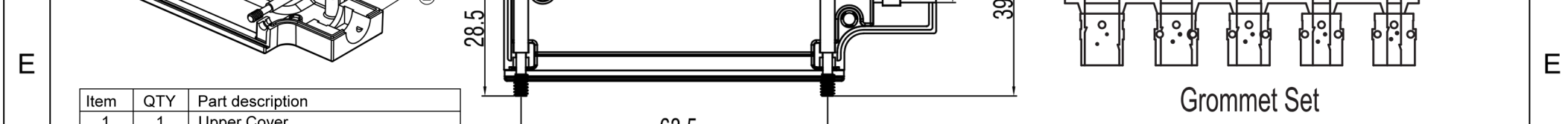
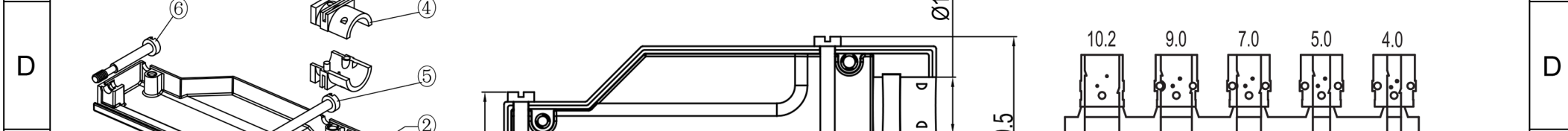
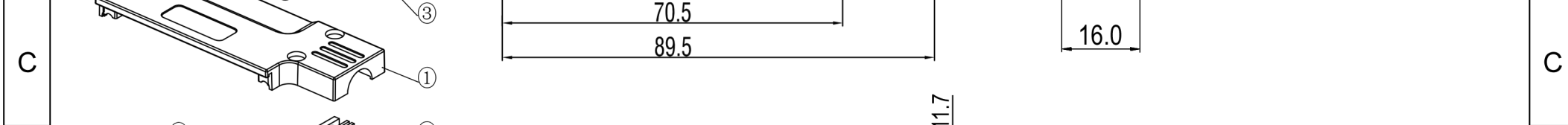

Item	QTY	Part description
1	1	Upper Cover
2	1	Lower Cover
3	3	CSK M3x12 Screw
4	1	Grommet Set
5	1	Jackscrew UNC4-40x39.5
6	1	Jackscrew UNC4-40x28.5

G	RoHS compliant Unit: mm		Scale	Free				Date	Name	Customer-No.
			TOLERANCE					Drawn	17.08.2017	S.Bölling
			0~6	±0.10				Approved	17.08.2017	S.Bölling
			6~30	±0.20						
H			30~120	±0.30						ASSMANN WSW-No. ACOV-SUB-37MB39
			120~400	±0.50	①	add assembly instruction	08.04.2020	S.Bölling	Drawing-No. ASS_5280_CO rev01	
			DIM	Tol	②	Drawn	17.08.2017	S.Bölling	Replace Sheet 4/5	
			Angle	±1°						
		Angle	Tol	Id.	Modification	Date	Name			

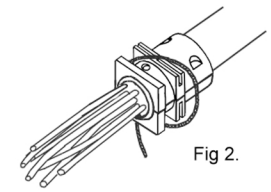
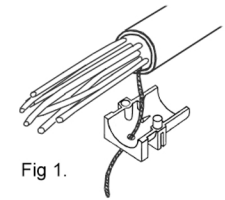
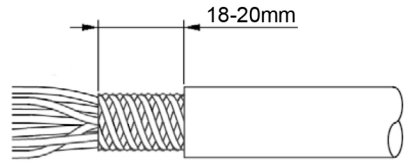
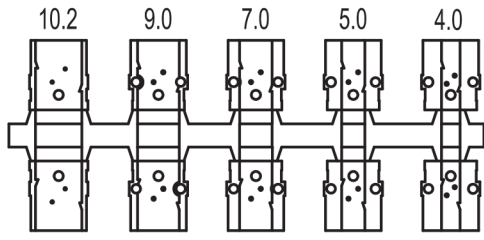

Select the ferrule halves that closest match the outer diameter of your cable - including the outer jacket. You can mix 2 different sizes to obtain the best fit. It is also possible to use only 1 half if necessary. Largest size 10,2mm is however not mixable with the others due to special design.

Prepare the cable by stripping approx. 18-20mm and shape the braid into two pigtails.

If Foiled cable is being used, Insert the drain wire into the small hole in one of the ferrule halves. (Fig. 1) Assemble the two halves as shown in Fig. 2 and loop the drain wire - preferably into a knot.

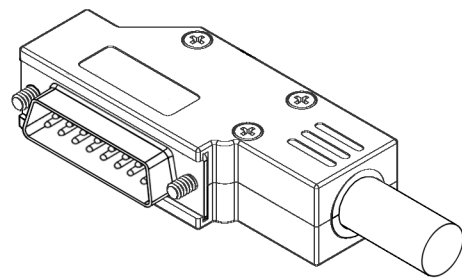
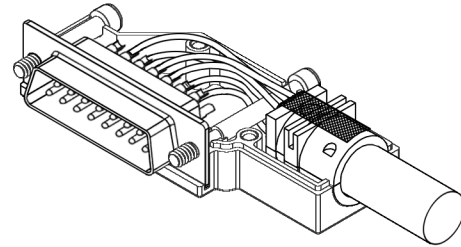
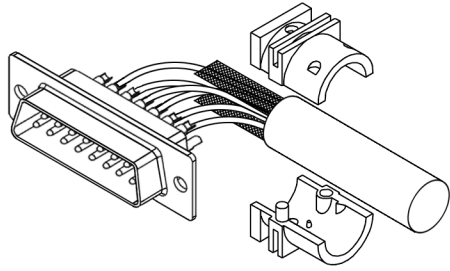

For standard braided cable - place the two ferrule halves around the cable as shown. Pigtail the braid and place it both under and over the ferrule halves.

Place the assembly inside the hood. Fit the longer Jackscrew in between the wires if needed.

Complete the assembly by putting top half and screw together with accompanied screw set. Recommended maximum torque is 150-200 Ncm.

RoHS compliant
Unit: mm

Scale	Free					Date	Name	Customer-No.
TOLERANCE						Drawn	17.08.2017	S.Bölling
0~6	±0.10					Approved	17.08.2017	S.Bölling
6~30	±0.20							
30~120	±0.30							
120~400	±0.50	①	add assembly instruction	08.04.2020	S.Bölling			
DIM	Tol	②	Drawn	17.08.2017	S.Bölling			
Angle	±1°							
Angle	Tol	Id.	Modification	Date	Name			

Drawing-No.		ASS_5280_CO	rev01
ASSMANN WSW-No. ACOV-SUB-XXMB39 - ASSEMBLY			
Replace		Sheet 5/5	