

A

B

C

D

E

1

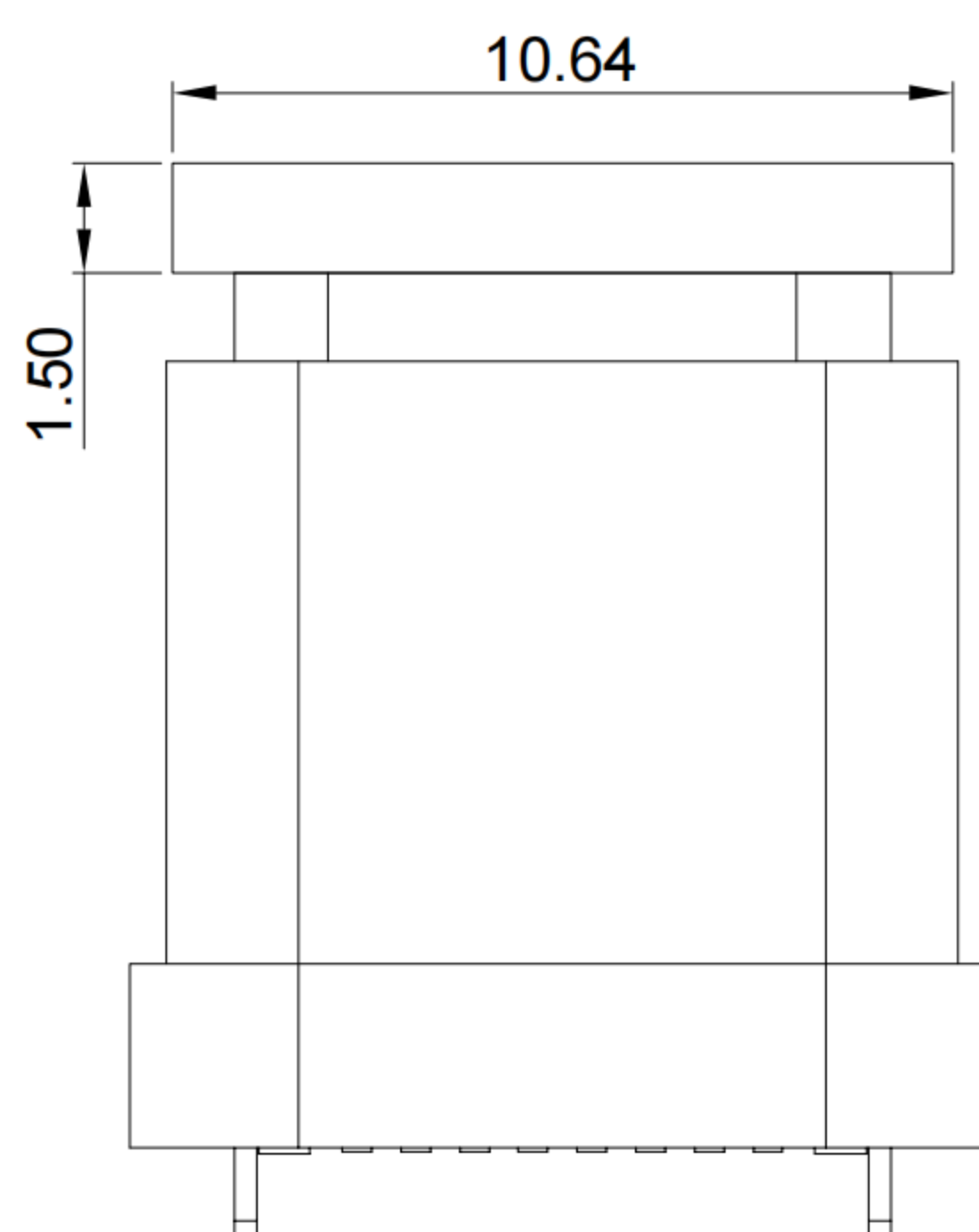
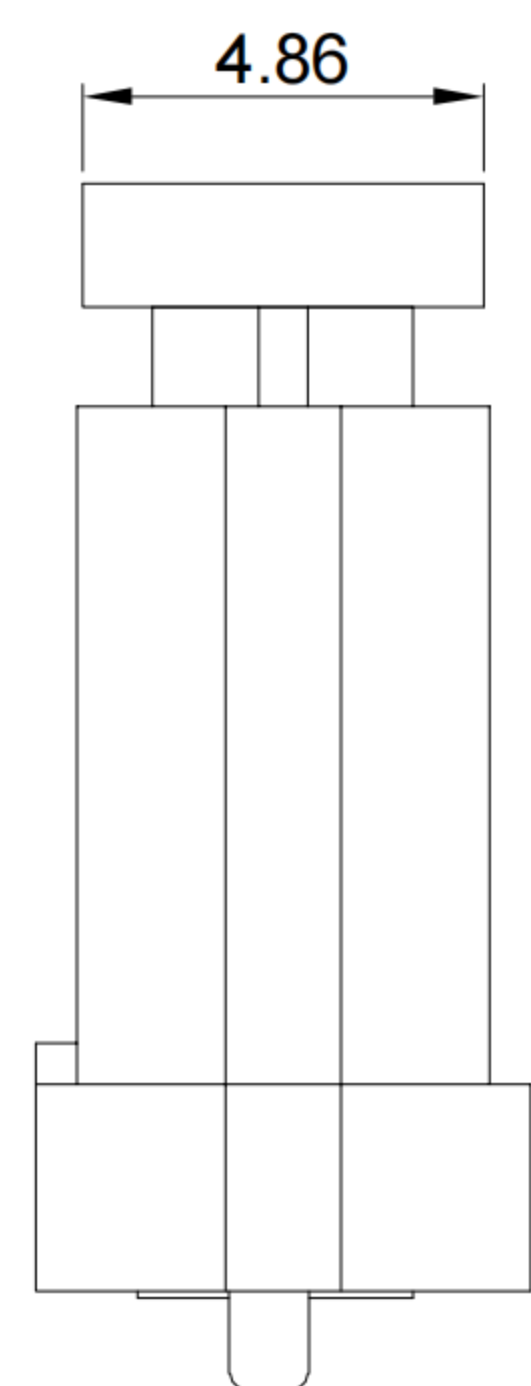
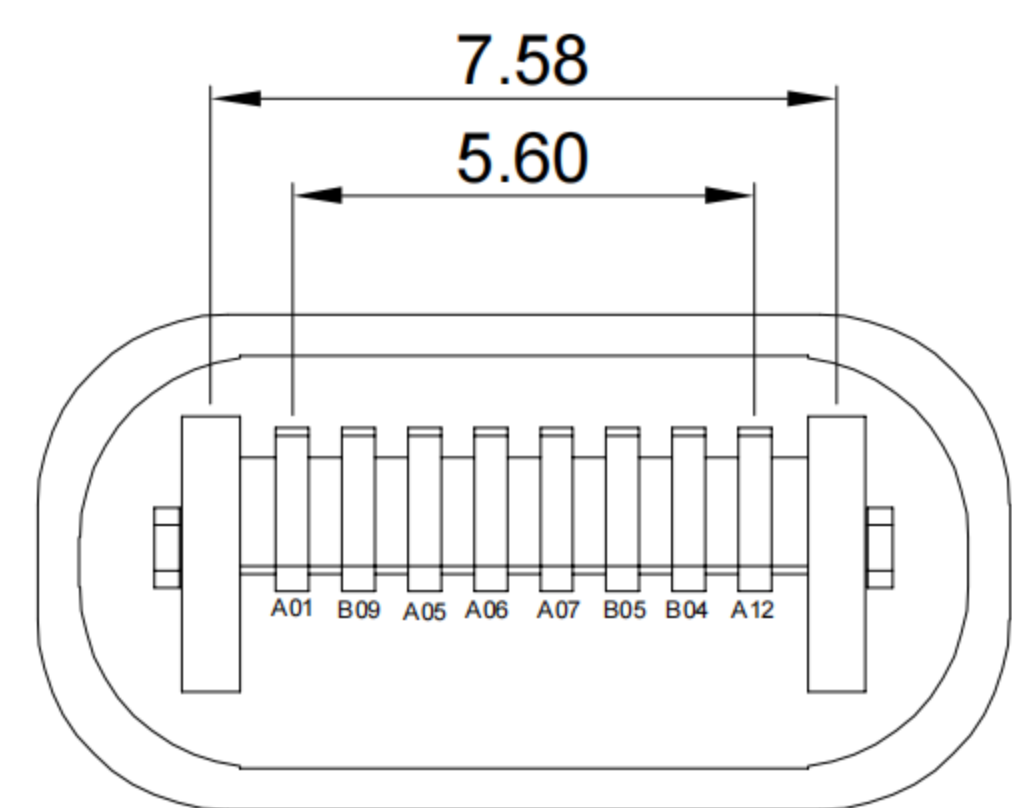

2

Schematic diagram of adding a waterproof ring

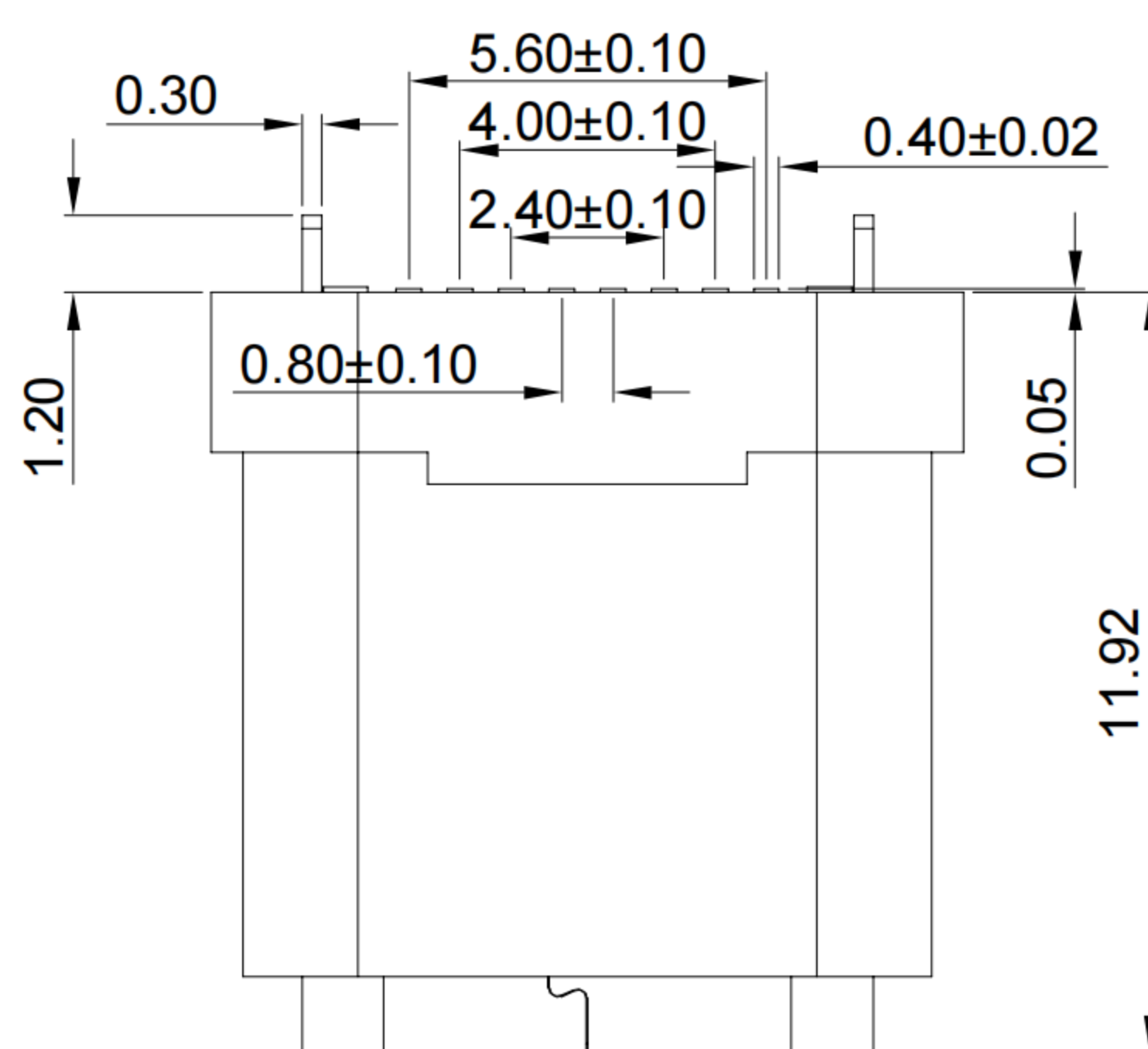
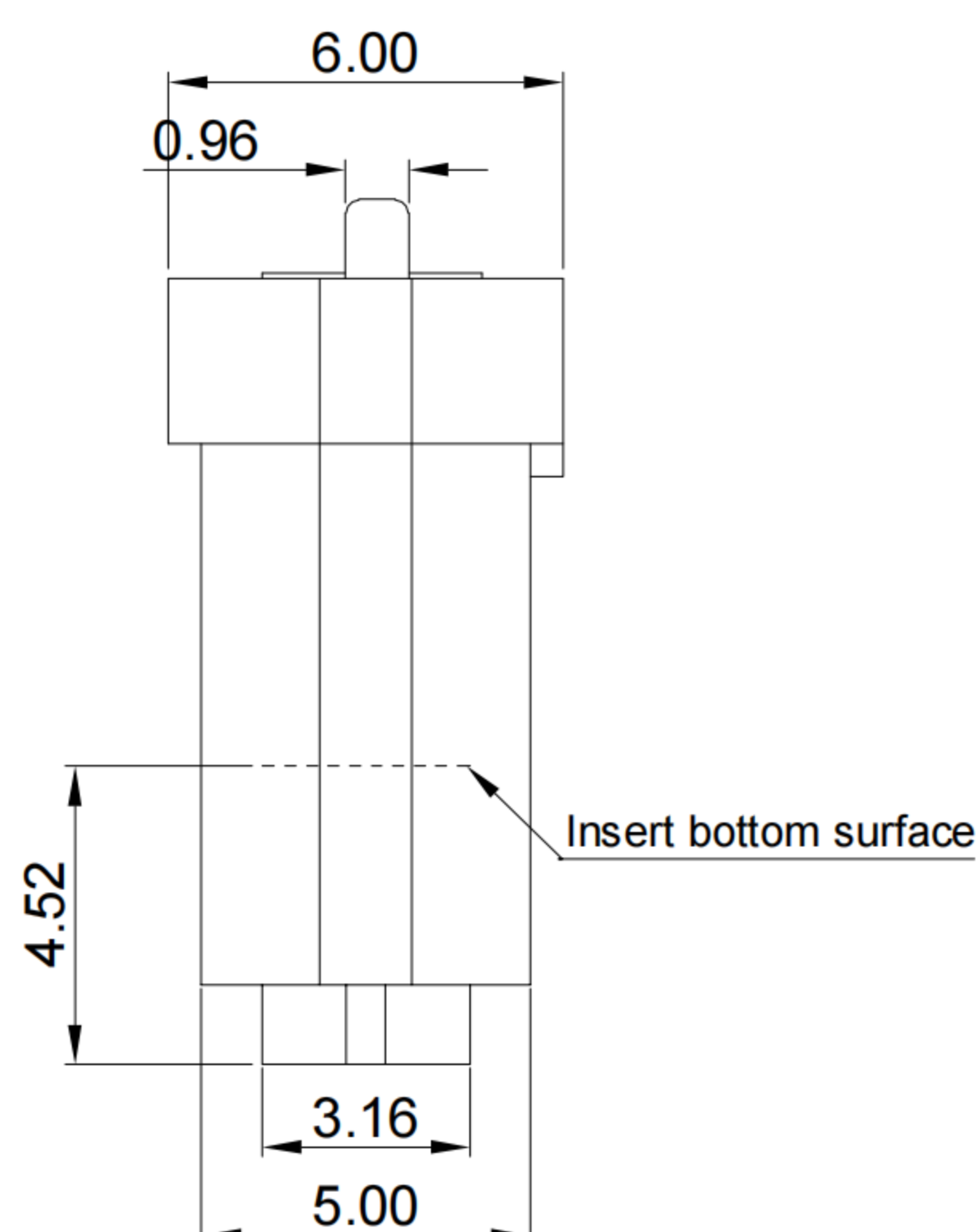
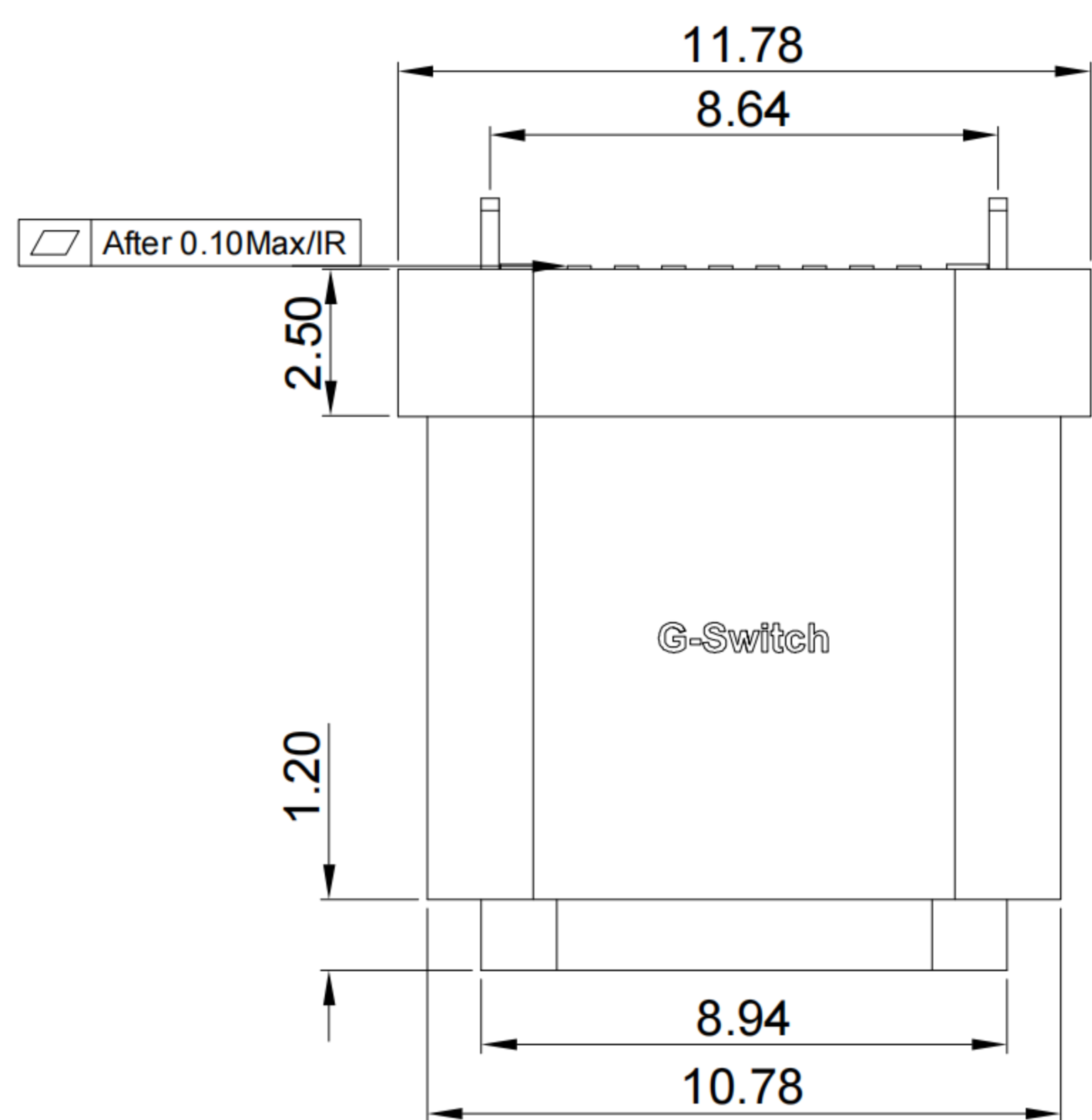

G-Switch USB-C Specification:

- 1.Current rated: 5A on vbus/1.25A on vconn/0.25A on other
- 2.Withstanding voltage: 24V AC
- 3.Contact resistance: 40mΩ Max
- 4.Insulation resistance: 100MΩ Min
- 5.Operating temperature: -40°C ~ +85°C
- 6.Mating force: 5N~20N
- 7.Unmating force: 8N~20N
- 8.Durability cycle: 10,000 cycles
- 9.Waterproof grade: IP-X8

3

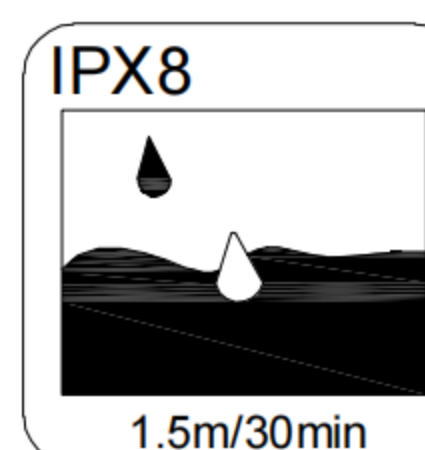
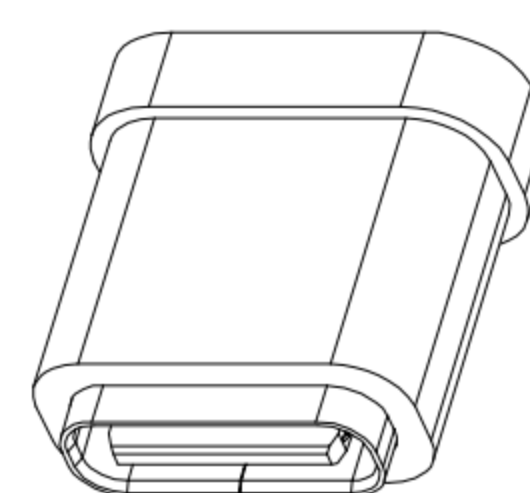
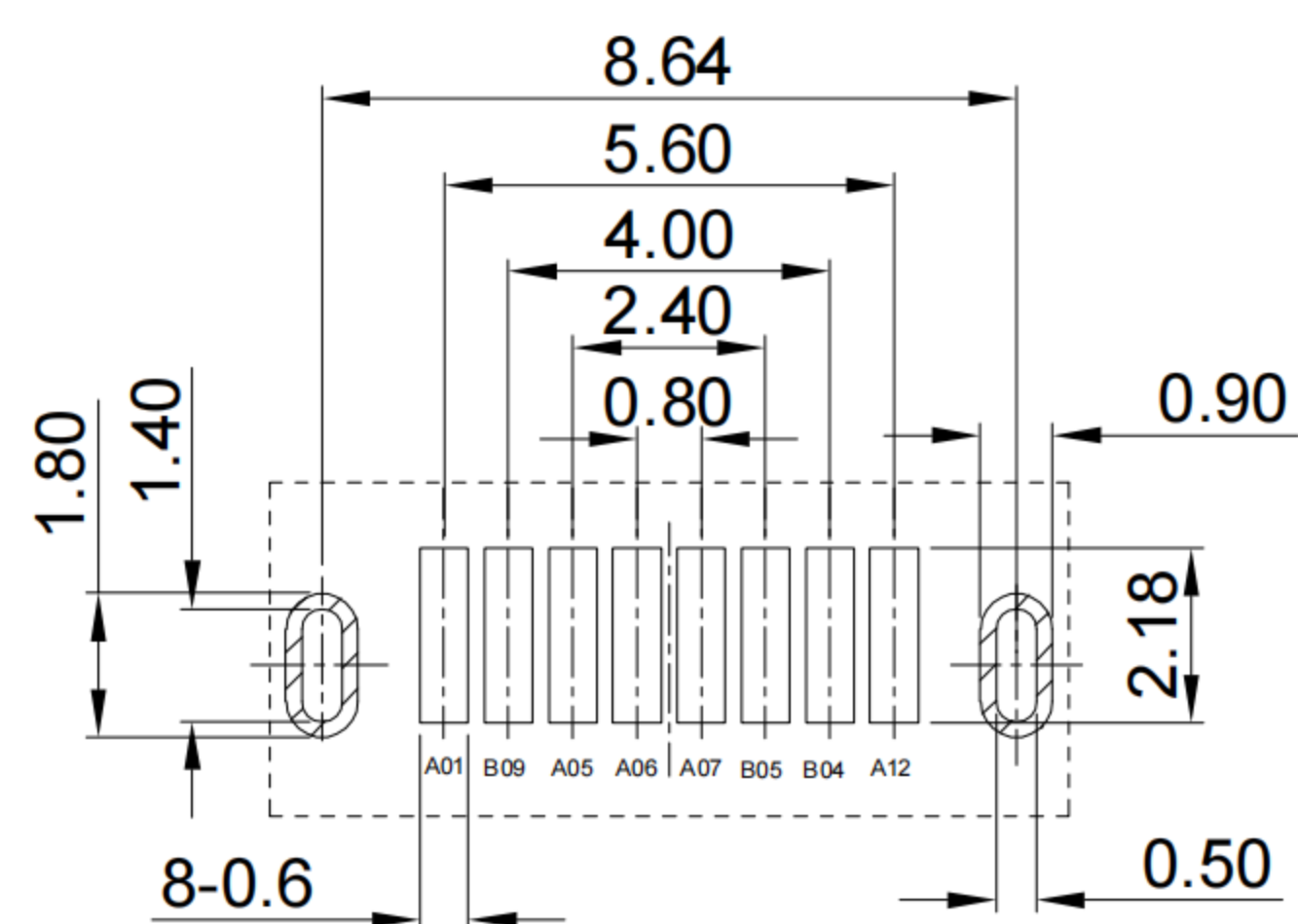
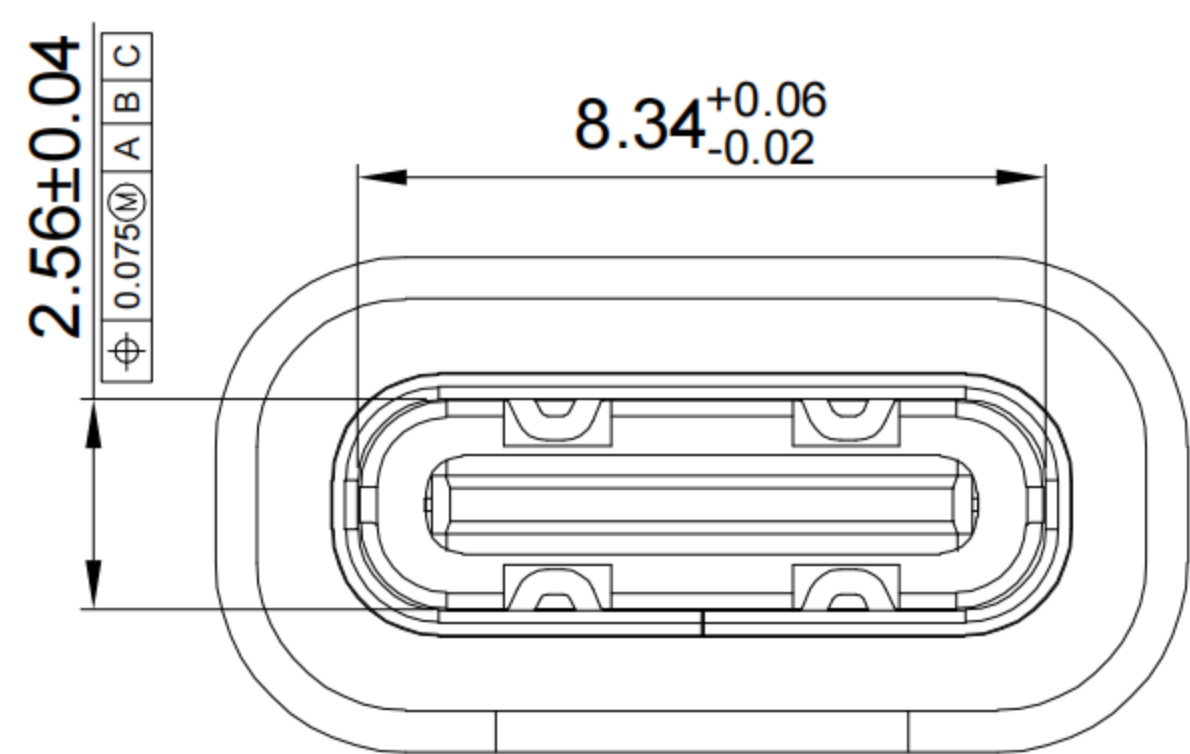

A1	A2	A3	A4	A5	A6	A7	A8	A9	A10	A11	A12
GND				CC1	D+	D-					GND
First				Second	Second	Second					First
B12	B11	B10	B9	B8	B7	B6	B5	B4	B3	B2	B1
			VBUS				CC2	VBUS			
			First				Second	First			

4

RECOMMENDED PCB LAYOUT TOLERANCE:±0.05

5

1	SHELL	STAINLESS STEEL	Ni PLATED
2	MID PLATE	STAINLESS STEEL	—
3	HOUSING	HIGH TEMPERATURE PLASTIC	BLACK UL 94 V-0
4	TERMINALS	COPPER ALLOY C7025	Au3u" PLATING ON CONTACT AREA
5	CAP	HIGH TEMPERATURE PLASTIC	BLACK UL 94 V-0
NO.	PARTS	MATERIAL	REMARKS



SCALE: 1:1 UNIT: mm
 SIZE: A4

Title: Vertical Type-c 8P Female
 SMT H=12.0mm

Unless otherwise
 General Tolerance:
 X.x ±0.30
 X.xx ±0.20
 X.xxx ±0.10
 X° ±3°

Molde Code: GT-USB-7015C

DRAWN	CHECKED	APPROVED	DATE
Xia	Chen	Chen	2023.02.31



REV: A0 SHEET: 1/1