

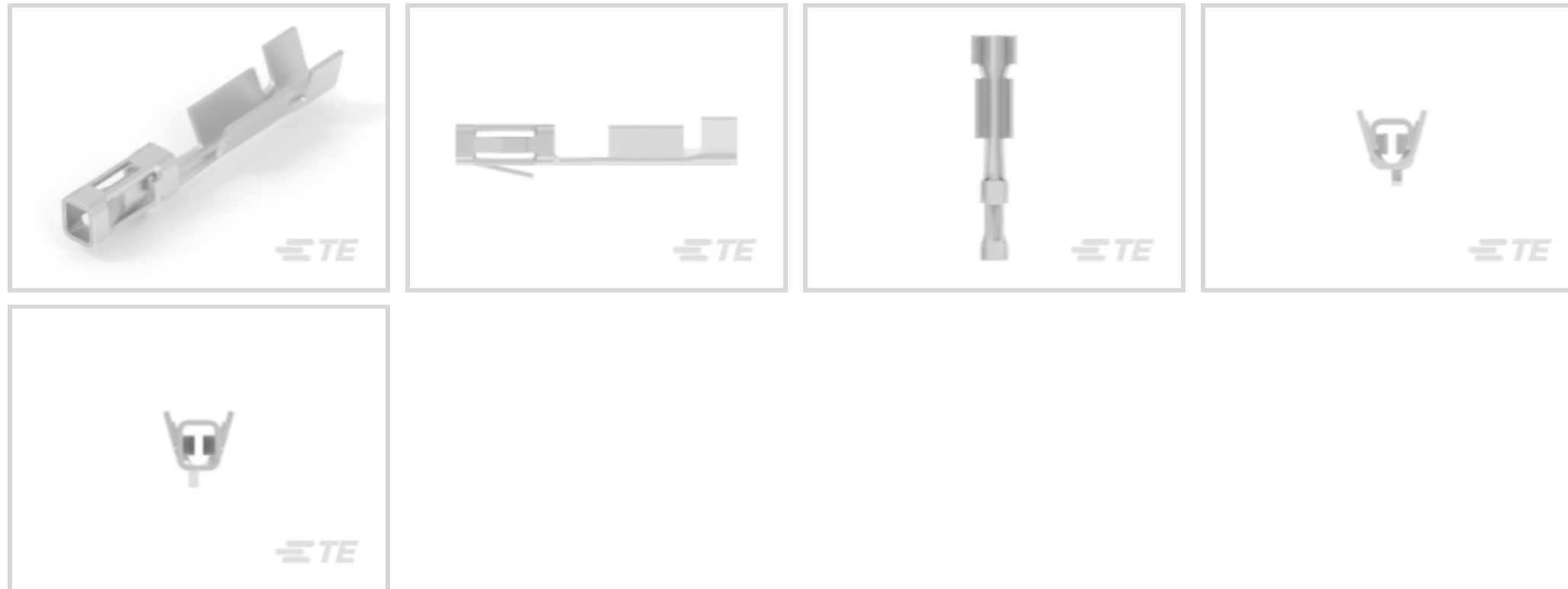

Connectors > Contacts > Connector Contacts



Contact Type: **Socket**

Contact Mating Area Plating Material: **Tin**

Wire Contact Termination Area Plating Material: **Tin**

Compatible With Wire & Cable Type: **Discrete Wire**

Wire Size: **24 – 20 AWG**

### Features

#### Product Type Features

Applied Pressure	Intermediate
------------------	--------------

#### Configuration Features

Compatible With Wire & Cable Type	Discrete Wire
-----------------------------------	---------------

#### Contact Features

Mating Square Post Dimension	.64 mm[.025 in]
Contact Type	Socket
Contact Mating Area Plating Material	Tin
Wire Contact Termination Area Plating Material	Tin
Contact Base Material	Phosphor Bronze
Contact Current Rating (Max)	3 A

#### Termination Features

Termination Method to Wire & Cable	Crimp
Product Terminates To	Wire & Cable



**Mechanical Attachment**

Wire Insulation Support	With
-------------------------	------

**Dimensions**

Wire Size	394.71 – 1184.12 CMA
-----------	----------------------

**Usage Conditions**

Operating Temperature Range	-65 – 105 °C[-85 – 221 °F]
-----------------------------	----------------------------

**Operation/Application**

Circuit Application	Power & Signal
---------------------	----------------

**Packaging Features**

Packaging Quantity	17500
Packaging Method	Reel

**Product Compliance**

[For compliance documentation, visit the product page on TE.com>](#)

EU RoHS Directive 2011/65/EU	Compliant
EU ELV Directive 2000/53/EC	Compliant
China RoHS 2 Directive MIIT Order No 32, 2016	No Restricted Materials Above Threshold
EU REACH Regulation (EC) No. 1907/2006	Current ECHA Candidate List: JUNE 2023 (235) Candidate List Declared Against: JUNE 2023 (235) Does not contain REACH SVHC
Halogen Content	Low Halogen - Br, Cl, F, I < 900 ppm per homogenous material. Also BFR/CFR/PVC Free
Solder Process Capability	Not applicable for solder process capability

Product Compliance Disclaimer

This information is provided based on reasonable inquiry of our suppliers and represents our current actual knowledge based on the information they provided. This information is subject to change. The part numbers that TE has identified as EU RoHS compliant have a maximum concentration of 0.1% by weight in homogenous materials for lead, hexavalent chromium, mercury, PBB, PBDE, DBP, BBP, DEHP, DIBP, and 0.01% for cadmium, or qualify for an exemption to these limits as defined in the Annexes of Directive 2011/65/EU (RoHS2). Finished electrical and electronic equipment products will be CE marked as required by Directive 2011/65/EU. Components may not be CE marked. Additionally, the part numbers that TE has identified as EU ELV compliant have a maximum concentration of 0.1% by weight in homogenous materials for lead, hexavalent chromium, and mercury, and 0.01% for cadmium, or qualify for an exemption to these limits as defined in the Annexes of Directive 2000/53/EC (ELV). Regarding the REACH Regulation, the information TE provides on SVHC in articles for this part number is based on the latest European Chemicals Agency (ECHA) 'Guidance on requirements for substances in articles' posted at this URL: <https://echa.europa.eu/guidance-documents/guidance-on-reach>

## Compatible Parts

 <p>TE Part # 843473-1 EXTRACTION TOOL</p>	 <p>TE Part # 925370-5 MOD IV REC HSG 2X5P.</p>	 <p>TE Part # 925366-8 MOD 4 REC.HSG 1X08P</p>	 <p>TE Part # 926476-3 MOD 4 HSG</p>
 <p>TE Part # 925370-6 MOD.IV REC HSG, 2X6P</p>	 <p>TE Part # 925369-4 MOD IV HSG</p>	 <p>TE Part # 926475-3 03P MODU 4 HSG.S.R.</p>	 <p>TE Part # 926475-4 MOD 4 HSG</p>
 <p>TE Part # 925369-3 MOD 4 REC.HSG 1X03P</p>	 <p>TE Part # 925369-6 MOD 4 REC.HSG 1X06P</p>	 <p>TE Part # 925370-2 MOD IV REC HSG, 2X2P</p>	 <p>TE Part # 925369-2 MOD 4 REC.HSG 1X02P</p>
 <p>TE Part # 925366-2 MOD 4 REC.HSG 1X02P</p>	 <p>TE Part # 925370-4 MOD IV REC HSG 2X4 POS</p>	 <p>TE Part # 926476-4 2X4P MODU 4 HSG.</p>	 <p>TE Part # 925367-4 MOD 4 REC.HSG 2X04P</p>
 <p>TE Part # 925369-5 MOD 4 REC.HSG 1X05P</p>	 <p>TE Part # 925370-3 MOD IV REC HSG, 2X3P</p>	 <p>TE Part # 926476-6 MOD 4 HSG</p>	 <p>TE Part # 1-925366-0 MOD 4 REC.HSG 1X10P</p>

Also in the Series | **AMPMODU IV/V**

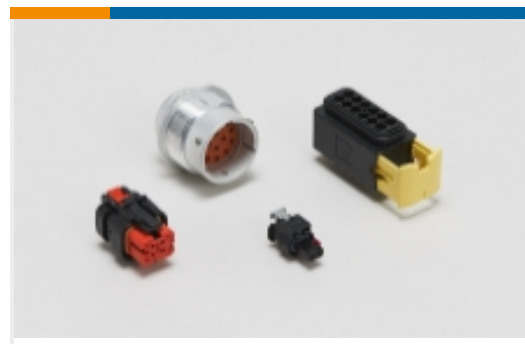

Automotive Housings(1)

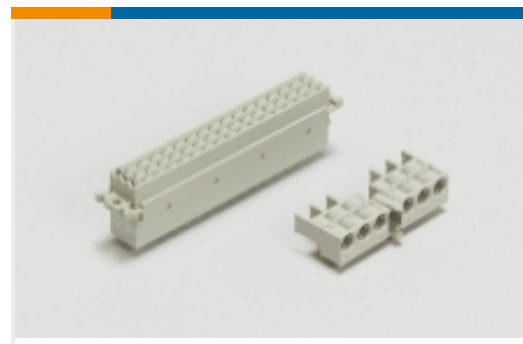

Backplane Connector Housings(1)



Connector Caps & Covers(18)

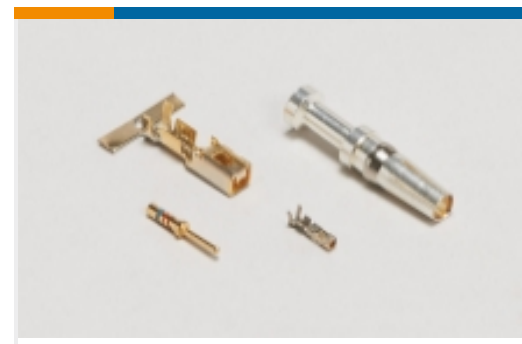

Connector Contacts(322)



Connector Hardware(13)



Connector Strain Relief(3)



Insertion & Extraction Tools(4)

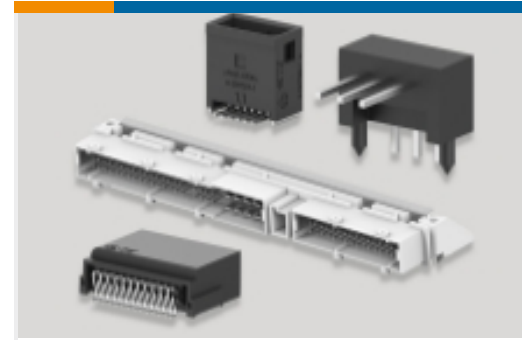

PCB Headers & Receptacles(931)



Rectangular Connector Housings(5)



Standard Rectangular Connectors(8)



Wire-to-Board Connector Assemblies & Housings(444)

## Customers Also Bought



TE Part #102387-6  
26 MODIV HSG COMP DR .100 POL



TE Part #61407-3  
187 FASTON TPBR



TE Part #144684-1  
COVER MODU IV 2X3 POS.

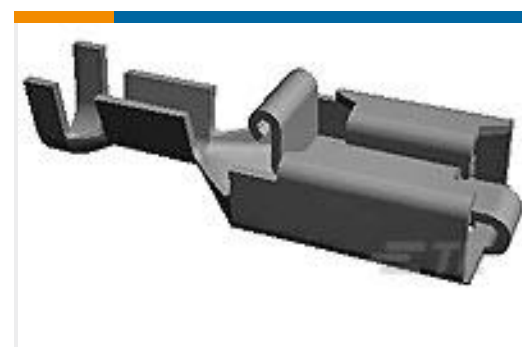

TE Part #1-160759-2  
250 PL MKI REC. 20-15AWG PTPB



TE Part #2-32953-1  
PG R 22-16 COMM 22-18 MIL 1/4



TE Part #2327989-1  
M12 X-CODE CAT6A



TE Part #1-150656-1  
SHUR PLUG .156 DIA REC 20-16 AWG PB



TE Part #880684-2  
.140 DIA PIN

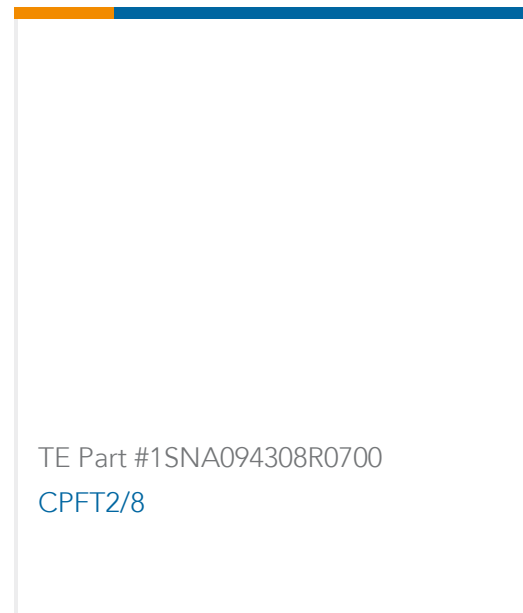
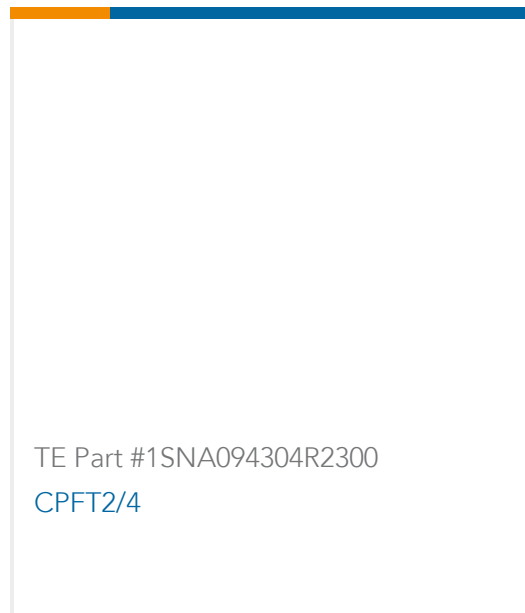

## Documents

### Product Drawings

[MOD-4 REC.CONT.SCP](#)

English

### CAD Files

[3D PDF](#)

English

**Customer View Model**

[ENG\\_CVM\\_2-167301-2\\_J.3d\\_igs.zip](#)

English

**Customer View Model**

[ENG\\_CVM\\_2-167301-2\\_J.3d\\_stp.zip](#)

English

**Customer View Model**

[ENG\\_CVM\\_2-167301-2\\_J.2d\\_dxf.zip](#)

English

By downloading the CAD file I accept and agree to the [Terms and Conditions](#) of use.