

SPECIFICATIONS

- Rated Voltage: 250V AC, DC
- Current rating: 12A, AC, DC
- Withstanding Voltage: 1,500V AC/minute
- Insulation resistance: 1,000MΩ Min
- Temperature range: -40°C to +105°
- Contact resistance: 20mΩ max

TERMINAL

○ Part No: CS-1149-T 216 HJ G

T: 端子

216: 特高脚 (包双线2*AWG16#)

G: 镀半金1u"

HJ: 合金铜新型四面弹片结构

- Wire Range: AWG#16*2
- Material: Alloy Copper (550)
- Thickness: 0.20mm
- Finish: Tin Plated/GOLD PLATED
- Q' TY: 3,000 pcs/reel

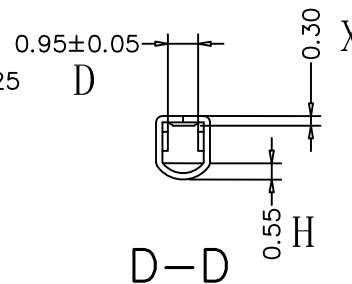
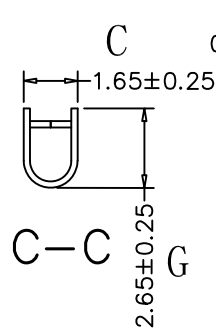
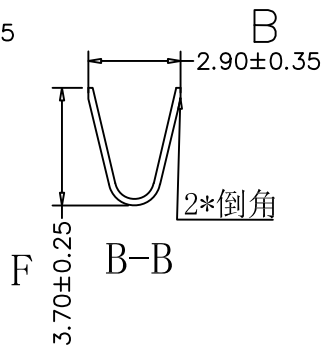
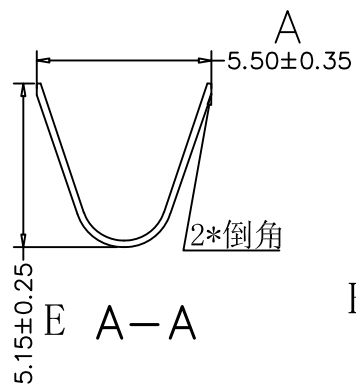

RoHS 2.0

* 本圖紙知識產權及版權由永丰盈电子有限公司所有, 未經許可不准擅自复制和修改. 本公司保留法律追究的权利.

| | | | | | | | | | | | | |
|-------------|---------------------|----------|-----------------|--------|-------|--|--|---------|-----|--------------|--------|-------------|
| SORT | TERMINAL | PART NO. | CS-1149-T216HJG | X. | ±0.50 | MATERIAL | | MOLD NO | | SHEET 1 OF 1 | | |
| VERSION | A/0 | DESIGNER | WENCHANG LI | X.X | ±0.30 | RIGIDITY | | UNIT | mm | △ | REVISE | REVISE DATE |
| FRAME | ENGINEER DEPARTMENT | DRAW BY | WENCHANG LI | X.XX | ±0.20 | PROJECTION | | SCALE | 1:1 | △ | | |
| DRAWING NO. | CS-1149-T216XXX | CHECK BY | ZHOU ZHONGHU | X.XXX | ±0.10 | 永丰盈电子有限公司 YONG FENG YING ELECTRONIC CO., LTD. | | | | △ | | |
| DATE | 2020.12.29 | APPROVE | HUANG HAI FENG | X.XXXX | ±0.05 | | | | | △ | | |