



Washer for emergency stop, yellow, without inscription Outer diameter 45 mm, Inside diameter 22.5 mm, Thickness 2 mm, Z=100-unit packaging

<b>product brand name</b>	SIRIUS ACT
<b>product designation</b>	EMERGENCY STOP plate
<b>product type designation</b>	3SU1
<b>General technical data</b>	
shock resistance for railway applications acc. to DIN EN 61373	Category 1, Class B
vibration resistance for railway applications acc. to DIN EN 61373	Category 1, Class B
<b>Accessories</b>	
<b>material of accessory</b>	Plastic
<b>fastening method of label</b>	without
<b>marking of backing plate</b>	none
<b>shape of backing plate</b>	Round
<b>color of backing plate</b>	yellow/black (plate/text)
<b>product function illuminated backing plate</b>	No
<b>Certificates/ approvals</b>	
<b>Further information</b>	

Information- and Downloadcenter (Catalogs, Brochures,...)

<https://www.siemens.com/ic10>

Industry Mall (Online ordering system)

<https://mall.industry.siemens.com/mall/en/en/Catalog/product?mlfb=3SU1900-0BA31-0AA0-Z X90>

Cax online generator

<http://support.automation.siemens.com/WW/CAXorder/default.aspx?lang=en&mlfb=3SU1900-0BA31-0AA0-Z X90>

Service&Support (Manuals, Certificates, Characteristics, FAQs,...)

<https://support.industry.siemens.com/cs/ww/en/ps/3SU1900-0BA31-0AA0-Z X90>

Image database (product images, 2D dimension drawings, 3D models, device circuit diagrams, EPLAN macros, ...)

[http://www.automation.siemens.com/bilddb/cax\\_de.aspx?mlfb=3SU1900-0BA31-0AA0-Z X90&lang=en](http://www.automation.siemens.com/bilddb/cax_de.aspx?mlfb=3SU1900-0BA31-0AA0-Z X90&lang=en)

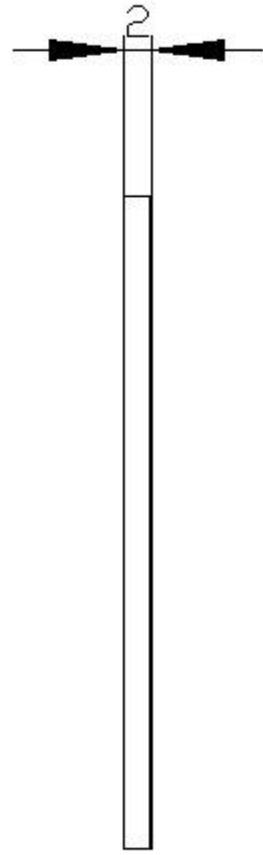
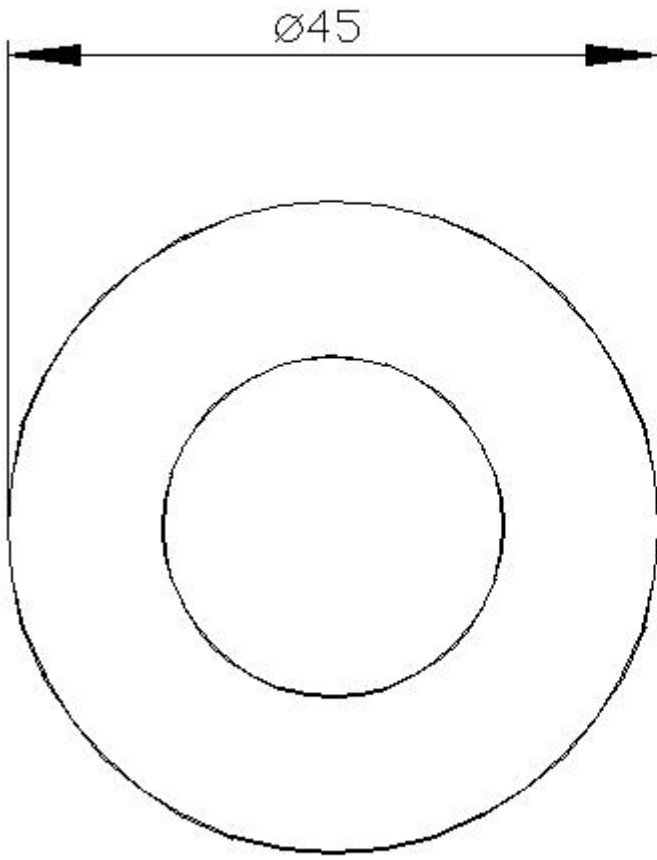

last modified:

12/21/2020 