

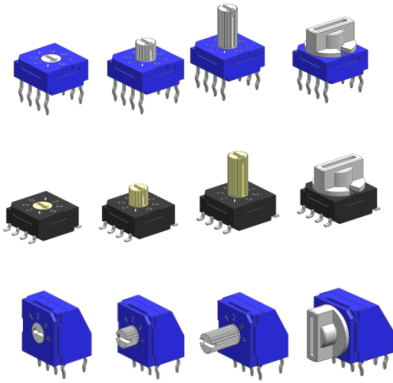

Features

- ◆ Washable, Meet IP67
- ◆ Gold-plated contacts
- ◆ Surface Mount, Thru-Hole and Right Angle
- ◆ Flush or extended rotor
- ◆ Knobs available



Standard Specifications :

Operating temperature range : -40°C ~ +85°C
 Storage temperature range : -25°C ~ +70°C
 Sealing : Washable, with "O" ring
 Mechanical Life : 20,000 Steps

Electrical Characteristics

Contact rating :
 Non-switching : DC 50V, 100mA
 Switching : DC 5V, 100mA
 Minimum : DC 20mV, 1 μA
 Contact timing : Non-shorting
 Contact resistance (Initial/ after life) : 60mΩ / 100mΩ
 Insulation resistance : 100MΩ (DC 100V) Max.
 Dielectric strength : 300VAC / 1 minute

Soldering Information :

Wave soldering : 260±5°C for 5 sec. max.
 Reflow soldering : Peak temp. 245°C max.
 The time above 240 must be 30 sec. max.
 Hand soldering : 350°C 3 Sec. max.

Order Information

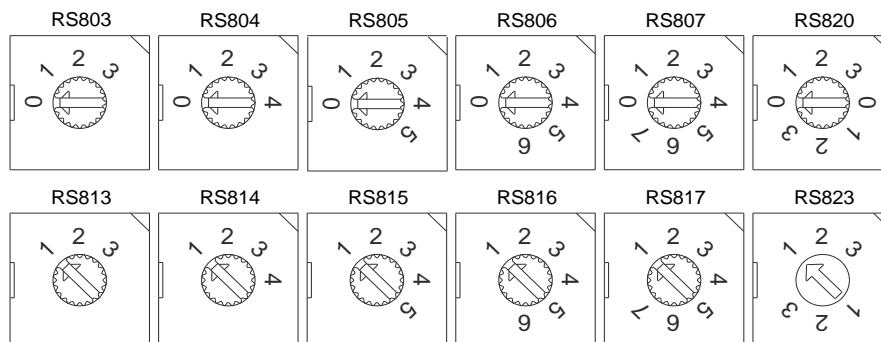
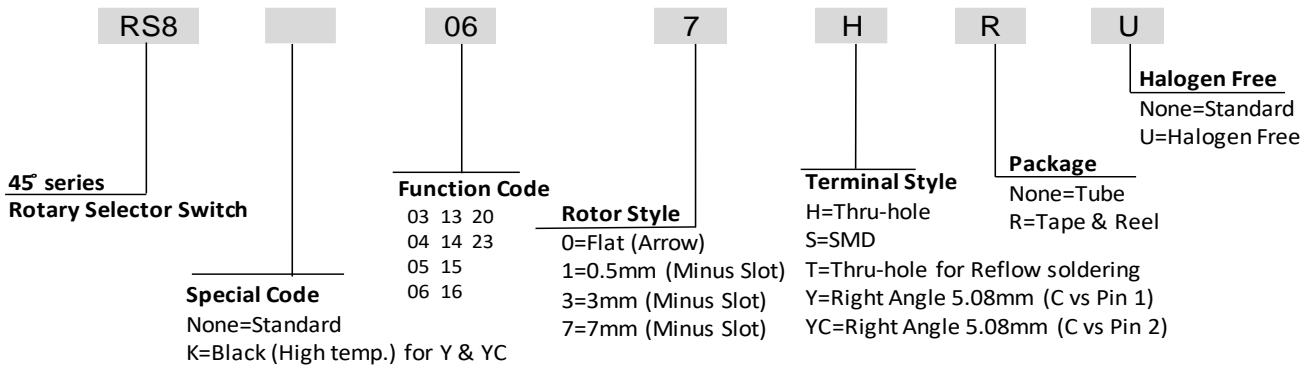

Rotor Style

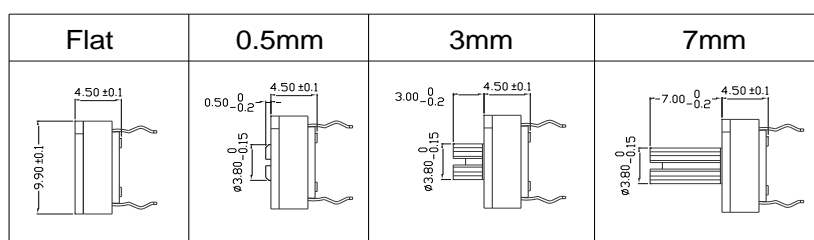



Schematic & Terminal Connection

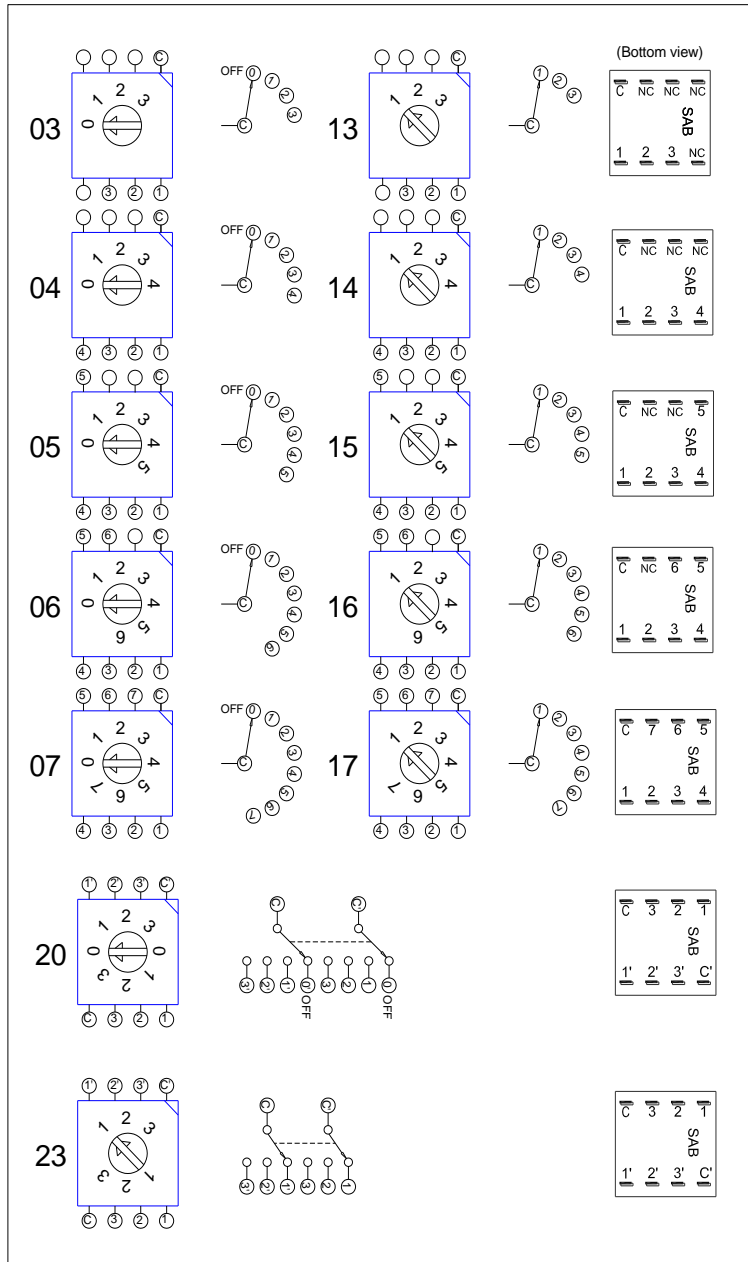

Package

P/N	Function Code	Quantity per Tube
RS8_H/T	03,04,05,06,07	50
RS8_H/T	13,14,15,16,17	50
RS8_H/T	20,23	50
RS8_S	03,04,05,06,07	50
RS8_S	13,14,15,16,17	50
RS8_S	20,23	50
RS8K_Y	03,04,05,06,07	45
RS8K_Y	13,14,15,16,17	45
RS8K_Y	20,23	45
P/N	Function Code	Quantity per Reel
RS8_0/1S-R	03,04,05,06,07	600
RS8_0/1S-R	13,14,15,16,17	600
RS8_0/1S-R	20,23	600
RS8_3S-R	03,04,05,06,07	350
RS8_3S-R	13,14,15,16,17	350
RS8_3S-R	20,23	350
RS8_7S-R	03,04,05,06,07	200
RS8_7S-R	13,14,15,16,17	200
RS8_7S-R	20,23	200
RS8_7H/T-R	03,04,05,06,07	140
RS8_7H/T-R	13,14,15,16,17	140
RS8_7H/T-R	20,23	140

Dummy Terminals

3 positions	④⑤⑥⑦
4 positions	⑤⑥⑦
5 positions	⑥⑦
6 positions	⑦
7 positions	--

* NC= Dummy terminal

Knob Order Information

KR1

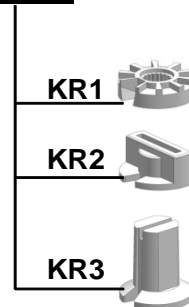

08

Knob Color

- 00 : Blue
- 02 : Green
- 03 : Light Grey
- 04 : Yellow
- 05 : Dark Grey
- 08 : Red
- 09 : Black



Outline Dimensions

Thru-Hole

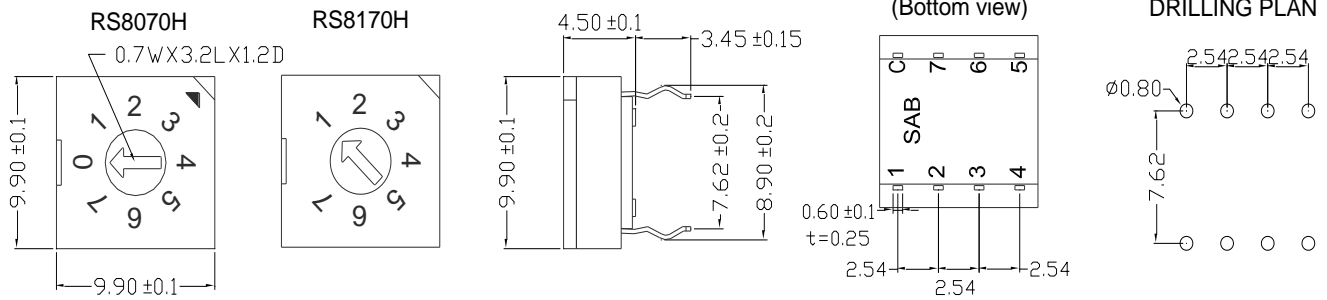

SMD

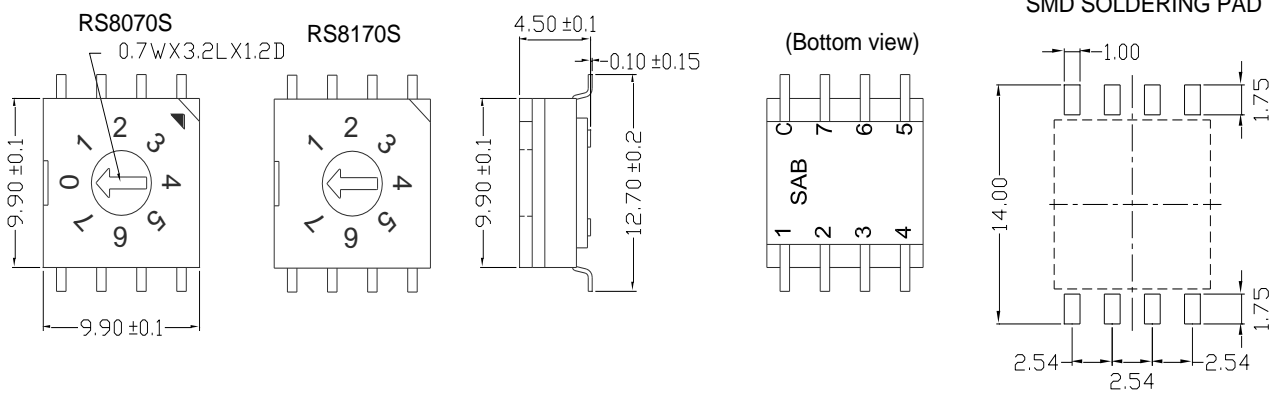

Right Angle 5.08mm (C vs Pin 1)

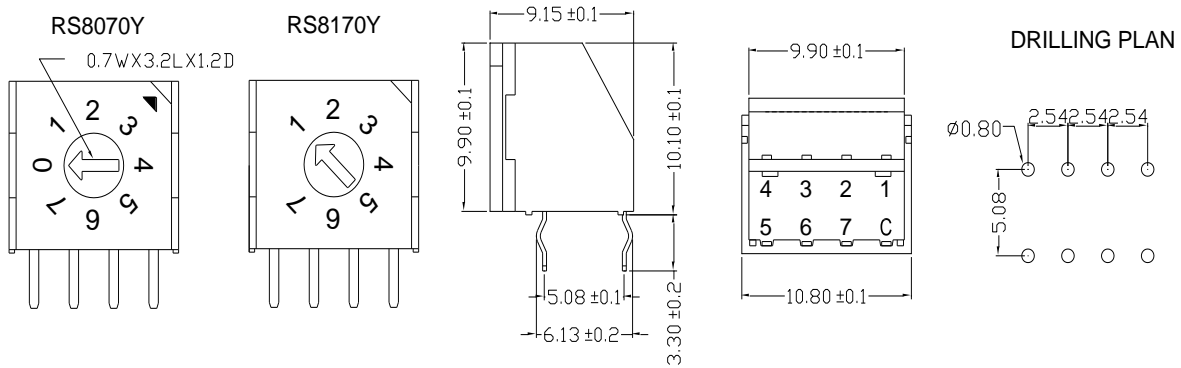

Right Angle 5.08mm (C vs Pin 2)

