

REVISIONS			
REV	DESCRIPTION	DATE	APPV
A	INITIAL PRODUCTION RELEASE	3/18/16	SHOGAN
		3/7/2022	

NOTES: (UNLESS OTHERWISE SPECIFIED)

- ALL DIMENSIONS ARE IN MILLIMETERS [IN].
- DIMENSIONS APPLY AFTER FINISHING.
- MANUFACTURE TO BE COMPLIANT WITH EU RoHS DIRECTIVE, USE MATERIALS THAT DO NOT CONTAIN REACH SUBSTANCES OF VERY HIGH CONCERN >1000ppm, AND USE DRC CONFLICT-FREE SOURCED MATERIALS.
- ELECTRICAL PROPERTIES ARE SHOWN FOR REFERENCE ONLY. SEE LINX DATA SHEET FOR PERFORMANCE SPECIFICATIONS.
  - IMPEDANCE: 50Ω
  - VSWR: 1.9MAX @ 2.45GHz ± 50MHz
- ANTENNA QUALIFIED IAW LINX TEST PLAN DOCUMENT AT LATEST REVISION.
- MECHANICAL SPECIFICATIONS
  - COLOR BAND: PINK [PANTONE 246U]
  - MARKING TO BE PERMINANT.
  - OPERATING TEMPERATURE: -40°C - 90°C
  - INTERCONNECT: SMA TYPE IAW MIL-STD-348B. REVERSE POLARITY INTERCONNECTS ARE SMA BASED AND ARE COMPATABLE WITH OTHER INTERCONNECTS OF THIS TYPE.
- PACKAGE ANTENNAS INDIVIDUALLY BEFORE PLACING IN LOT BAG.
- LABELING TO INCLUDE THE FOLLOWING INFORMATION ONLY ON LOT BAG, AND BOX
  - LOT NUMBER
  - LINX PART NUMBER
  - QUANTITY
  - COUNTRY OF ORIGIN

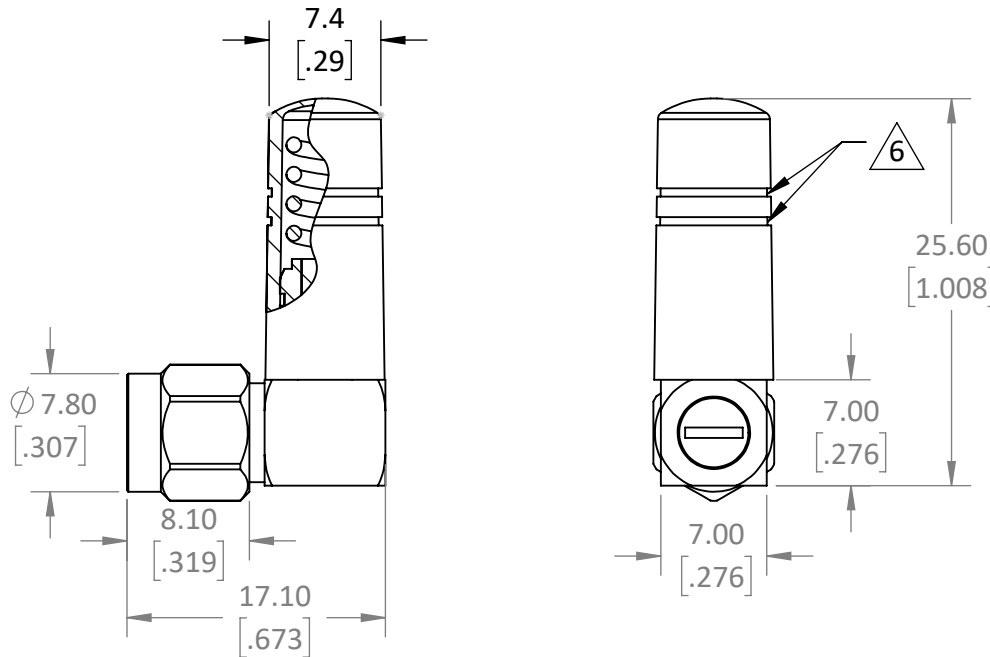

**WARNING:** THIS DRAWING CONTAINS PROPRIETARY INFORMATION THAT IS THE SOLE PROPERTY OF LINX TECHNOLOGIES, AND SHALL BE TREATED AS SUCH. NO DISCLOSURE OR REPRODUCTION OF THIS DOCUMENT IS PERMITTED, IN WHOLE OR IN PART, WITHOUT THE EXPRESS WRITTEN PERMISSION OF LINX TECHNOLOGIES OR ITS DESIGNATED AGENTS.



159 ORT LANE  
MERLIN, OR 97532

TITLE:  
**ANTENNA RAH 2.4GHz  
SMA AND RPSMA TABULATION**

PART NUMBER	CONNECTOR TYPE	PIN MATERIAL
ANT-2.4-CW-RAH-SMA	SMA	BsBM
ANT-2.4-CW-RAH-RPS	RP-SMA	BeCu

MATERIAL: BRASS, BeCu CuSnP, TPE	INTERPRET DIMENSIONS AND TOLERANCES PER ASME Y14.5. .X ±2.0 .XX ±1.00 .XXX ±.500	PROJECTION: ANGLES: ±1° SURFACE: √	
FINISH: GOLD NAT, BLACK	DRAWN: S.HOGAN ENGR: DASARATHAN	DT: 3/18/16 DT: 3/18/16	

SIZE <b>A</b>	DWG. NO. <b>C-ANT-2.4-CW-RAH-CCC</b>	REV <b>B</b>
SCALE: 2:1	DO NOT SCALE DRAWING	SHEET 1 OF 1