

POLES	P/N	A	B	C
2	1.0T-2P-WT	1.00	2.50	4.00
3	1.0T-3P-WT	2.00	3.50	5.00
4	1.0T-4P-WT	3.00	4.50	6.00
5	1.0T-5P-WT	4.00	5.50	7.00
6	1.0T-6P-WT	5.00	6.50	8.00
7	1.0T-7P-WT	6.00	7.50	9.00
8	1.0T-8P-WT	7.00	8.50	10.00
9	1.0T-9P-WT	8.00	9.50	11.00
10	1.0T-10P-WT	9.00	10.50	12.00
11	1.0T-11P-WT	10.00	11.50	13.00
12	1.0T-12P-WT	11.00	12.50	14.00
13	1.0T-13P-WT	12.00	13.50	15.00
14	1.0T-14P-WT	13.00	14.50	16.00
15	1.0T-15P-WT	14.00	15.50	17.00
16	1.0T-16P-WT	15.00	16.50	18.00
17	1.0T-17P-WT	16.00	17.50	19.00
18	1.0T-18P-WT	17.00	18.50	20.00
19	1.0T-19P-WT	18.00	19.50	21.00
20	1.0T-20P-WT	19.00	20.50	22.00
22	1.0T-22P-WT	21.00	22.50	24.00
24	1.0T-24P-WT	23.00	24.50	26.00
26	1.0T-26P-WT	25.00	26.50	28.00

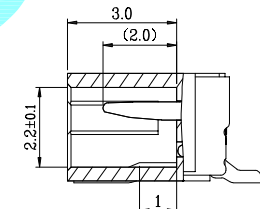

SECTION A-A

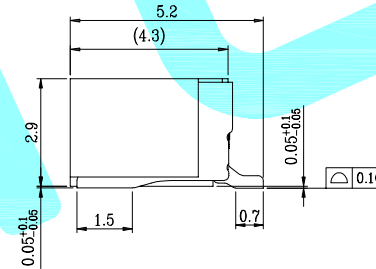
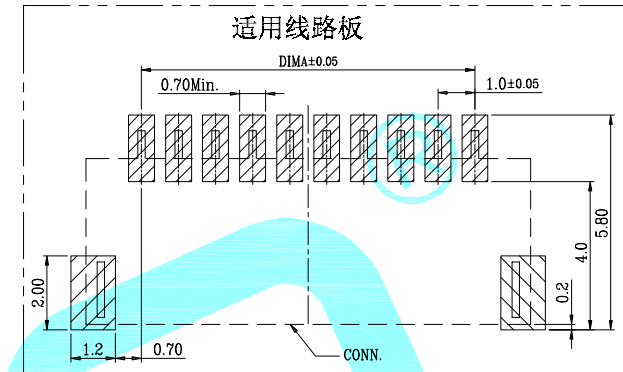
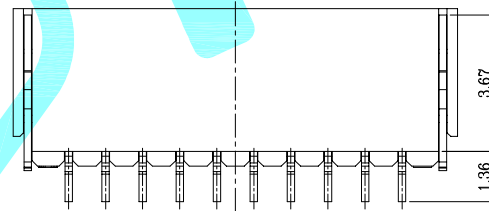
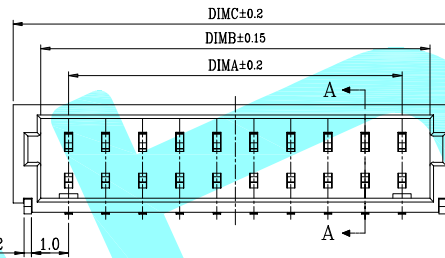
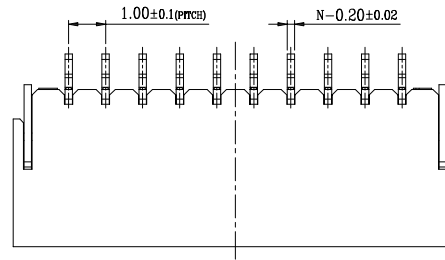
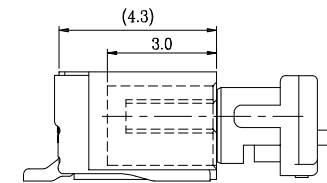

MATED CONDITION

■ 技术参数 (SPECIFICATIONS)

- ◆ 额定电压: 50V AC DC  
Voltage rating: 50V AC DC
- ◆ 额定电流: 1.0A AC DC(28AWG)  
Current rating: 1.0A AC DC(28AWG)
- ◆ 耐压值: 500V AC/minute  
Withstand voltage 500V AC/minute
- ◆ 绝缘电阻: 100MΩ MIN,  
Insulation resistance: 100MΩ MIN,
- ◆ 接触电阻: 20mΩ MAX.(初始值)  
Contact resistance: 20mΩ MAX.(Initial)
- ◆ 工作温度: -25°C~+85°C  
Working Temperature: -25°C~+85°C
- ◆ 间距: 1.0 mm  
Pitch: 1.0mm

■ 材料 (MATERIAL)

- ◆ 绝缘体: LCP UL94V-0  
Insulator: LCP UL94V-0
- ◆ 焊片: 磷青铜镀锡  
Solder tab: Phosphor bronze TIN-Plating
- ◆ 接触针: 磷青铜镀锡  
Contact PIN: Phosphor bronze TIN-Plating

APPROVALS		DATE				
DRAWN	LIUCAN	2022.10.9				
CHECKED				PART NO.	1.0T-nP-WT	
APPROVALS				UNIT: mm	SCALE: 1:1	PROJ:
TOLERANCES ARE		30~以上	±0.30	ANGLE	DRAWING NO.	SHEET 1 OF 1
		10~30	±0.20			
		5~10	±0.15			
		~ 5	±0.10			

ECN NO.	REV.	DATE.	DESCRIPTION.	CHANGE.	CHECK.	APPRO.
	A		NEW			