

POLES	P/N	A	B
2	0.8T-2P-WT	0.80	3.80
3	0.8T-3P-WT	1.60	4.60
4	0.8T-4P-WT	2.40	5.40
5	0.8T-5P-WT	3.20	6.20
6	0.8T-6P-WT	4.00	7.00
7	0.8T-7P-WT	4.80	7.80
8	0.8T-8P-WT	5.60	8.60
9	0.8T-9P-WT	6.40	9.40
10	0.8T-10P-WT	7.20	10.20
11	0.8T-11P-WT	8.00	11.00
12	0.8T-12P-WT	8.80	11.80
13	0.8T-13P-WT	9.60	12.60
14	0.8T-14P-WT	10.40	13.40
15	0.8T-15P-WT	11.20	14.20
16	0.8T-16P-WT	12.00	15.00
17	0.8T-17P-WT	12.80	15.80
18	0.8T-18P-WT	13.60	16.60
19	0.8T-19P-WT	14.40	17.40
20	0.8T-20P-WT	15.20	18.20
21	0.8T-21P-WT	16.00	19.00
22	0.8T-22P-WT	16.80	19.80
23	0.8T-23P-WT	17.60	20.60
24	0.8T-24P-WT	18.40	21.40
25	0.8T-25P-WT	19.20	22.20
26	0.8T-26P-WT	20.00	23.00
27	0.8T-27P-WT	20.80	23.80
28	0.8T-28P-WT	21.60	24.60

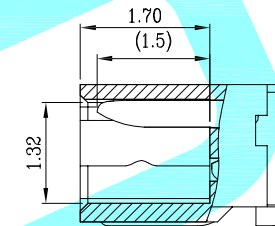

SECTION A-A

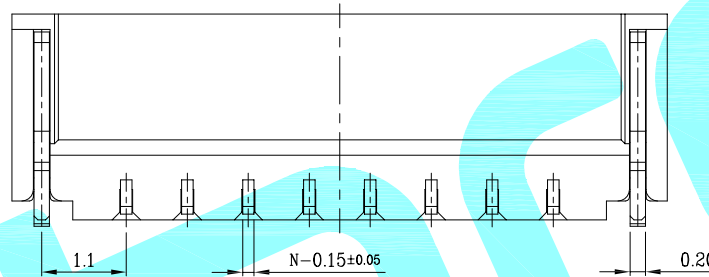
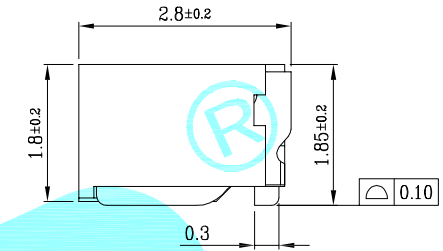
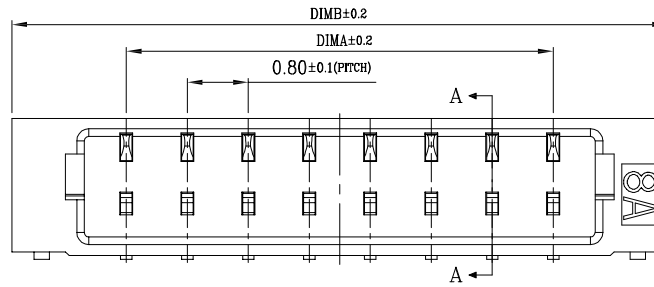
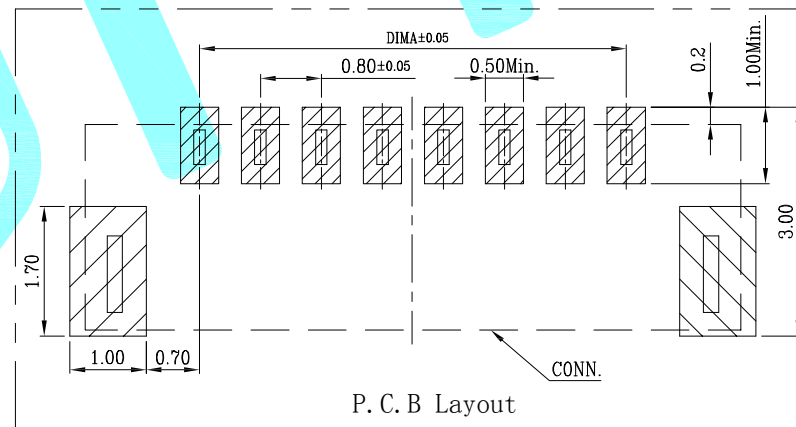

P. C. B Layout

■ 技术参数 (SPECIFICATIONS)

- ◆ 额定电压: 30V AC DC
Voltage rating: 30V AC DC
- ◆ 额定电流: 0.5A AC DC(28AWG)
Current rating: 0.5A AC DC(28AWG)
- ◆ 耐压值: 200V AC/minute
Withstand voltage: 200V AC/minute
- ◆ 绝缘电阻: 100MΩ MIN.
Insulation resistance: 100MΩ MIN.
- ◆ 接触电阻: 20mΩ MAX.(初始值)
Contact resistance: 20mΩ MAX.(Initial)
- ◆ 工作温度: -25°C~+85°C
Working Temperature: -25°C~+85°C
- ◆ 间距: 0.8 mm
Pitch: 0.8mm

■ 材料 (MATERIAL)

- ◆ 绝缘体: LCP UL94V-0
Insulator: LCP UL94V-0
- ◆ 焊片: 磷青铜镀锡
Solder tab: Phosphor bronze TIN-Plating
- ◆ 接触针: 磷青铜镀锡
Contact PIN: Phosphor bronze TIN-Plating

APPROVALS		DATE														
DRAWN	LIUCAN	2023.8.11				TITLE:	Bar Connector Series									
CHECKED			PART NO.	0.8T-nP-WT												
APPROVALS			TOLERANCES ARE	<table border="1"> <tr><td>30~以上</td><td>±0.30</td></tr> <tr><td>10~30</td><td>±0.20</td></tr> <tr><td>5~10</td><td>±0.15</td></tr> <tr><td>~ 5</td><td>±0.10</td></tr> </table>	30~以上	±0.30	10~30	±0.20	5~10	±0.15	~ 5	±0.10	ANGLE	UNIT: mm	SCALE: 1:1	PROJ:
30~以上	±0.30															
10~30	±0.20															
5~10	±0.15															
~ 5	±0.10															
ECN NO.	REV.	DATE.	DESCRIPTION.	CHANGE.	CHECK.	APPRO.	DRAWING NO.		SHEET 1 OF 1							

ECN NO.	REV.	DATE.	DESCRIPTION.	CHANGE.	CHECK.	APPRO.
	A		NEW			