

| REVISIONS | | | | | |
|-----------|-----|---------------------------|-----------|-----|------|
| P | LTR | DESCRIPTION | DATE | DWN | APVD |
| | C2 | REVISED PER ECR-23-181704 | 22NOV2023 | MV | JP |

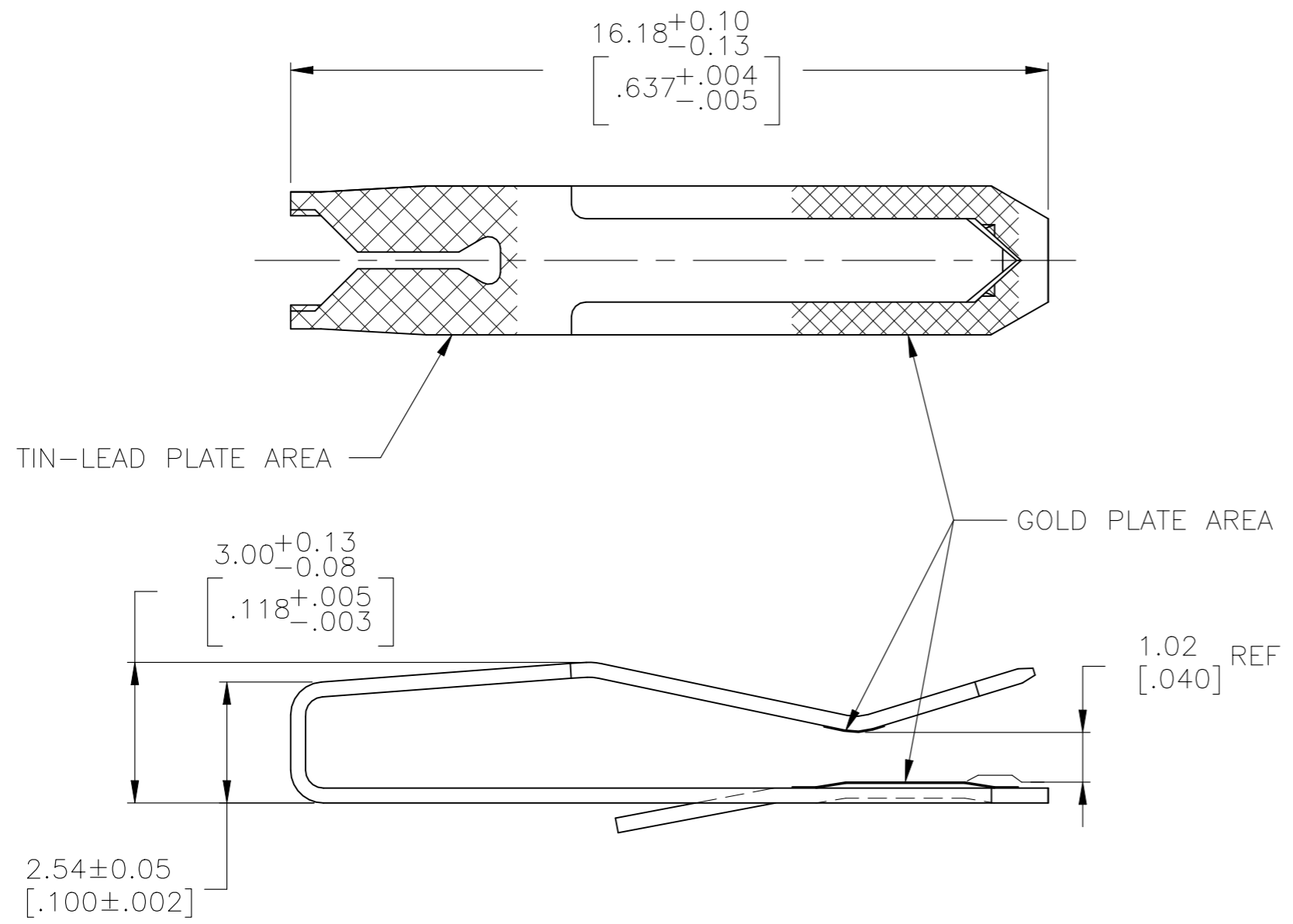

- DIMENSIONS IN BRACKETS ARE IN INCHES.
- $\triangle 2$ 0.00038 [.000015] MIN THICK GOLD IN THE GOLD PLATE AREA OVER 0.00127 [.000050] MIN THICK NICKEL.
- $\triangle 3$ 0.00076 [.000030] MIN THICK GOLD IN THE GOLD PLATE AREA OVER 0.00127 [.000050] MIN THICK NICKEL.
- $\triangle 4$ 0.00203 [.000080] MIN THICK TIN-LEAD IN THE TIN-LEAD PLATE AREA OVER 0.00127 [.000050] MIN THICK NICKEL.
- $\triangle 5$ MATTE TIN 0.00203(.000080) MIN THICK IN TIN PLATED AREA
- $\triangle 6$ OBSOLETE PARTS: OBSOLETE CIS STREAMLINING PER D.RENAUD/D.SINISI

| | | |
|---------------|-----------------------------|----------|
| | $\triangle 3$ $\triangle 5$ | 641146-4 |
| | $\triangle 2$ $\triangle 5$ | 641146-3 |
| $\triangle 6$ | $\triangle 3$ $\triangle 4$ | 641146-2 |
| $\triangle 6$ | $\triangle 2$ $\triangle 4$ | 641146-1 |
| | FINISH | PART NO |

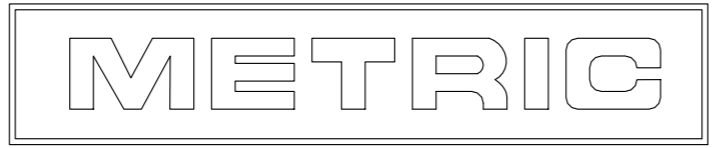

| | | | | | | | |
|---|--|-------------------------|---|-----------|-----------------|---------------------|---------------|
| THIS DRAWING IS A CONTROLLED DOCUMENT. | | DWN BSV 25OCT2005 | TE Connectivity | | | | |
| DIMENSIONS: mm [INCHES] | | CHK D. BOSSI 25OCT2005 | | | | | |
| TOLERANCES UNLESS OTHERWISE SPECIFIED: | | APVD D. BOSSI 25OCT2005 | NAME | | | | |
| 0 PLC ± - 1 PLC ± - 2 PLC ± - 3 PLC ± 0.13 [.005] 4 PLC ± - ANGLES ± - | | PRODUCT SPEC | CONTACT, GOLD STRIPE, 24 AWG WIRE, LOOSE PIECE, MTA 156 | | | | |
| MATERIAL 0.30 [.012] THK COPPER ALLOY | | FINISH SEE TABLE | APPLICATION SPEC | SIZE A3 | CAGE CODE 00779 | DRAWING NO C-641146 | RESTRICTED TO |
| CUSTOMER DRAWING | | | WEIGHT - | SCALE 8:1 | SHEET 1 OF 1 | REV C2 | |