

PROPERTY OF DEUTSCH E.C.D.

This drawing contains proprietary information that shall not be disclosed, duplicated, nor used in whole or in part for any purpose other than to evaluate this drawing.

A 2560-202-20**

(A2)

REVISIONS			
REV	DESCRIPTION	DATE	APPROVED
N/C	NEW RELEASE PER E.O. C4790		
A	REVISED PER E.O. C8274	110629	J.P.F.

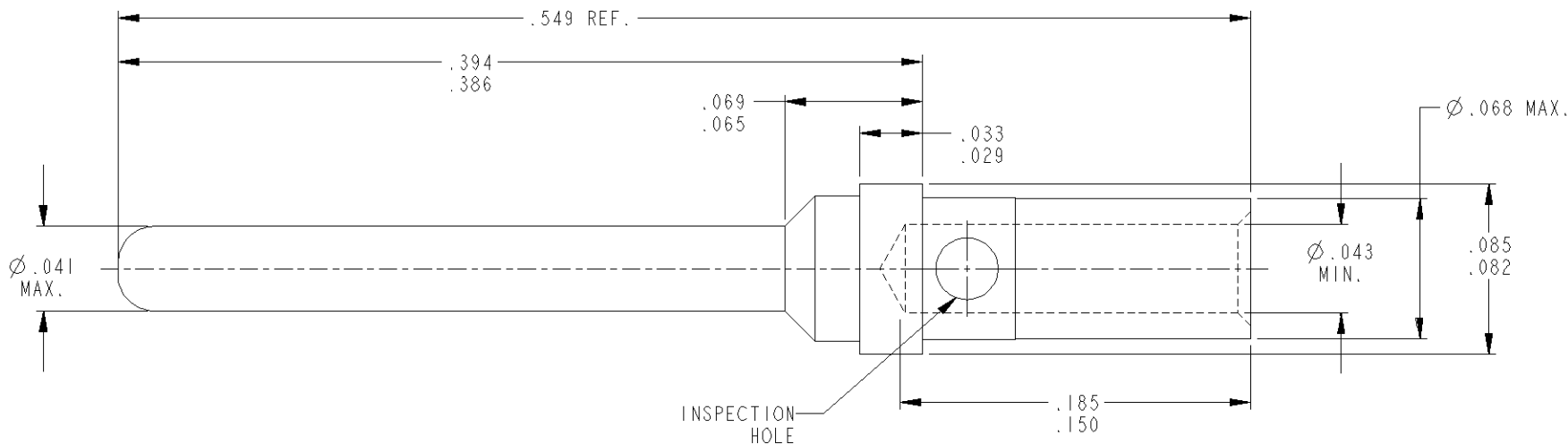

4. CRIMP TOOL: DANIELS AFM8.
POSITIONER: DANIELS K13-1.
RECOMMENDED STRIP LENGTH 5/32 TO 3/16.
3. FINISH: SEE TABLE
2. MATERIAL: COPPER ALLOY
1. DIMENSIONS ARE INCHES UNLESS OTHERWISE SPECIFIED.

NOTES:

(A1)

**	PLATING
90	DEUTSCH COAT
91 OR 31L	GOLD OVER NICKEL LOCALIZED FINISH
31	GOLD OVER NICKEL

SIGNATURE & DATE	
DR	N. KELLY 1-09-01
CHK	J.P.F. 110629
PE	R.C. 110629
APPD	A.R. 110629
SCALE	WT NONE

CONTACT, PIN

CRIMP TYPE
REAR RELEASE
SIZE 20

ENVELOPE

CP --- MATL CODE ---

DEUTSCH
ENGINEERED CONNECTING DEVICES
250 EDDIE JONES WAY
OCEANSIDE, CA 92058

A	2560-202-20**		
	DWG SIZE	CODE 11139	SHEET OF