

SPECIFICATIONS

- 1、Current Rating: 3A AC, DC
- 2、Voltage Rating: 250V AC, DC
- 3、Temperature Range: -25°C~ +85°C
- 4、Contact Resistance: 20mΩ Max
- 5、Insulation Resistance: 1000mΩ Min
- 6、Withstanding Voltage: 1000V AC/minute
- 7、Material: Wafer LCP UL94-VO
Pin Brass Tin-plated

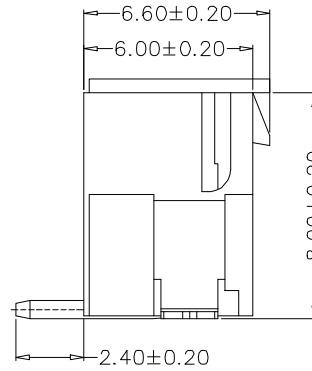

Circuit	Part NO.	Dimensions mm		
		A	B	C
2	XD-HA-2ALT-XX	2.50	10.00	7.50
3	XD-HA-3ALT-XX	5.00	12.50	10.00
4	XD-HA-4ALT-XX	7.50	15.00	12.50
5	XD-HA-5ALT-XX	10.00	17.50	15.00
6	XD-HA-6ALT-XX	12.50	20.00	17.50
7	XD-HA-7ALT-XX	15.00	22.50	20.00
8	XD-HA-8ALT-XX	17.50	25.00	22.50
9	XD-HA-9ALT-XX	20.00	27.50	25.00
10	XD-HA-10ALT-XX	22.50	30.00	27.50
11	XD-HA-11ALT-XX	25.00	32.50	30.00
12	XD-HA-12ALT-XX	27.50	35.00	32.50

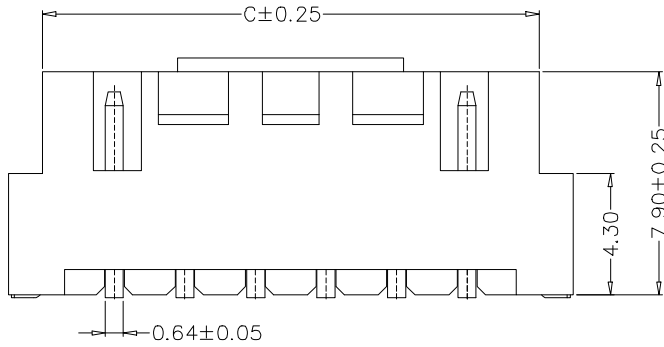
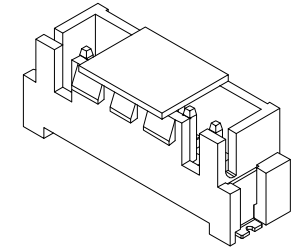
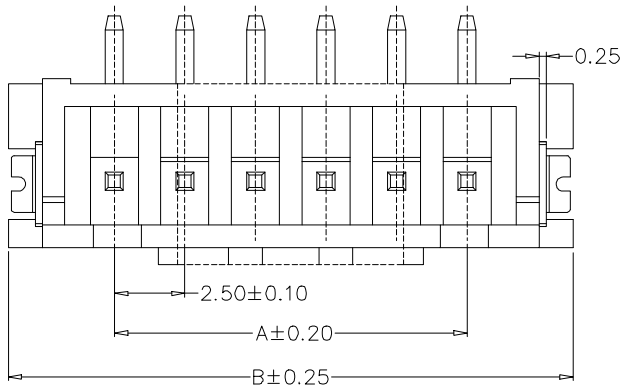

Ordering Information

XD - HA - N *** - **

Pin Type: N=直插, ALT=000公插, AWT=带胶

Contact Plating: 镀层: Tin, G11u/ Gold, G23u/ Gold, G33u/ Gold, G44u/ Gold, G55u/ Gold

			GENERAL TOLERANCE	制图 DRAWING	01	深圳讯答科技有限公司 ShenzhenXunDaTechnology Co.,Ltd			
			DIM TOL	审核 CHECK					产品名称 TITLE
			X.X ±0.30	批准 APPROVAL		产品料号 PART NO.	XD-HA-NALT-XX-XX	单位 UNITS	mm
			X.XX ±0.20	投影 Projection 		材料 MATERIAL		页次 SHEET	1/1
			X.XXX ±0.10						
序号 No.	变更内容 MODIFY CONTENT	日期 MODIFY DATE	Angle ±3.0°						