

Recommended P.C.B Layout(Top Side)
(PCB BOARD TOLERANCE ± 0.05)

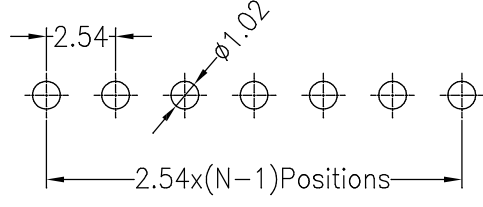

SPECIFICATIONS
 Rated Current: 3.0AMP
 Contact Resistance: 20mΩ Max
 Withstand Voltage: 1000V AC/DC
 Insulation Resistance: 1000MΩ Min
 Operation Temperature: -40°C to +105°C

Contact Material: Brass
 Contact Plating: Au Over Ni
 Insulator Material: Polyester(UL94V-0)
 Standard: PA6T
 Max. Processing Temp: 230°C for 30-60 seconds
 (260°C for 10 seconds)

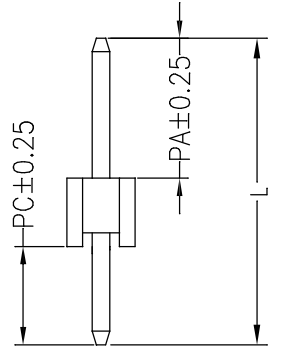
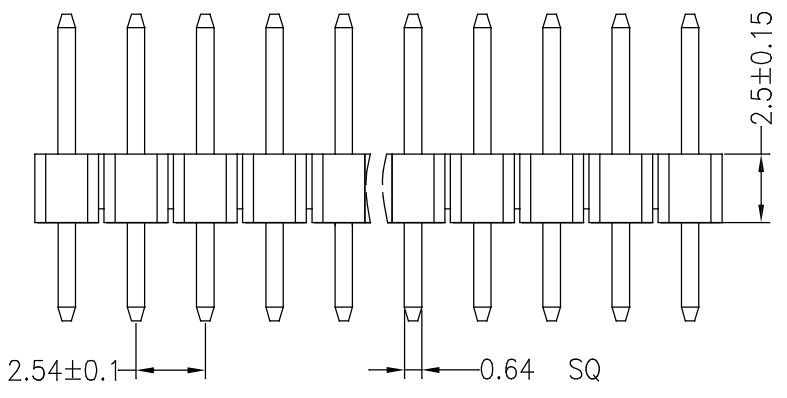

Dimension antitheses list			
ITEM	PA	PC	L
Standard	6.00	3.00	11.50
Alternate			

			GENERAL TOLERANCE	制 图 DRAWING	深圳市华灿天禄电子有限公司 ShenzhenhuacantianluELECTRONICS CO.,LTD			
			DIM TOL	审 核 CHECK				
			X.X ±0.30	批 准 APPROVAL	产 品 名 称 TITLE	2.54单排 直插式(间距2.5)	原 本 REV.	A
			X.XX ±0.20	比 例 SCALE	产 品 料 号 PART NO.	PZ254-1-N-Z-8.5	单 位 UNITS	mm
			X.XXX ±0.10	投 影 Projection	材 料 MATERIAL		页 次 SHEET	1/1
序 号 No.	变 更 内 容 MODIFY CONTENT	日 期 MODIFY DATE	Angle ±3.0°					