

REVISIONS				
REV	ECO	DESCRIPTION	DATE	BY APPR
B1	-	RELEASE NEW DWG FORMAT	May:10,2014	Drack Tommy
B2	-	UPDATE THE DURABILITY	Jun:27,2015	Drack Tommy
B3	-	UPDATED NUT	Dec:02,2015	Flan Tommy

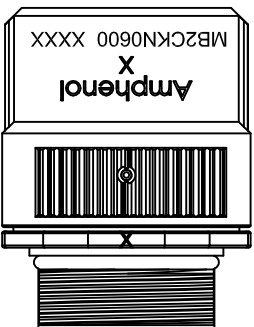
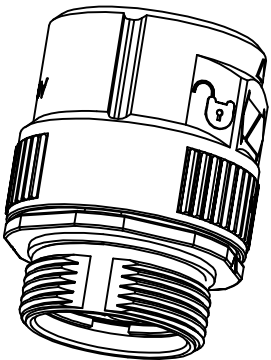
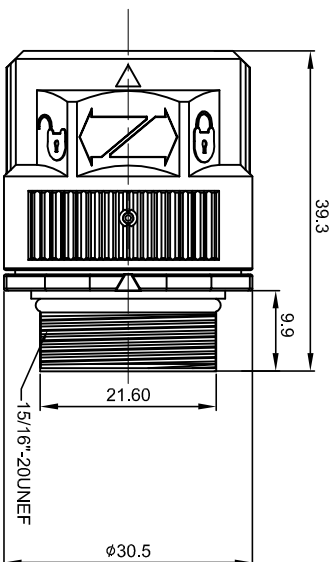
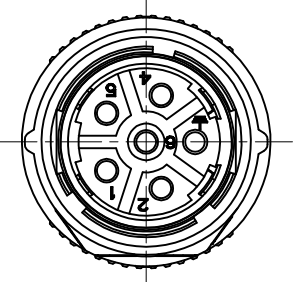

NOTES: UNLESS OTHERWISE SPECIFIED

- MATERIAL:
INSULATION INSERT: PA66,UL94 V0
SEAL: VITON
HOUSING BODY: ZINC DIE CAST, NICKEL PLATED
COUPLING NUT: ZINC DIE CAST, NICKEL PLATED
- SPECIFICATIONS:
2.1 CURRENT RATING: 28 AMPS
2.2 VOLTAGE RATING: 630V AC/DC
2.3 OPERATING TEMPERATURE: -20°C TO +130°C
2.4 DIELECTRIC WITHSTANDING VOLTAGE: LESS THAN 2 MILLIAMPS CURRENT LEAKAGE @ 6000 VOLTS AC.
2.5 DEGREE OF PROTECTION: IP67 (MATED CONDITION)
2.6 DEGREE OF POLLUTION: 3 PER UL840
2.7 OVERVOLTAGE CATEGORY: III PER UL840
2.8 MATING CYCLE DURABILITY: >500 CYCLES
2.9 ROHS COMPLIANT
- ALL DIMENSIONS ARE FOR REFERENCE USE ONLY.

QUANTITY	SEE PART NUMBER CHART	PART NUMBER	DESCRIPTION	ITEM	
MATERIALS LIST					
UNLESS OTHERWISE SPECIFIED					
1) All dimensions are in millimeters.					
2) Tolerances are as follows:					
1 Pt. DEC >0.30 Fractions .1" <1/4					
3 Pt. DEC >0.08 Angles .1°					
3) Note reference =					
MATERIAL SPECIFICATIONS:					
PROCESS SPECIFICATIONS:					
NEXT ASSY:					
SIGNATURES		DATE			
DRAWN: Flan	DATE: 06/12/15				
CREATED:	ENGINEER:				
APPROVAL:	CUSTOMER:				
THIS DRAWING IS SUPPLIED FOR INFORMATION ONLY. IT IS NOT TO BE USED FOR SPECIFICATIONS AND PERFORMANCE DATA. THE MANUFACTURER ASSUMES NO RESPONSIBILITY FOR REPRODUCTION ERRORS OR MANUFACTURING VARIATIONS.		SIZE: B	TYPE: C-	DWG NO: MB2CKN0600	REVISION: B3
M23B, PLUG, STR.6POS,CHECKMATE		SCALE: NONE	SHEET: 1	OF: 1	

Amphenol

Site Systems - www.amphenol-site.com
44724 Morley Drive
Clinton Township, MI 48036

CHECKMATE

TITLE:

M23B, PLUG, STR.6POS,CHECKMATE

DWG NO:

MB2CKN0600

REV: B3

SH: 1

OF: 1