

P.C.B LAYOUT
TOLERANCE:±0.05

Ordering Information:

A2543WVA-XP-WH - **
1 2

1.Part NO.

2.Pin Finish:

(Blank): Tin over Nickel

G: Gold over Nickel

G10: Gold over Nickel (Au:10u"Mating Area)

G15: Gold over Nickel (Au:15u"Mating Area)

G20: Gold over Nickel (Au:20u"Mating area)

G30: Gold over Nickel (Au:30u"Mating area)

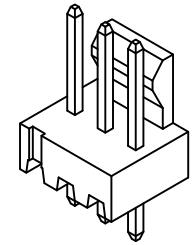
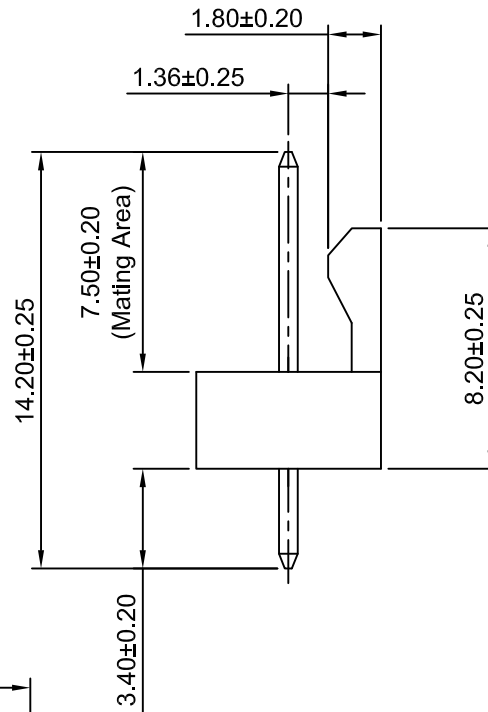

SPECIFICATIONS:

Current Rating: 4A AC,DC

Voltage Rating: 250V AC,DC

Temperature Range: -40°C ~ +105°C

Contact Resistance: 10mΩ Max

Insulation Resistance: 1000MΩ Min

Withstanding Voltage: 1000V AC/minute

Pin Material:Brass

Material: Nylon 66,UL94V-0 (White)

Ordering Information & Dimensions

Circuits	Dimensions(mm)		Circuits	Dimensions(mm)	
	A	B		A	B
2P	2.54	5.08	15P	35.56	38.10
3P	5.08	7.62	16P	38.10	40.64
4P	7.62	10.16	17P	40.64	43.18
5P	10.16	12.70	18P	43.18	45.72
6P	12.70	15.24	19P	45.72	48.26
7P	15.24	17.78	20P	48.26	50.80
8P	17.78	20.32	21P	50.80	53.34
9P	20.32	22.86	22P	53.34	55.88
10P	22.86	25.40	23P	55.88	58.42
11P	25.40	27.94	24P	58.42	60.96
12P	27.94	30.48	25P	60.96	63.50
13P	30.48	33.02	26P	63.50	66.04
14P	33.02	35.56	27P	66.04	68.58



CHANGJIANG CONNECTORS CO.,LTD.

A5	CHANGE THE DRAWING	2023.02.06
A4	CHANGE THE DRAWING	2022.02.17
A3	ADD THE SIZE	2020.12.17
A2	CHANGE THE INFORMATION	2020.08.17
A1	CHANGE THE SIZE	2020.01.06
A0	NEW RELEASE	2005.05.10
REV	DESCRIPTION	DATE

Unit	Scale	Sheet
mm	4:1	1 of 1
DRAWN	CHK'D	APPR
Haisen Li	Diankui Wan	Jack Yin
General Tolerances		THIRD ANGLE PROJECTION
x.x±0.25		
x.xx±0.20		
x.xxx±0.15		
ANGLES ±1°		

TITLE	
2.54mm PITCH VERTICAL WAFER	
DRAWING NO.	
A2543WVA-XP-WH	
REV	A5