

# PNI CONNECTOR <High box type>

2.0 mm pitch/Wire-to-Board connectors/Crimp style and Mating style

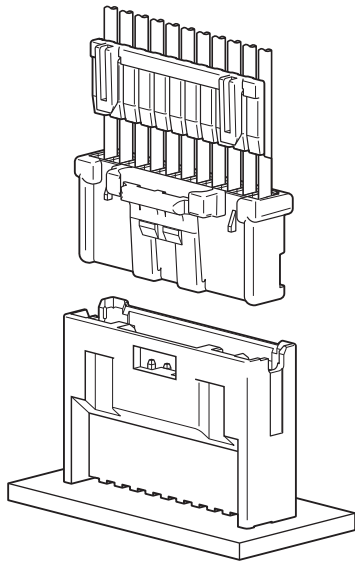

This is a board-to-wire connector with secure locking device that has been designed to 2 mm pitch high box type, with a mounting height of 19.95 mm (including retainer) and 6.65 mm in depth.

Low insertion force type contact is adopted and it provides excellent operability.

Retainer is available as usage.

- Header suitable for potting process
- Secure lock mechanism
- Retainer mountable type

## Standards

☑ :Recognized E 60389

## Specifications

- Current rating: 3 A AC/DC (AWG #22)
  - Voltage rating: 100 V AC/DC
  - Temperature range: -25°C to +85°C  
(including temperature rise in applying electrical current)
  - Contact resistance:
    - Initial value/ 10 mΩ max.
    - After environmental tests/ 20 mΩ max.
  - Insulation resistance: 1,000 MΩ min.
  - Withstanding voltage:
    - There shall be no breakdown or flashover while applying 800 VAC for one minute.
  - Applicable wire range:
    - Conductor size/ AWG #28 to AWG #22
    - Insulation O.D./  $\phi$  0.76 mm to  $\phi$  1.5 mm
  - Applicable PC board thickness: 1.6 mm
- \* In using the products, refer to "Handling Precautions for Terminals and Connectors" described on our website (Technical documents of Product information page).
- \* RoHS2 compliance
- \* Dimensional unit: mm
- \* Contact JST for details.

## PC board layout and Assembly layout

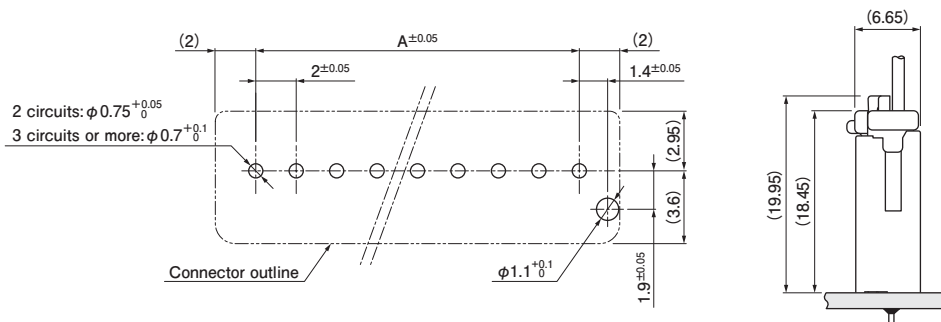

- Note: 1. The figure of PC board layout is the figure viewed from the connector mounting side.  
 2. Dimension A: See "Header" section on page 3.  
 3. Tolerance for the PCB hole pitch shall be  $\pm 0.05$ , and shall not accumulate more than  $\pm 0.05$ .  
 4. Hole dimensions differ according to the type of PC board and piercing method.  
 The above dimensions are reference values. Please contact JST for details.

# PNI CONNECTOR (High box type)

## Contact

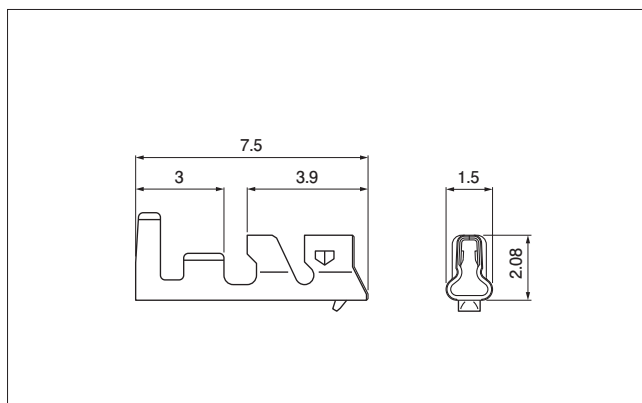

Model No.	Applicable wire range		Q'ty/ reel	
	Conductor size	AWG (mm <sup>2</sup> )		Insulation O.D. (mm)
SPND-002T-C0.5	#28 to #24	(0.08 to 0.22)	0.76 to 1.5	8,000
SPND-001T-C0.5	#26 to #22	(0.13 to 0.33)	1.0 to 1.5	

Material and Surface finish, etc.

Copper alloy, tin-plated

## Crimping machine

Contact	Crimping machine	Applicator	Crimp applicator with dies
SPND-002T-C0.5	AP-K2N	MKS-L	APLMK SPAD/ND002-05
SPND-001T-C0.5			APLMK SPND001-05

Note: Contact JST for fully automatic crimping applicator.

## Socket housing

<2 circuits>

<3, 4 circuits>

<5 circuits>

<6 to 10 circuits>

<11 to 15 circuits>

No. of circuits	Model No.	Dimensions (mm)		Q'ty/bag
		A	B	
2	PNIRP-02V-S	—	5.7	1,000
3	PNIRP-03V-S	4.0	7.7	1,000
4	PNIRP-04V-S	6.0	9.7	1,000
5	PNIRP-05V-S	8.0	11.7	1,000
6	PNIRP-06V-S	10.0	13.7	1,000
7	PNIRP-07V-S	12.0	15.7	1,000
8	PNIRP-08V-S	14.0	17.7	1,000
9	PNIRP-09V-S	16.0	19.7	1,000
10	PNIRP-10V-S	18.0	21.7	1,000
11	PNIRP-11V-S	20.0	23.7	1,000
12	PNIRP-12V-S	22.0	25.7	1,000
13	PNIRP-13V-S	24.0	27.7	1,000
14	PNIRP-14V-S	26.0	29.7	500
15	PNIRP-15V-S	28.0	31.7	500

Material and Surface finish, etc.

PBT (Glass-filled), UL94V-0, natural

# PNI CONNECTOR (High box type)

## Header

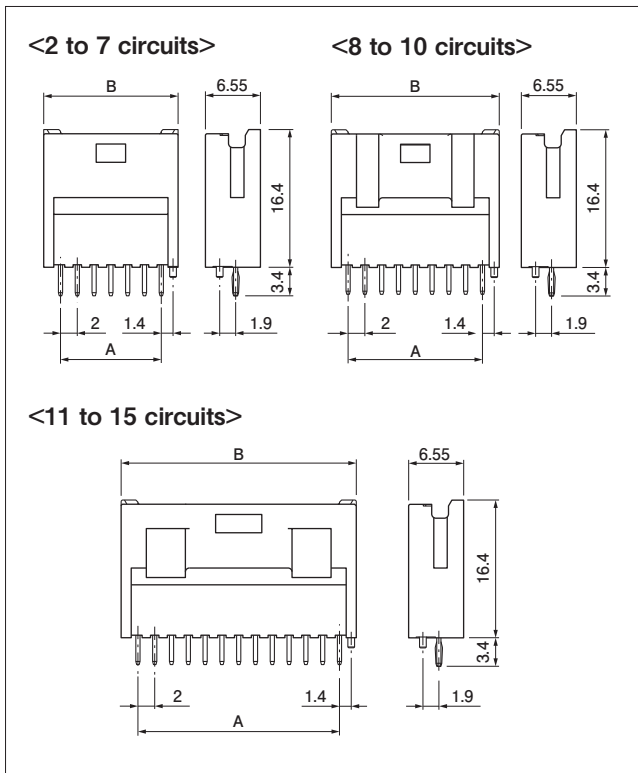

No. of circuits	Model No.	Dimensions (mm)		Q'ty/box
		A	B	
2	BH02B-PNISK-1A	2.0	6.0	500
3	BH03B-PNISK-1A	4.0	8.0	450
4	BH04B-PNISK-1A	6.0	10.0	350
5	BH05B-PNISK-1A	8.0	12.0	300
6	BH06B-PNISK-1A	10.0	14.0	250
7	BH07B-PNISK-1A	12.0	16.0	200
8	BH08B-PNISK-1A	14.0	18.0	200
9	BH09B-PNISK-1A	16.0	20.0	150
10	BH10B-PNISK-1A	18.0	22.0	150
11	BH11B-PNISK-1A	20.0	24.0	150
12	BH12B-PNISK-1A	22.0	26.0	100
13	BH13B-PNISK-1A	24.0	28.0	100
14	BH14B-PNISK-1A	26.0	30.0	100
15	BH15B-PNISK-1A	28.0	32.0	100

Material and Surface finish, etc.

Post: Copper alloy, copper-undercoated, tin-plated  
Wafer: PA 66 (Glass-filled), UL94V-0, natural

Note: This product displays (LF) (SN) on a label.

## Retainer

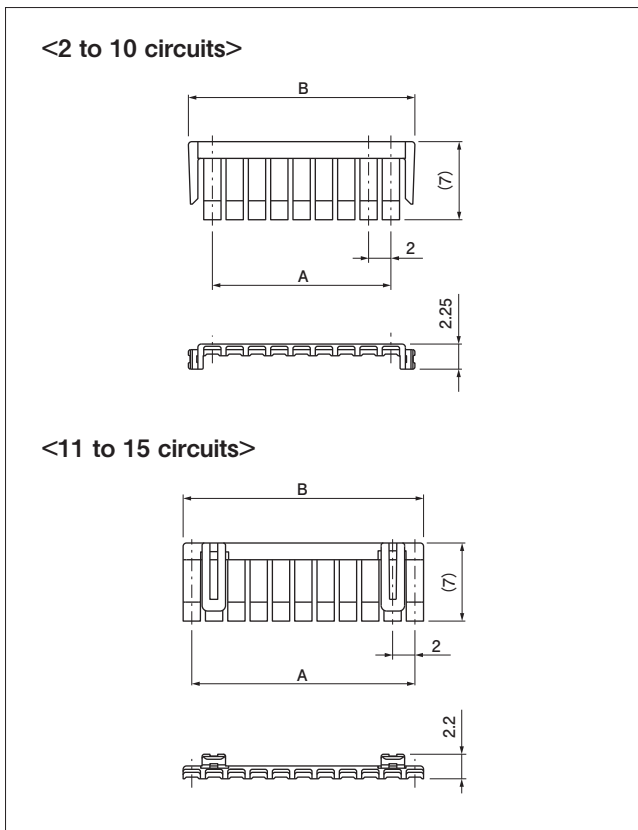

No. of circuits	Model No.	Dimensions (mm)		Q'ty/bag
		A	B	
2	PNIS-02V	2.0	6.3	1,000
3	PNIS-03V	4.0	8.3	1,000
4	PNIS-04V	6.0	10.3	1,000
5	PNIS-05V	8.0	12.3	1,000
6	PNIS-06V	10.0	14.3	1,000
7	PNIS-07V	12.0	16.3	1,000
8	PNIS-08V	14.0	18.3	1,000
9	PNIS-09V	16.0	20.3	1,000
10	PNIS-10V	18.0	22.3	1,000
11	PNIS-11V	20.0	21.55	1,000
12	PNIS-12V	22.0	23.55	1,000
13	PNIS-13V	24.0	25.55	1,000
14	PNIS-14V	26.0	27.55	1,000
15	PNIS-15V	28.0	29.55	1,000

Material and Surface finish, etc.

PA 66 (Glass-filled), UL94V-0, natural

# PNI CONNECTOR (High box type)

## Model number allocation

### Contact

	<b>S</b>	<b>PND - 002</b>	<b>T - C</b>	<b>0.5</b>
Supply form: Strip form				
Series name				
Applicable wire range:				
002...AWG #28 to AWG #24				
001...AWG #26 to AWG #22				
Surface finish: Tin-plated				
Material: Copper alloy				
Applicable post size				

### Socket housing

	<b>PNI</b>	<b>RP - 02</b>	<b>V - S</b>
Series name			
Type: Plug (retainer mountable type)			
No. of circuits			
Flammability: UL94V-0			
Color: Natural			

### Header

	<b>BH</b>	<b>02</b>	<b>B - PNI</b>	<b>S</b>	<b>K - 1</b>	<b>A</b>
Header type: High box type						
No. of circuits						
Assembly product						
Series name						
Color: Natural						
Clinched (Kinked)/ Not clinched: Clinched						
Presence of boss: With boss						
Material: PA 66 (Glass-filled)						

### Retainer

	<b>PNI</b>	<b>S - 02</b>	<b>V</b>
Series name			
Type: Retainer			
No. of circuits			
Flammability: UL94V-0			