

REV.	DESCRIPTION OF REVISIONS	APPR.	CHKD.	DRAW.	DATE
△	NEW			Zoey	2008/12/20
△	Original Model M015-3A			HUABO	2023/12/14

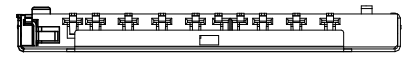

SD CARD PIN DESIGN			
Pin#	Name	Type	Card Detect/Date Line[Bit3]
1	CD/DAT3	I/D/PP	Command/Response
2	CMD	PP	Supply voltage
3	Vss1	S	Supply voltage ground
4	VDD	S	Supply voltage
5	CLK	I	Clock
6	Vss2	S	Supply voltage ground
7	DAT0	I/D/PP	Date Line [Bit0]
8	DAT1	I/D/PP	Date Line [Bit1]
9	DAT2	I/D/PP	Date Line [Bit2]

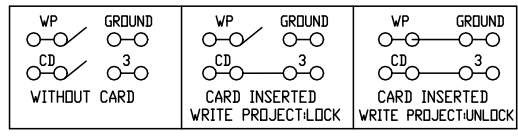
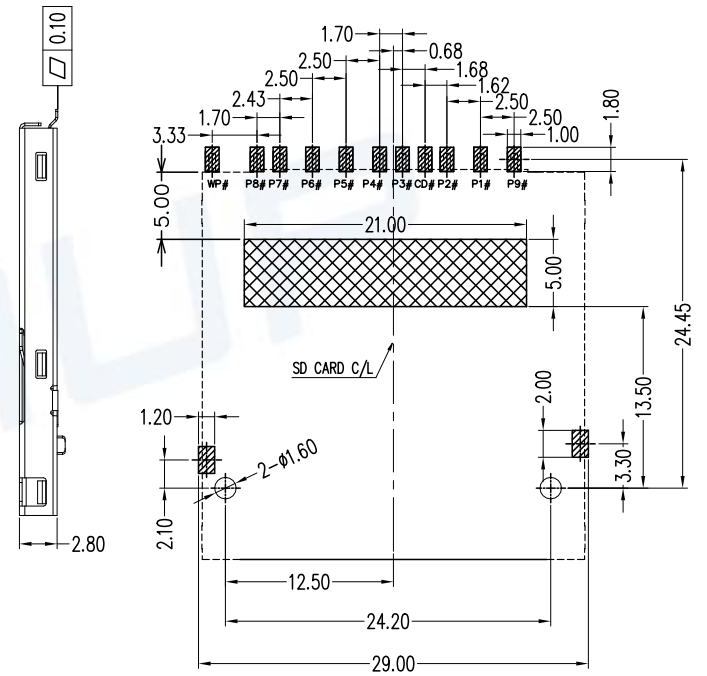
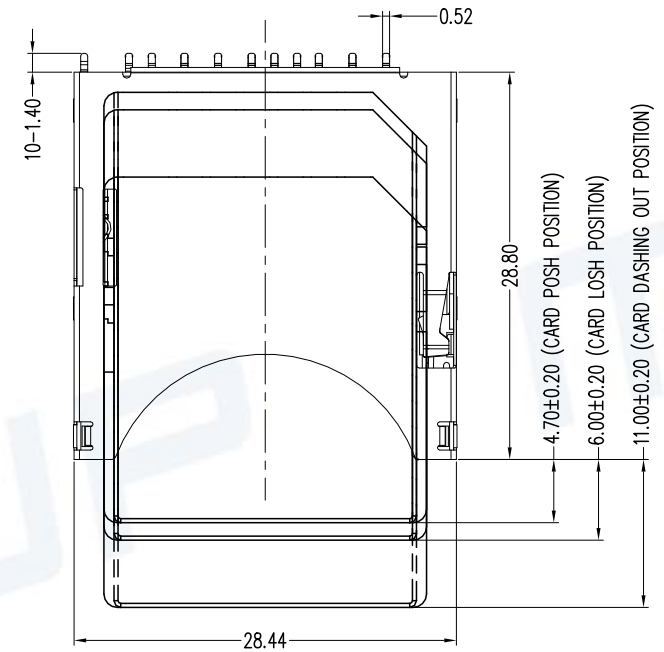
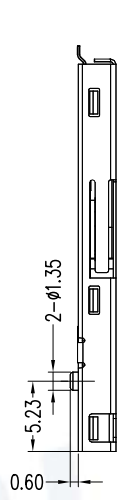

▨ Pad Area; ▩ Keep Out Area

PCB LAYOUT TOP VIEW
(TOLERANCE: ±0.05)

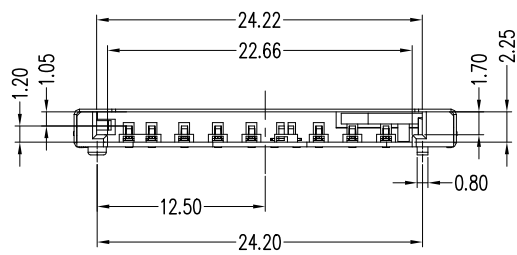

- NOTES:
- MATERIAL:
 - BASE: LCP UL 94V-0, BLACK COLOR
 - CONTACT: COPPER ALLOY.
 - SHELL: STEEL.
 - SPRING: SWP.
 - FINISH:

CONTACTS: GOLD PLATED ON CONTACT AREA, MATTE-TIN ON SOLDER TAIL, NICKEL UNDERPLATED OVERALL.
SHELL: NICKEL PLATED.

- SPECIFICATION
 - *ELECTRICAL CHARACTERISTICS:
 - CONTACT CURRENT RATING: 0.5 AMPERES.
 - DIELECTRIC WITHSTANDING VOLTAGE: AC500V R.M.S.
 - INSULATION RESISTANCE: 1000 MΩ MINIMUM.
 - CONTACT RESISTANCE: 100 mΩ MAXIMUM.
 - *ENVIRONMENTAL:
 - OPERATING TEMPERATURE: -25°C~+85°C.
 - *ENVIRONMENTAL:
 - MATING CYCLES: 5,000 INSERTIONS.

Unless otherwise specified, other tolerance are:		MUP [®] MUP INDUSTRIAL CO.,LTD.			
X ±0.40	X* ±5*	NAME: SD CARD CONNECTOR			
X.X ±0.30	X.X* ±4*	MODEL NO: MUP-M6005-03			
X.XX ±0.20	X.XX* ±3*	TYPE: H2.8 WITH POST			
X.XXX ±0.10	X.XXX* ±2*	DRAWN: Zoey Dec.18.2008 DWG NO.: DWG-M6005-03-01			
PROJ.	UNIT: mm	SCALE: 1:1	CHECKED: Jimmy Dec.20.2008	SHEET: 1/1	
CUSTOMER DRAWING			APPROVAL: Jimmy Dec.20.2008	REVISION: 2	

