

MATERIAL NUMBER	ENG. NO.	MATERIAL NUMBER TAPE MOUNTED	ENG. NO.	STUD SIZE	"S" ±.005	"W" MAX	"C" MIN	"L" MAX
----- B1 -----	-----	-----	-----	04	.119 (3.02)	.322 (8.18)	.285 (7.24)	.885 (22.48)
190730083	BB-837-06	190730084	BB-837-06T	06	.146 (3.71)			
190730085	BB-837-08	190730086	BB-837-08T	08	.173 (4.39)			
190730087	BB-837-10	190730088	B1 BB-837-10T	10	.198 (5.03)	.352 (8.94)	.310 (7.87)	.936 (23.77)
----- B1 -----	-----	-----	B1 -----	06	.146 (3.71)			
190730094	BB-839-08	190730096	BB-839-08T	08	.173 (4.39)			
190730097	BB-839-10	190730099	BB-839-10T	10	.198 (5.03)			

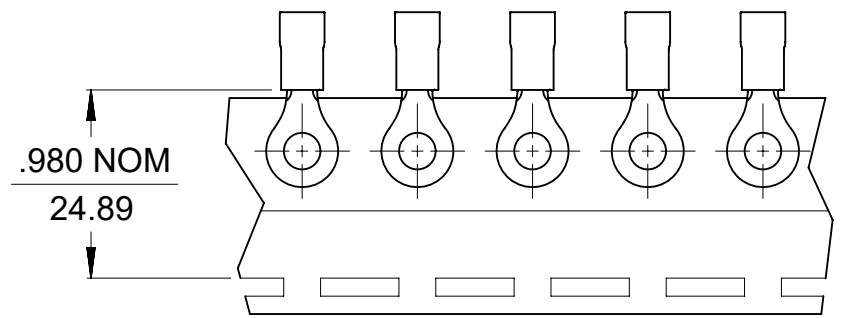
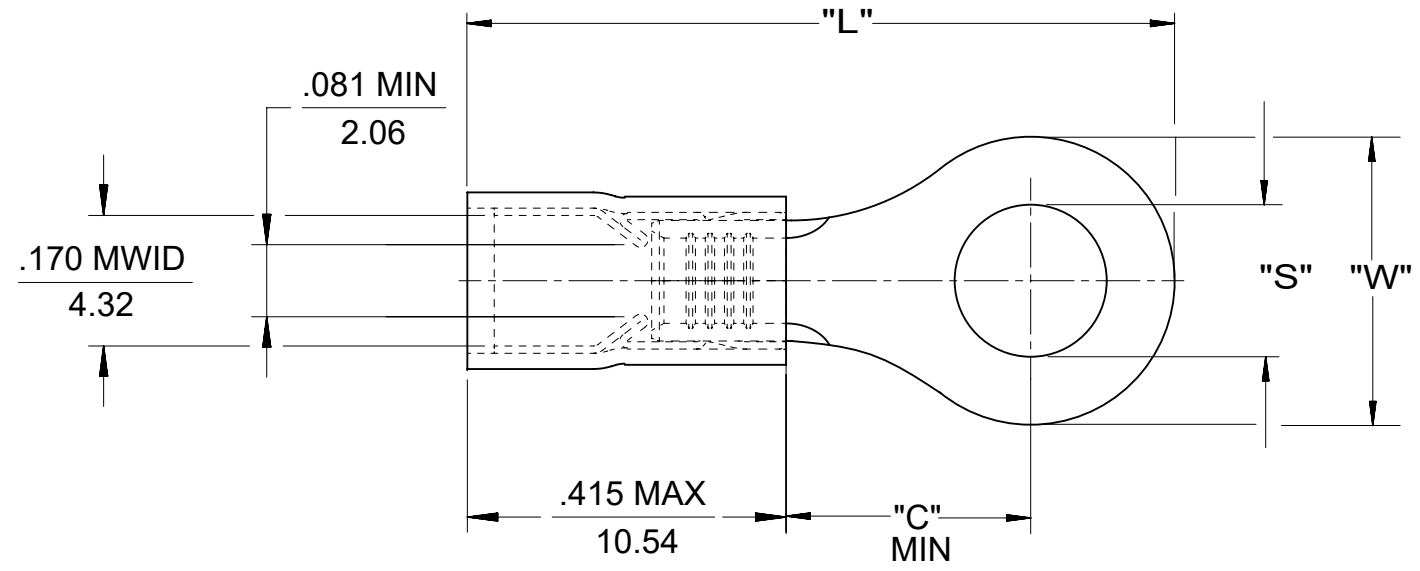

NOTE(S):

- MATERIAL THICKNESS: COPPER .031 (0.79) REF
PLATING: ELECTROPLATE TIN
- FERRULE: TIN-PLATED BRASS
- INSULATION: BLUE NYLON
- MWID = MAXIMUM WIRE INSULATION DIA.
- WIRE SIZE: 16-14 AWG
1.0-2.5 MM²

THIS DRAWING CONTAINS INFORMATION THAT IS PROPRIETARY TO MOLEX ELECTRONIC TECHNOLOGIES, LLC AND SHOULD NOT BE USED WITHOUT WRITTEN PERMISSION									
FUNCTIONAL SYMBOLS	THIS DRAWING CONTAINS INFORMATION THAT IS PROPRIETARY TO MOLEX ELECTRONIC TECHNOLOGIES, LLC AND SHOULD NOT BE USED WITHOUT WRITTEN PERMISSION	SCALE	CURRENT REV DESC: ENG PN ERROR: BB-837-10T WAS BB-823-10T. RMV OBSO PN'S: 190730081, -0302, -0093.						
	INCH/MM	4:1							
DIVISIONAL SYMBOLS	GENERAL TOLERANCES (UNLESS SPECIFIED)								
	4 PLACES	±	MM	INCH					
	3 PLACES	±	±	0.005					
	2 PLACES	±	0.13	±	0.01				
	1 PLACE	±	0.25	±					
0 PLACES	±		±						
ANGULAR TOL		±	1.0°						
DRAFT WHERE APPLICABLE MUST REMAIN WITHIN DIMENSIONS		THIRD ANGLE PROJECTION	DRAWING	SERIES	MATERIAL NUMBER	CUSTOMER	SHEET NUMBER		
			B-SIZE	19073	SEE CHART	GENERAL MARKET	1 OF 1		

molex

RING TONGUE TERMINAL
AVIKRIMP, 800-SERIES 16-14 AWG

PRODUCT CUSTOMER DRAWING

DOCUMENT NUMBER: SD-19073-006
DOC TYPE: PSD
DOC PART: 001
REVISION: B1