



Summary

[Request a quote](#)

[Catalog](#)

Coax	1
Socket / Receptacle	Socket / Receptacle - Fixed Panel Front Mounted
Locking system	Push-pull
Jacket cable outside diameter [mm]	5.90 - 6.50 mm
Matching parts	FFA.1S.250.CTAC66
Series	S - Indoor Stepped Insert

Technical details

Electrical Configuration

Coax	1
Contact Termination Coax	Solder
Insert configuration value	1S.250 - 1 Coax (50 Ohm)
Insulator	T: PTFE
Rated current	12 Amps
Impedance	50 Ohm
VSWR	$1.01 + 0.23 * f/\text{GHz}$
Vtest	3000 V (AC), 4200 V (DC)
Contact Type	Coaxial 50 Ohm (Solder)
Cable type	RG 178 B/U, RG 196 A/U, RG 188 A/U, RG 316 B/U, RG 174 A/U, HF-2114, RG 122 /U
Bucket Dia.	1.4 mm (0.055in)
Contact Dia.	1.6 mm (0.063in)

https://www.lemo.com/int_en/solutions/originals/s-indoor-stepped-insert/psa-1s-250-ctlc66.html

LEMO products and services are provided "as is". LEMO makes no warranties or representations with regard to LEMO product & services or use of them, express, implied or statutory, including for accuracy, completeness, or security. The user is fully responsible for his products and applications using LEMO components.

Form & Material

Shell style / Model id	PSA - Fixed receptacle, nut fixing, cable collet
Socket / Receptacle	Fixed Panel Front Mounted
Housing material	Brass (chrome plated [SAE AMS 2460]) shell and collet nut, nickel plated [SAE AMS QQ N 290] brass latch sleeve and mid pieces
Locking system	Push-pull
Keying	Circular, female

Environment

Technical domain	Audio Video, Energy and Industrial, Semiconductor, Test and Measurement
Environmental protection	IP50
Minimal temperature	-55°C / +250°C
Climatical Category	50/175/21
Humidity (max)	<=95% [at 60 deg C /140 F]
Shielding (min)	75 dB (10 MHz)
Shielding (min)	40 dB (1 GHz)
Shock Resistance	100 g [6 ms]
Vibration	15 g [10 Hz - 2000 Hz]
Salt Spray Corrosion	>144 hr

Cable fixation

Cable termination protection	Standard back nut (no additional protection)
Fixation type	Cable collet
Jacket cable outside diameter [mm]	5.90 - 6.50 mm

Drawings

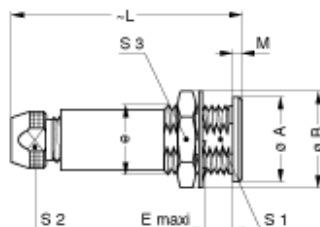

https://www.lemo.com/int_en/solutions/originals/s-indoor-stepped-insert/psa-1s-250-ctlc66.html

LEMO products and services are provided "as is". LEMO makes no warranties or representations with regard to LEMO product & services or use of them, express, implied or statutory, including for accuracy, completeness, or security. The user is fully responsible for his products and applications using LEMO components.

Dimensions

	A	B	e	E	L	M	S1	S2	S3	C
mm.	14	16	M12x1.0	7.5	40.5	1.5	10.5	8.5	14	6.2
in.	0.55	0.63		0.3	1.59	0.06	0.41	0.33	0.55	0.24

Recommended By Lemo





Accessories

Tools

Spanner wrench

[DCD.1S.ZZZ.PA085](#)

Cables

Cable PartNumber	Material	Colour	Cable image
159580	PVC	Black	
62000	PVC	Black	
CCX.50.RG0.58AU61J	PVC	Yellow	
CCX.75.RG0.59BU62N	PVC	Black	
CCX.93.RG0.62AU62N	PVC	Black	

https://www.lemo.com/int_en/solutions/originals/s-indoor-stepped-insert/psa-1s-250-ctlc66.html

LEMO products and services are provided "as is". LEMO makes no warranties or representations with regard to LEMO product & services or use of them, express, implied or statutory, including for accuracy, completeness, or security. The user is fully responsible for his products and applications using LEMO components.