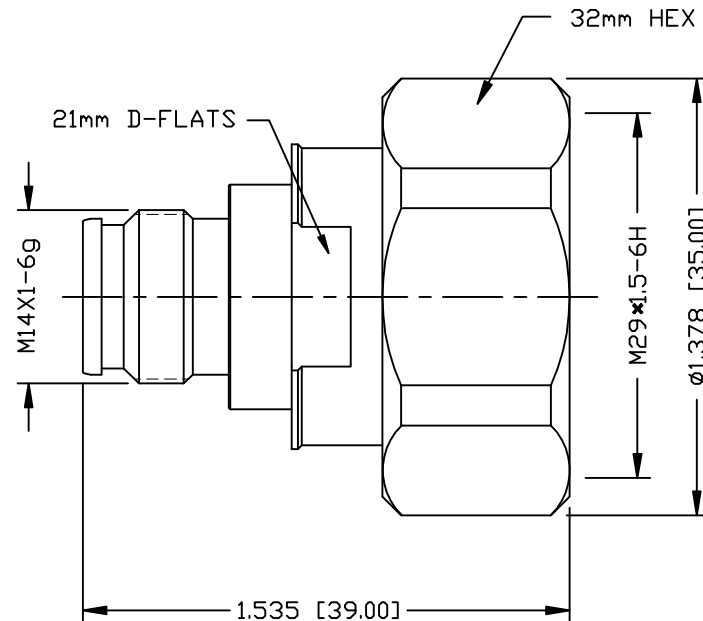

PART NO.

**RFD-225F-716M**

REV	DESCRIPTION	DWN	DATE	APPROVED
-	ENGINEERING RELEASE	CZS	07/17/20	JDMc
A	CHANGED GENERAL SPECIFICATIONS	DM	10/2/20	JDMc

**SPECIFICATIONS:**

INTERFACE: IEC61169-4/66

IMPEDANCE: 50 Ohms

FREQUENCY RANGE: 0-6 GHz

RETURN LOSS TYPICAL RESULTS:

0-3 GHz 30 dB

3-6 GHz 26 dB

3rd ORDER IM:  $\leq -165$  dBc @ 700 MHz & 1900 MHz

3rd ORDER IM TEST METHOD: 2x43 dBm CARRIERS

INSULATION RESISTANCE: 5000 M $\Omega$ 

TEMPERATURE RANGE: -40°C TO 100°C

DURABILITY: &gt;500 (7/16); &gt;100 (2.2/5) MATING CYCLES

MATING TORQUE: 25 Nm (7/16)

COMPLIANCE/CERTIFICATIONS: RoHS / IP68 MATED

NET WEIGHT: 0.205 lb

NOTE:

CONNECTOR WILL HAVE PROTECTIVE CAPS ON (NOT SHOWN)

7	PROTECTIVE CAP	2	PE	WHITE
6	GASKET	1	SI RUBBER	RED
5	RETAINING RING	1	SST	PASSIVATED
4	GROUND RING	1	PHOSPHOR BRONZE	CuSnZn ALLOY
3	CONTACT PIN	1	PHOSPHOR BRONZE	SILVER
2	INSULATOR	1	PTFE	---
1	BODY	1	BRASS	CuSnZn ALLOY
#	DESCRIPTION	QTY	MATERIAL	FINISH/COLOR

CUSTOMER  
OUTLINE DRAWINGALL DIMENSIONS  
ARE REFERENCE ONLYUNLESS OTHERWISE SPECIFIED:  
DIMENSIONS ARE IN INCHES  
AND [MILLIMETERS]

DRAWN	D. McREYNOLDS	10/2/20
CHECKED		
ORJ DRAWN	C. ZUÑIGA	07/17/20

PROPRIETARY AND CONFIDENTIAL

THIS DRAWING CONTAINS INFORMATION PROPRIETARY TO RF INDUSTRIES. ANY UNAUTHORIZED USE OF THIS DRAWING IS EXPRESSLY PROHIBITED WITHOUT WRITTEN PERMISSION FROM RF INDUSTRIES. ANY VIOLATION IS PUNISHABLE UNDER U.S. COPYRIGHT LAWS.

**RFconnectors**  
DIVISION OF RF INDUSTRIES, LTD.

RFINDUSTRIES.COM  
7610 MIRAMAR RD.  
SAN DIEGO, CA 92126  
(858) 549-6340  
(858) 549-6345 FAX

**2.2/5 FEMALE TO  
7/16 DIN MALE ADAPTER**

CABLE GROUP	DWG #	REVISION
N/A	<b>RFD-225F-716M</b>	A
FORMAT	SCALE	CONTROL #
A	NTS	000000
SHEET 1 OF 1		