



Electrical Specifications

Cutoff Frequency (Fc): 76 MHz
Passband: 76-1000 MHz
Passband Insertion Loss: 1dB Max.
Return Loss: 15dB Min.
Rejection: 28 dB @ 13.56 MHz
Power Handling: 5 Watts.

Mechanical

Connector Type: SMA(F)
Dimensions: 1" x 0.5" x 0.4"

Environmental

Operating Temperature: -25°C to +70°C
Storage Temperature: -40°C to +90°C
Shock: 10 G. 11ms
Vibration: 10 G. 5 to 200Hz

Outline Drawing:

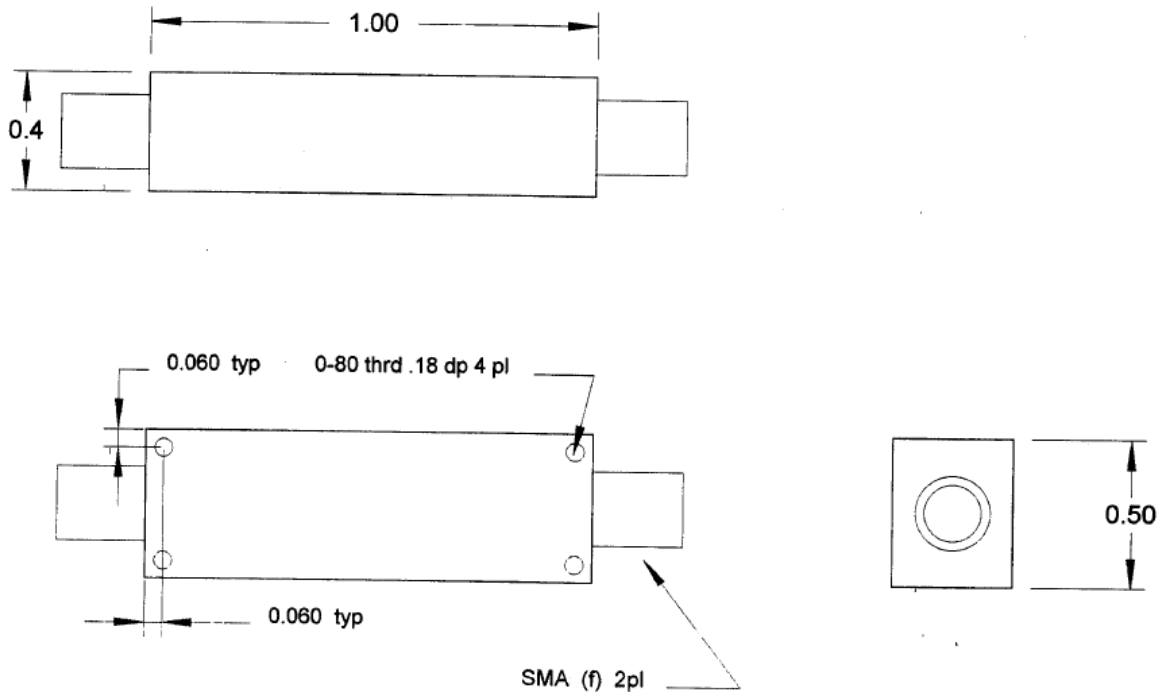



Response Plot:

