

1

2

3

4

5

6

7

A

A

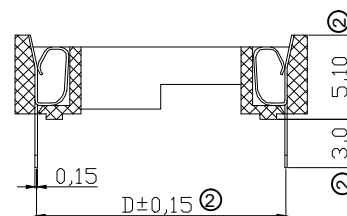
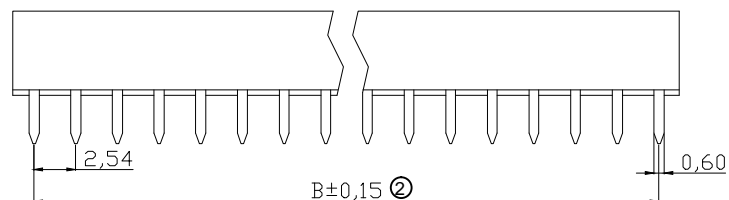

② NOTES:

MATERIAL:

- 1.1 Housing Material: 25%Glass filled PBT, UL94V-0,Black;  
1.2 Contact Material: Phosphor Bronze, Tin plated over Nickel;

ELECTRICAL:

- 2.1 Current Rating: 1AMP;  
2.2 Insulation Resistance: 1000MΩ Min at 500V;  
2.3 Contact Resistance: 30mΩ Max at DC 100mA;  
2.4 Withstand Voltage: 500VAC For 1minute;

3. Operating Temperature: -55°C to +105°C.

B

B

C

C

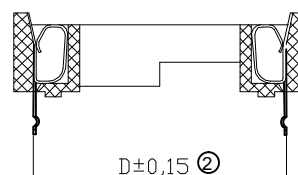
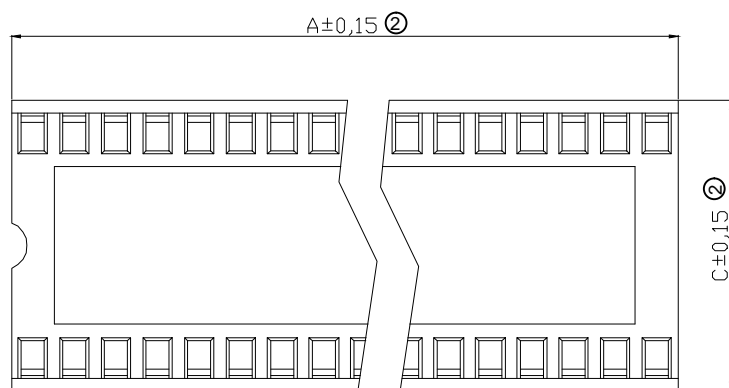

D

D

②③

WSW P/N	Position	Dimension			
		A	B	C	D
A 08-LC-TR	08	10.16	7.62	10.05	7.62
A 14-LC-TR	14	17.78	15.24	10.05	7.62
A 16-LC-TR	16	20.32	17.78	10.05	7.62
A 18-LC-TR	18	22.86	20.32	10.05	7.62
A 20-LC-TR	20	25.40	22.86	10.05	7.62
A 24-LC-TR	24	30.48	27.94	17.6	15.24
A 24-LC-TR01	24	30.48	27.94	10.05	7.62
A 28-LC-TR	28	35.56	33.02	17.6	15.24
A 28-LC-TR01	28	35.56	33.02	10.05	7.62
A 32-LC-TR	32	40.54	38.10	17.6	15.24
A 40-LC-TR	40	50.80	48.26	17.6	15.24
A 42-LC-TR	42	53.21	50.80	17.6	15.24

E

E

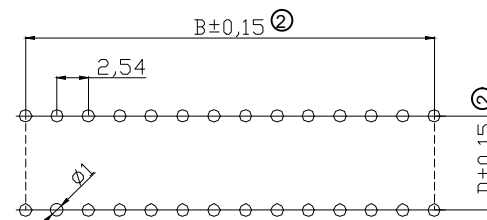

PCB Layout

F

F

G

G

Scale Free

TOLERANCE

X. ±0.38

X.X ±0.25

X.XX ±0.13

DIM TOL

Angle ±3°

Angle TOL

③

②

①

①

Id.

The 48Pin version is EOL

Update the drawing

Update the drawing

Drawn

Modification

19.06.2023

11.06.2021

29.07.2014

26.05.2014

Date

Peter

Segal

Amy

Ray

Name

Date

Drawn

Approved

Name

Ray

Peter

Description: IC Socket

ASSMANN WSW-No.

A xx-LC-TR

Drawing-No.

ASS 6449 CO

rev03

Customer-No.

SHEET  
1 / 1

**RoHS compliant**

Unit:mm

**ASSMANN**  
WSW components

1

2

3

4

5

6

7

H