

LOOSE PIECE		TAPE MOUNTED		SPECIFICATIONS					
MATERIAL NUMBER	ENGINEERING NUMBER	MATERIAL NUMBER	ENGINEERING NUMBER	STUD SIZE	"S" ±.005 [0.13]	"W" ±.010 [0.25]	"C" MIN.	"L" MAX.	"H"
191420003	A-235-06X	---	---	6	.146 [3.71]	.316 [8.02]	.303 [7.70]	.974 [24.74]	---
191420005	A-235-08X	---	---	8	.173 [4.39]				
191420007	A-235-10X	---	---	10	.198 [5.03]				

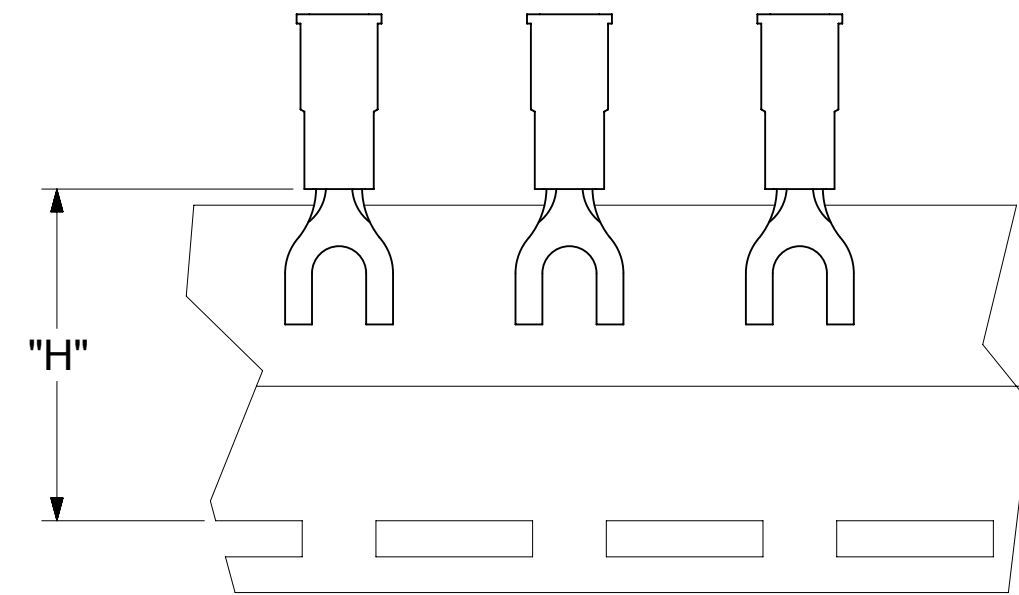
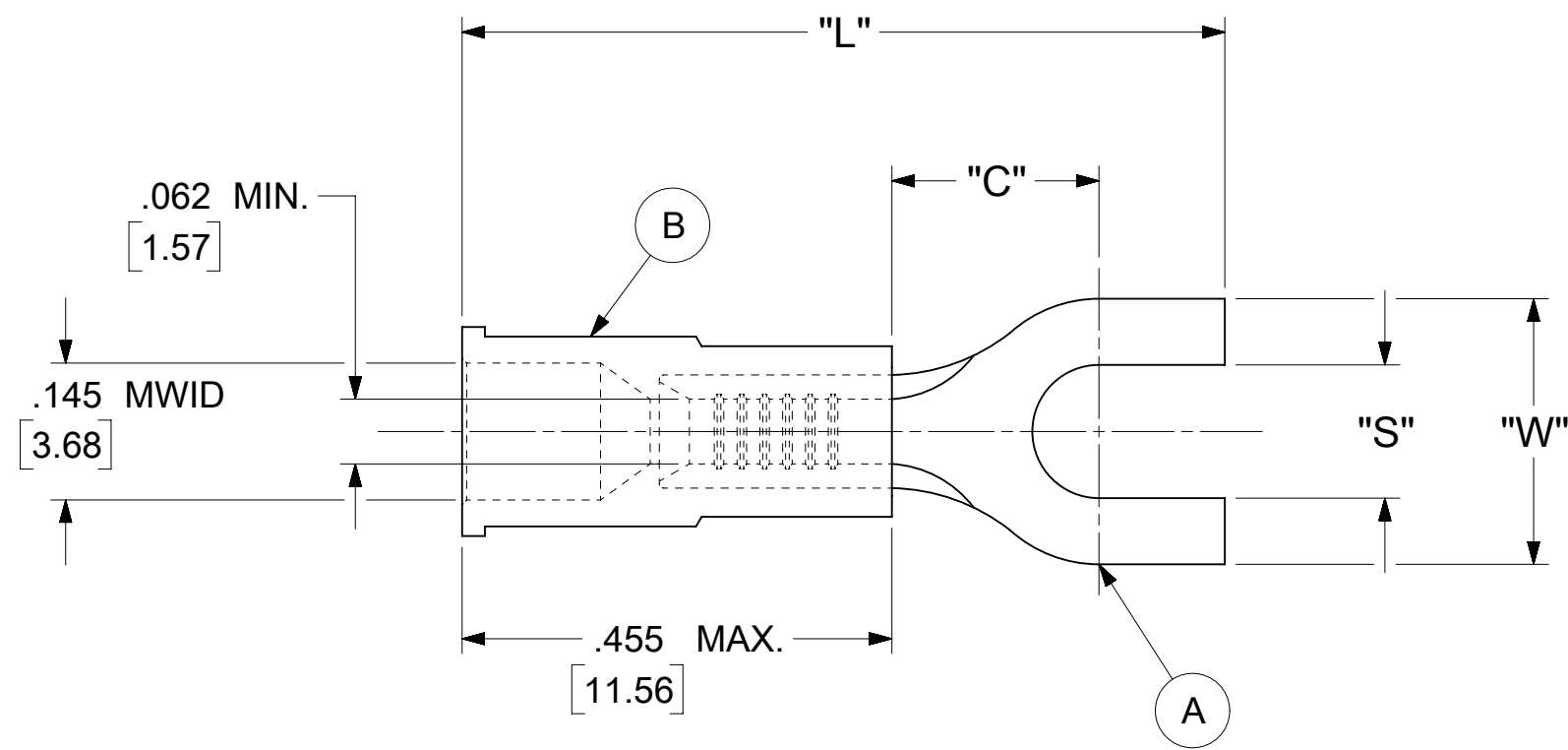

PARTS ON TAPE

NOTES:

1. MATERIAL:

(A). TERMINAL: COPPER (STOCK THICKNESS $.028 \begin{smallmatrix} +.001 \\ -.000 \end{smallmatrix}$ [0.71])

PLATING: ELECTRO-TIN (.0003 MIN.)

(B). INSULATION: MOLDED PVC (RED)

2. MWID: MAXIMUM WIRE INSULATION DIAMETER

3. WIRE SIZE: 22 -18 AWG

0.25 -1.5 MM²

4. "UL" LISTING #E32244

"CSA" LISTING #18689

5. ALL DIMENSIONS IN INCHES/[MM].

6. PARTS ARE ROHS COMPLIANT.

7. DIMS. SHOWN ARE FOR REFERENCE ONLY.

SYMBOLS	THIS DRAWING CONTAINS INFORMATION THAT IS PROPRIETARY TO MOLEX ELECTRONIC TECHNOLOGIES, LLC AND SHOULD NOT BE USED WITHOUT WRITTEN PERMISSION					
	DIMENSION UNITS	SCALE		CURRENT REV DESC: MIGRATION TO ECTR/NX		
$\nabla = 0$	INCH/MM	NTS		molex SPADE TONGUE TERMINAL INSULKRIMP 200-SERIES PRODUCT CUSTOMER DRAWING		
$\nabla = 0$	GENERAL TOLERANCES (UNLESS SPECIFIED)					
$\nabla = 0$		MM	INCH			
$\nabla = 0$	4 PLACES	±	±			
$\nabla = 0$	3 PLACES	±	± 0.005	EC NO: 620268	DRWN: ABENJAMINLW	2019/07/03
$\nabla = 0$	2 PLACES	± 0.13	± 0.01	CHK'D: DMYRICK	2019/07/08	
$\nabla = 0$	1 PLACE	± 0.25	±	APPR: JMACNEIL	2019/07/10	
$\nabla = 0$	0 PLACES	±	±	INITIAL REVISION:		
$\nabla = 0$	ANGULAR TOL ± °			DRWN: JJ	1984/10/24	
$\nabla = 0$	DRAFT WHERE APPLICABLE MUST REMAIN WITHIN DIMENSIONS			APPR: JMACNEIL	2019/07/10	
$\nabla = 0$	THIRD ANGLE PROJECTION		DRAWING	SERIES	DOCUMENT NUMBER	DOC TYPE DOC PART REVISION
			C-SIZE	19142	191420003	PSD 000 A
	SEE TABLE		GENERAL MARKET		SHEET NUMBER	
					1 OF 1	