

### SMA Female Jack to BMA Male Plug

Model Number

**ADT-2769-SF-BMM-02**

**SPECIFICATIONS**

**Frequency:** DC - 18.0 GHz

**VSWR:** 1.05 + .005 f (GHz)

**Impedance:** 50 Ohms

**Finish:** Passivated Stainless Steel

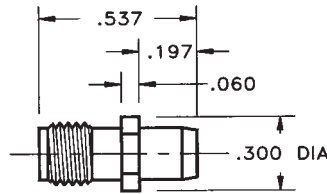

### SMA Female Jack to BMA Male Plug - Bulkhead Mount

Model Number

**ADT-2797-SF-BMM-02**

**SPECIFICATIONS**

**Frequency:** DC - 18.0 GHz

**VSWR:** 1.05 + .005 f (GHz)

**Impedance:** 50 Ohms

**Finish:** Passivated Stainless Steel

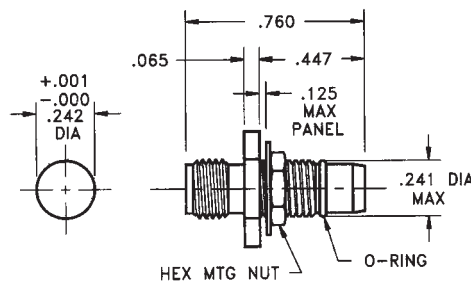

### SMA Male Plug to BMA Male Plug

Model Number

**ADT-2770-SM-BMM-02**

**SPECIFICATIONS**

**Frequency:** DC - 18.0 GHz

**VSWR:** 1.05 + .005 f (GHz)

**Impedance:** 50 Ohms

**Finish:** Passivated Stainless Steel

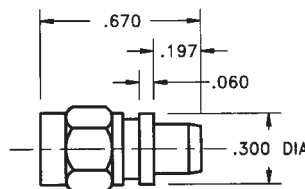

### SMA Male Plug to BMA Male Plug - Bulkhead Mount

Model Number

**ADT-2798-SM-BMM-02**

**SPECIFICATIONS**

**Frequency:** DC - 18.0 GHz

**VSWR:** 1.05 + .005 f (GHz)

**Impedance:** 50 Ohms

**Finish:** Passivated Stainless Steel

