

# Molded SMD Power Inductor

ASPI-8030HS

Request Samples



Check Inventory



8.2 x8.6 x 2.8 mm  
RoHS/RoHS II Compliant  
MSL Level = 1

## Features

- Shielded construction
- Soft saturation
- High Saturation Current
- Designed for switching frequencies between 100KHz-2MHz

## Applications

- DC/DC Switching converters
- Power supplies for Notebooks, workstations, and Servers
- Low Profile applications
- High current, transient load applications
- Applications requiring extended temperature.

## Electrical Specifications

Part Number	Inductance	Tolerance	DC Resistance	Saturation Current	Temperature Rise Current
	0.1MHz/1V		Max	Typ.	Typ.
Units	μH	%	mΩ	A	A
Symbol	L	20%, 30%	DCR	Isat	Irms
ASPI-8030HS-R22	0.22	M, N	1.71	43.0	32.0
ASPI-8030HS-R33	0.33	M, N	2.57	35.0	25.0
ASPI-8030HS-R47	0.47	M, N	3.33	32.0	21.5
ASPI-8030HS-1R0	1.0	M, N	8.35	29.0	13.7
ASPI-8030HS-1R5	1.5	M, N	13.3	24.0	11.0
ASPI-8030HS-2R2	2.2	M, N	20.3	21.0	9.0
ASPI-8030HS-3R3	3.3	M, N	27.4	12.0	7.2
ASPI-8030HS-4R7	4.7	M, N	34.2	10.5	6.6
ASPI-8030HS-5R6	5.6	M, N	37.2	10.0	6.3

## Test Conditions

**Isat:** DC current at which the inductance drops 30% from its value.

**Irms:** DC current that causes the temperature rise ( $\Delta T$ , approximate 40 °C) from 20°C ambient

**Operating Temperature:** -55°C ~ +125°C (including self-temperature rise)

**Storage Condition:** -10°C ~ +40°C and R.H. 70 max

**Operating Voltage:** 50V (across inductor)

ASPI-8030HS Series is **RoHS Compliant and Pb free**

MSL level: 1



5101 Hidden Creek Ln Spicewood TX 78669  
Phone: 512-371-6159 | Fax: 512-351-8858  
For terms and conditions of sales, please visit:  
www.abracon.com

REVISED: 06-28-21

ABRACON IS  
ISO9001-2015  
CERTIFIED

# Molded SMD Power Inductor

ASPI-8030HS

Request Samples



Check Inventory



8.2 x8.6 x 2.8 mm  
RoHS/RoHS II Compliant  
MSL Level = 1

## Marking

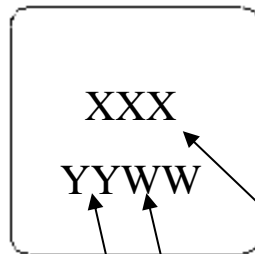

Inductance Code

e.g. 5R6

W: Week: E.g. 05 for the 5<sup>th</sup> week of the year.

Y: Year: E.g. 20 for 2020

Marking Method: Ink

## Part Identification

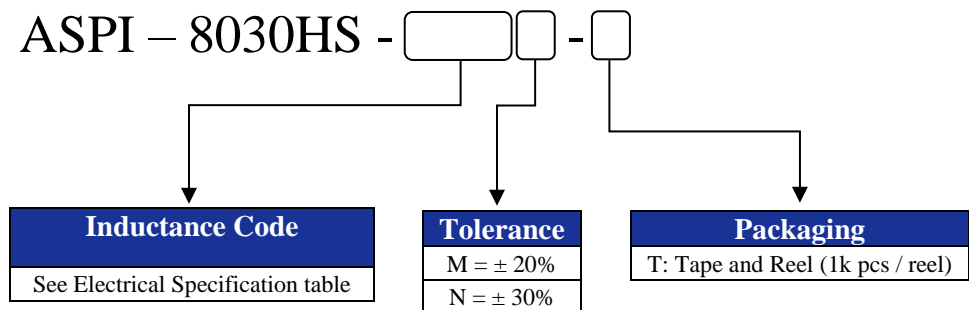

# Molded SMD Power Inductor

**ASPI-8030HS**

Request Samples



Check Inventory



8.2 x 8.6 x 2.8 mm  
**RoHS/RoHS II Compliant**  
 MSL Level = 1

## Mechanical Dimensions

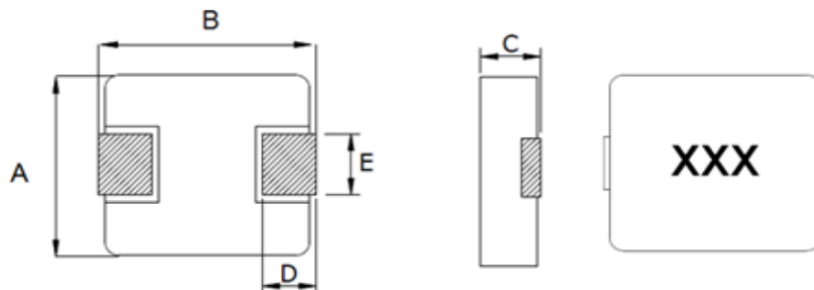

Series	A	B	C	D	E
ASPI-8030HS	8.2 ± 0.3	8.6 ± 0.3	2.8 ± 0.2	1.5 ± 0.3	5.0 ± 0.2

## Recommended Land Pattern

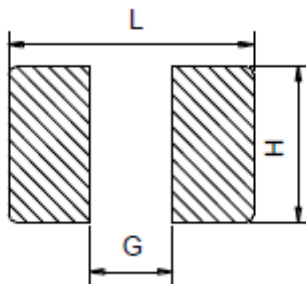

L	G	H
9.6 Ref.	4.8 Ref.	5.3 Ref.

# Molded SMD Power Inductor

ASPI-8030HS

Request Samples



Check Inventory



8.2 x8.6 x 2.8 mm  
RoHS/RoHS II Compliant  
MSL Level = 1

## Materials

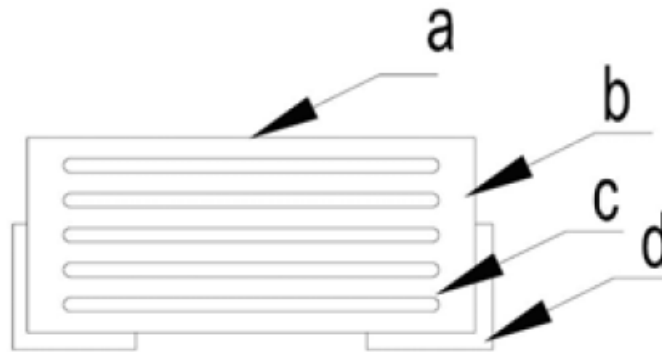

	Components	Material
a	<b>Marking</b>	Ink (black)
b	<b>Core</b>	Metal Alloy
c	<b>Wire</b>	Polyurethane Copper Wire
d	<b>Terminal</b>	Copper plated with Sn

# Molded SMD Power Inductor

ASPI-8030HS

Request Samples



Check Inventory



8.2 x 8.6 x 2.8 mm  
RoHS/RoHS II Compliant  
MSL Level = 1

## Reflow Profile

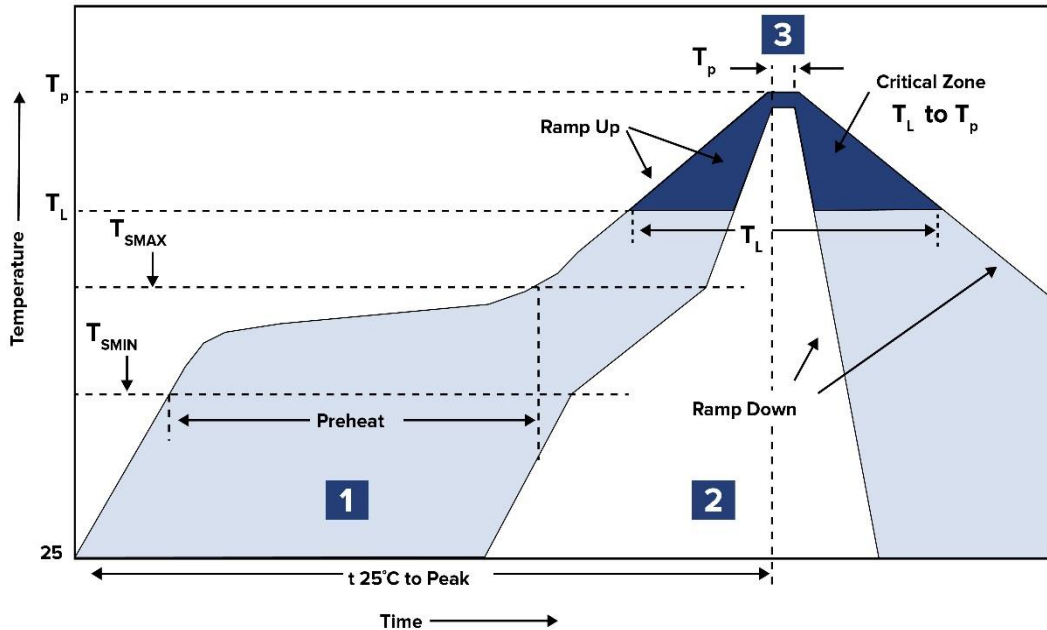

Zone	Description	Temperature	Times
1	Preheat	$T_{SMIN} \sim T_{SMAX}$ 150°C ~ 200°C	60 ~ 120 sec.
2	Reflow	$T_L$ 217°C	60 ~ 90 sec.
3	Peak heat	$T_P$ 260°C±5°C	10 sec. MAX

# Molded SMD Power Inductor

ASPI-8030HS

Request Samples



Check Inventory



8.2 x 8.6 x 2.8 mm  
**RoHS/RoHS II Compliant**  
 MSL Level = 1

## Packaging

Packing (Tape & Reel: 1000 pcs/reel)

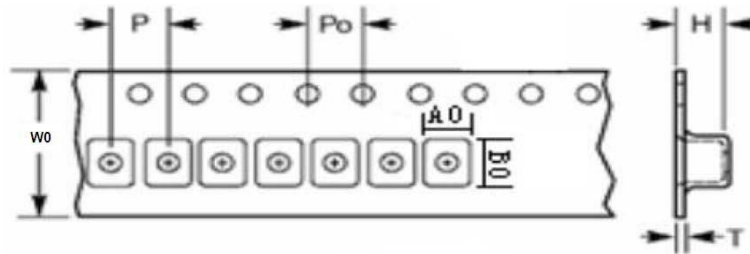

W0	P	P0	H	T	A0	B0
16±0.3	12±0.1	4±0.1	3.3±0.1	0.35±0.05	8.45±0.1	9.65±0.1

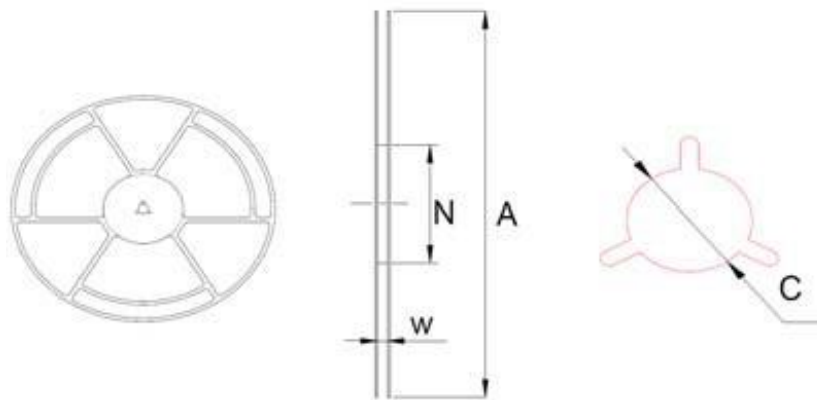

A	N	C	W
330±2.0	100±2.0	13±1.0	16.4±2.0

Dimension: mm

**ATTENTION:** Abracon LLC's products are COTS – Commercial-Off-The-Shelf products; suitable for Commercial, Industrial and, where designated, Automotive Applications. Abracon's products are not specifically designed for Military, Aviation, Aerospace, Life-dependent Medical applications or any application requiring high reliability where component failure could result in loss of life and/or property. For applications requiring high reliability and/or presenting an extreme operating environment, written consent and authorization from Abracon LLC is required. Please contact Abracon LLC for more information.



5101 Hidden Creek Ln Spicewood TX 78669  
 Phone: 512-371-6159 | Fax: 512-351-8858  
 For terms and conditions of sales, please visit:  
[www.abracon.com](http://www.abracon.com)

REVISED: 06-28-21

ABRACON IS  
 ISO9001-2015  
 CERTIFIED