

13	12	11	10	9	8	7	6	5	4	3	2	1	
MATERIAL NO. LOOSE PIECE	ENGINEERING NO. LOOSE PIECE	STUD SIZE	WIRE SIZE	INSULATOR COLOR	ID MINIMUM	DIMENSION S ±.005/0.13	P MINIMUM	MWID	L MAX				
191641139	SAA-238-06	6	22-18 AWG	RED	.062/1.57	.146/3.71	.225/5.72	.235/5.97	1.25/31.8				
191641140	SBB-2471-06	6	16-14 AWG	BLUE	.081/2.06	.146/3.71	.225/5.72	.235/5.97	1.25/31.8				

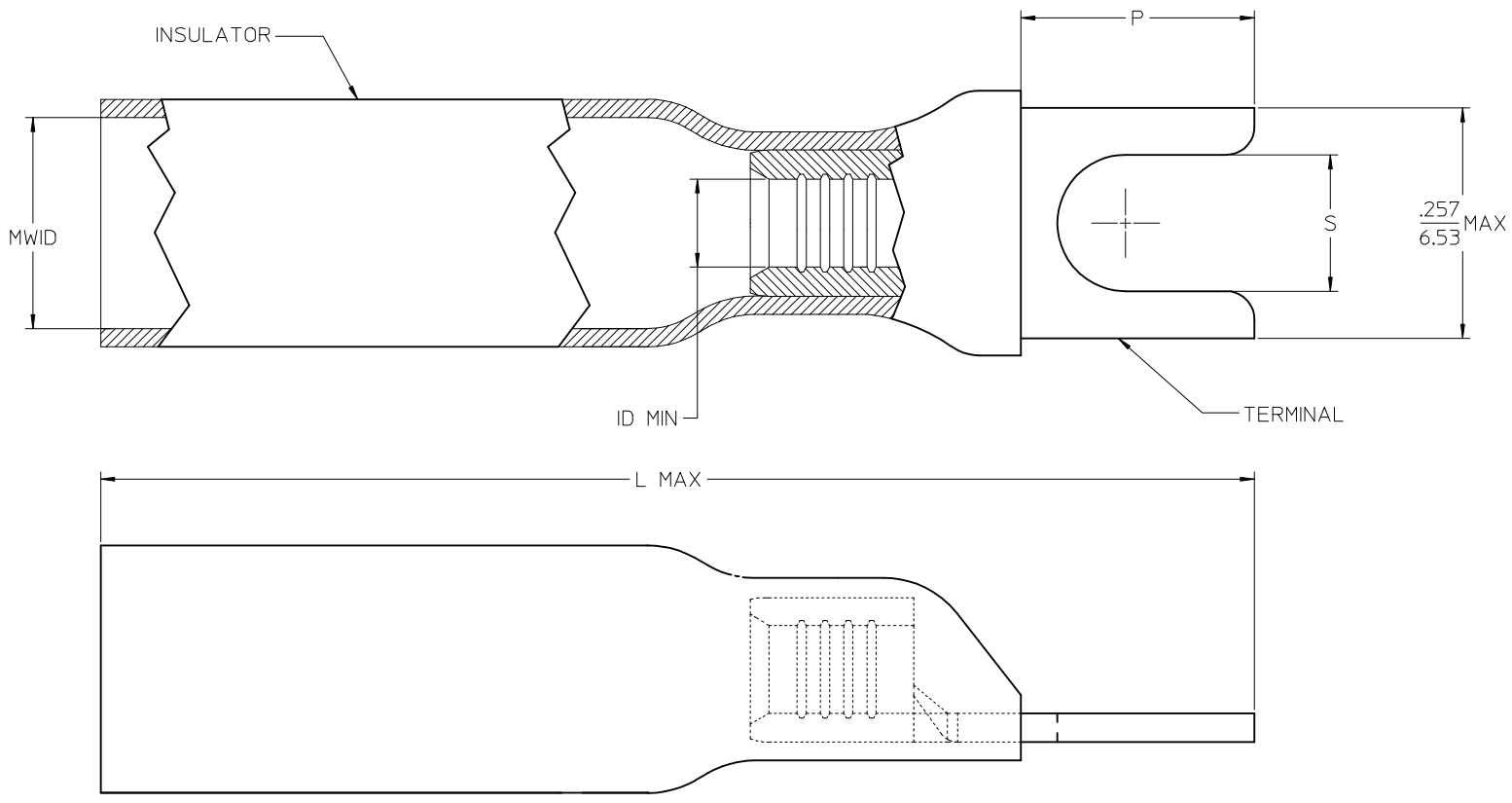

SALES DRAWING

- NOTES:
1. TERMINAL MATERIAL: COPPER.
 2. TERMINAL FINISH: TIN PLATED.
 3. INSULATION MATERIAL: HEAT SHRINKABLE TUBING WITH HOTMELT ADHESIVE INNER LINER. COLOR: SEE CHART.
 4. MWID: MAXIMUM WIRE INSULATION DIAMETER.
 5. PARTS ARE ROHS COMPLIANT.

ENTER DESCRIPTION EC NO: IPG2014-1630 2014/06/24 DRAWING: GROJAS01 2014/06/24 CHKD: JMACNEIL 2014/06/24 APPR: JMACNEIL 2014/11/03	QUALITY SYMBOLS ▽=0 ▽=0	GENERAL TOLERANCES (UNLESS SPECIFIED)		DIMENSION STYLE IN/MM		SCALE --	DESIGN UNITS INCH	THIRD ANGLE PROJECTION		
		4 PLACES ± --- ± ---	mm	INCH	DRAWN BY	DATE	TITLE PERMA-SEAL SPADE TONGUE TERMINAL (BLOCK)			
		3 PLACES ± --- ±.005			CHECKED BY	DATE				
		2 PLACES ± 0.13 ±.01			JMACNEIL	2014/06/24				
1 PLACE ± 0.25 ± ---			APPROVED BY	DATE						
0 PLACE ± --- ± ---			JMACNEIL	2014/11/03						
		ANGULAR ± .5 °		MATERIAL NO.		DOCUMENT NO.		SHEET NO.		
DRAFT WHERE APPLICABLE MUST REMAIN WITHIN DIMENSIONS				SEE CHART		SD-19164-079		1 OF 1		
THIS DRAWING CONTAINS INFORMATION THAT IS PROPRIETARY TO MOLEX INCORPORATED AND SHOULD NOT BE USED WITHOUT WRITTEN PERMISSION										

13	12	11	10	9	8	7	6	5	4	3	2	1	
MATERIAL NO. LOOSE PIECE	ENGINEERING NO. LOOSE PIECE	STUD SIZE	WIRE SIZE	INSULATOR COLOR	ID MINIMUM	DIMENSION S ±.005/0.13	P MINIMUM	MWID	L MAX				
191641139	SAA-238-06	6	22-18 AWG	RED	.062/1.57	.146/3.71	.225/5.72	.235/5.97	1.25/31.8				
191641140	SBB-2471-06	6	16-14 AWG	BLUE	.081/2.06	.146/3.71	.225/5.72	.235/5.97	1.25/31.8				

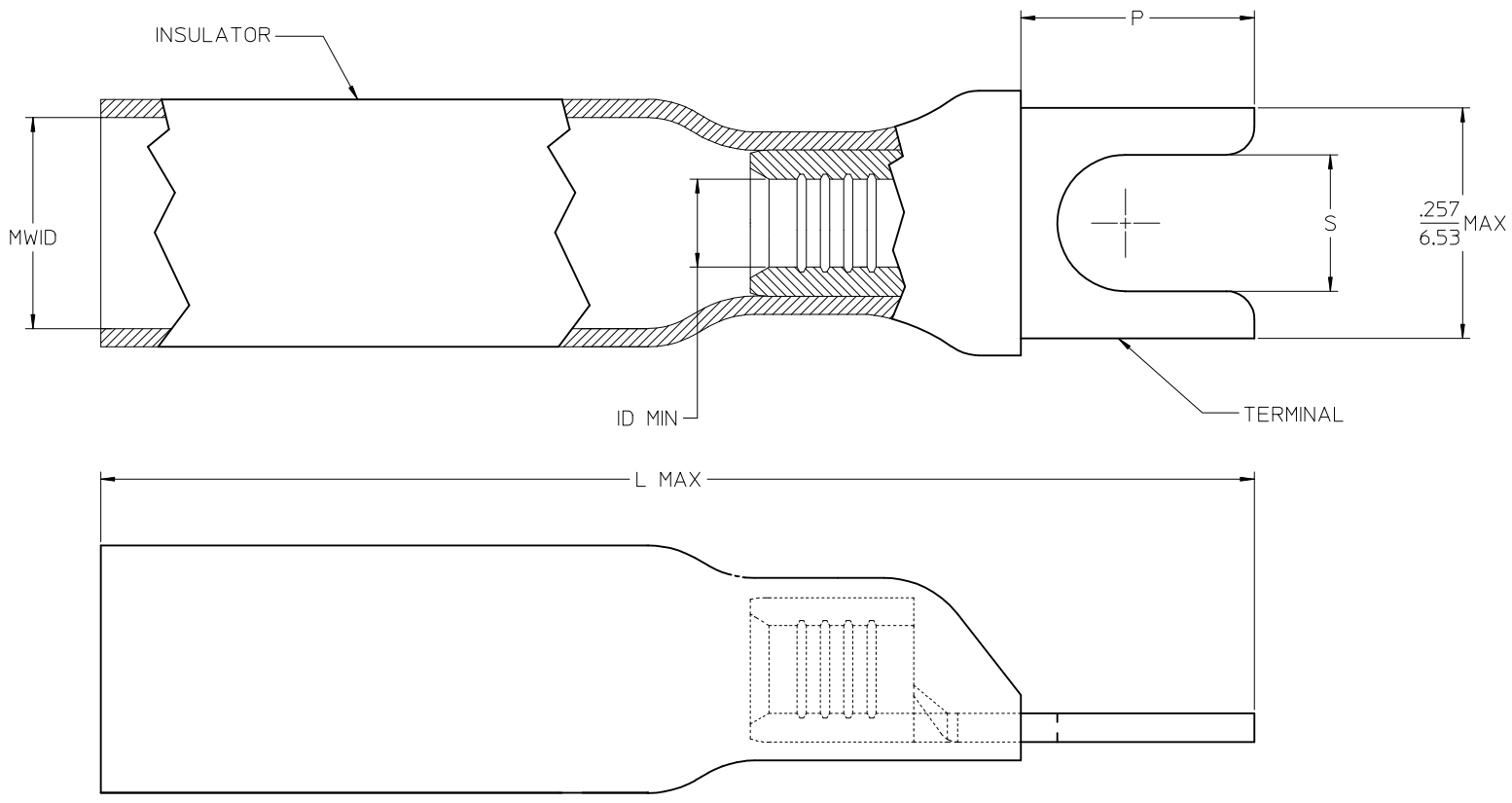

SALES DRAWING

- NOTES:
1. TERMINAL MATERIAL: COPPER.
 2. TERMINAL FINISH: TIN PLATED.
 3. INSULATION MATERIAL: HEAT SHRINKABLE TUBING WITH HOTMELT ADHESIVE INNER LINER. COLOR: SEE CHART.
 4. MWID: MAXIMUM WIRE INSULATION DIAMETER.
 5. PARTS ARE ROHS COMPLIANT.

ENTER DESCRIPTION EC NO: IPG2014-1630 2014/06/24 DRAWING: GROJAS01 2014/06/24 CHKD: JMACNEIL 2014/06/24 APPR: JMACNEIL 2014/11/03	QUALITY SYMBOLS ▽=0 ▽=0	GENERAL TOLERANCES (UNLESS SPECIFIED)		DIMENSION STYLE IN/MM		SCALE --	DESIGN UNITS INCH	THIRD ANGLE PROJECTION		
		4 PLACES ± --- ± ---	mm	INCH	DRAWN BY	DATE	TITLE PERMA-SEAL SPADE TONGUE TERMINAL (BLOCK)			
		3 PLACES ± --- ±.005			CHECKED BY	DATE				
		2 PLACES ± 0.13 ±.01			JMACNEIL	2014/06/24				
1 PLACE ± 0.25 ± ---			APPROVED BY	DATE						
0 PLACE ± --- ± ---			JMACNEIL	2014/11/03						
		ANGULAR ± .5 °		MATERIAL NO.		DOCUMENT NO.		SHEET NO.		
DRAFT WHERE APPLICABLE MUST REMAIN WITHIN DIMENSIONS				SEE CHART		SD-19164-079		1 OF 1		
THIS DRAWING CONTAINS INFORMATION THAT IS PROPRIETARY TO MOLEX INCORPORATED AND SHOULD NOT BE USED WITHOUT WRITTEN PERMISSION										