

Mechanical Dimensions: Inches [mm]

Tolerances ± 0.012 [0.2] Unless Otherwise Specified

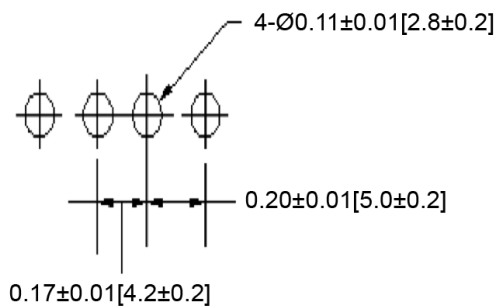

Mounting Holes

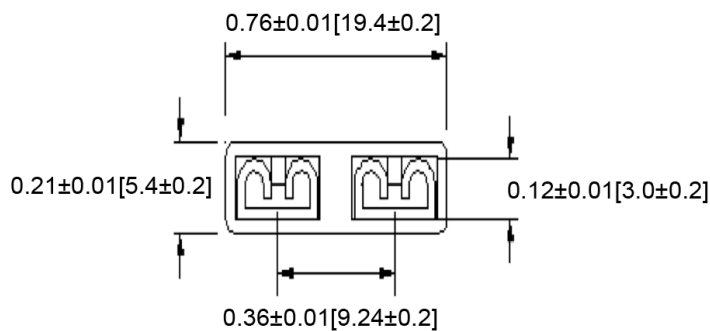
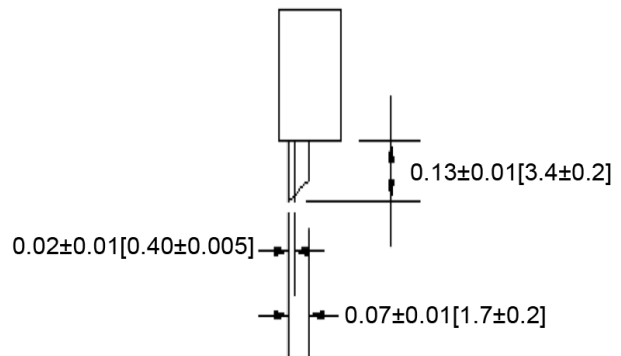
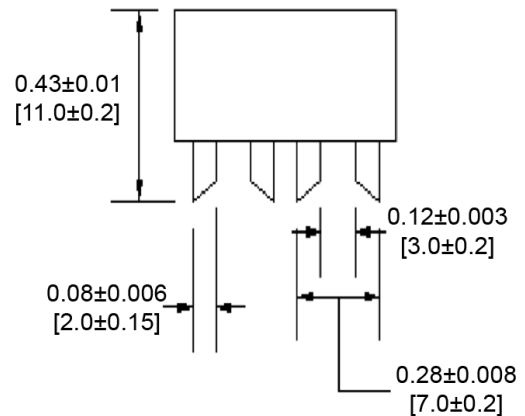

Electrical Specifications

Rated Current	30A
Dielectric Strength	2000VAC Min for 60 sec
Contact Resistance	50mΩ @ 1A DC
Insulation Resistance	100MΩ @500VDC
Operation Temperature	-50°C~145°C

Material Specifications

Insertion/Extraction	2~5 kgf
Terminals Material	Phosphor Bronze, Tin Plated
Body Material	Nylon with Fiber Glass

Rev **Date of issue** **Revision Notes**

Designed **Approved**

B	10-12-2023	format update	RC	OF
---	------------	---------------	----	----