

571 & 572 SERIES PANEL-MOUNT FUSE HOLDERS

571



Description

Panel mount fuse holders are for Midget-Style and Class CC fuses. Class CC fuses have a rejection feature on one end cap, which mates with the rejection feature of Littelfuse Class CC fuses holders to prevent the installation of fuses with lower voltage ratings or interrupting ratings. Watertight version must be front panel mounted.

Dimensions Inches (mm)

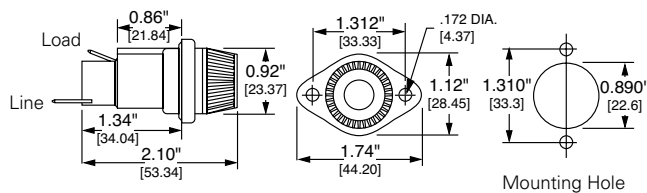

Ordering Information

STANDARD		WATERTIGHT		BOTTOM TERMINAL	FUSE LENGTH RANGE*	FOR USE WITH
CATALOG	ORDERING	CATALOG	ORDERING			
571027	05710027L	571027P	05710027LXP	Straight	1 ⁵ / ₁₆ " – 1 ¹ / ₈ "	Midget Fuses
571028	05710028L	571028P	05710028LXP	Rt. Angle		
571007	05710007L	571007P	05710007LXP	Straight	1 ¹³ / ₃₂ " – 1 ¹ / ₂ "	Midget Fuses
571008	05710008L	571008P	05710008LXP	Rt. Angle		
5710CC	057100CCL	5710CCP	057100CCLXP	Straight	1 ¹ / ₂ "	Class CC Fuses
571RCC	05710RCCL	571RCCP	05710RCCLXP	Rt. Angle		

*Fuse diameter is 1³/₃₂"

Note: Contact factory for versions with pre-assembled wire leads.

Specifications

Voltage Rating 600 V
Ampere Rating 30 A for Class CC and Midget fuses
Dielectric Strength 4000 V Minimum
Terminals Tin-plated brass combination solder & quick-connect
O-Rings 901-184 (body), 901-260 (knob)
Molded Parts Black thermoplastic
Approvals UL Recognized (File: E14721)
 UL Recognized for branch circuit protection (5710CC/RCC)
 CSA Certified (File: LR7316)

Flammability Rating UL94 V-0
Base Temp Rating 110 °C

Web Resources

Additional technical information: Littelfuse.com/571

572



Description

The 572 series panel mount fuse holders are designed to minimize installation time. Its unique design incorporates a snap-mount feature that allows the holder to be installed without any tools or mounting hardware.

Dimensions Inches (mm)

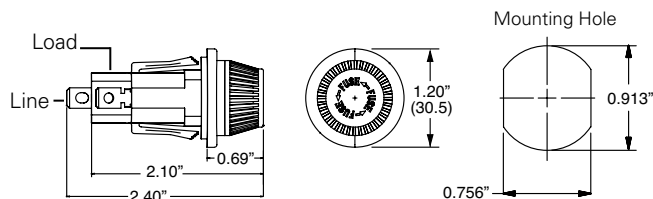

Ordering Information

STANDARD		WATERTIGHT		BOTTOM TERMINAL	FUSE LENGTH RANGE†	FOR USE WITH
CATALOG	ORDERING	CATALOG	ORDERING			
572027	05720027L	572027P	05720027LXP	Straight	1 ⁵ / ₁₆ " – 1 ¹ / ₈ "	Midget Fuses
572028	05720028L	572028P	05720028LXP	Rt. Angle		
572007	05720007L	572007P	05720007LXP	Straight	1 ¹³ / ₃₂ " – 1 ¹ / ₂ "	Midget Fuses
572008	05720008L	572008P	05720008LXP	Rt. Angle		
5720CC	057200CCL	5720CCP	057200CCLXP	Straight	1 ¹ / ₂ "	Class CC Fuses
572RCC	05720RCCL	572RCCP	05720RCCLXP	Rt. Angle		

†Fuse diameter is 1³/₃₂"

Note: Contact factory for versions with pre-assembled wire leads.

Specifications

Voltage Rating 600 V
Ampere Rating 30 A for Class CC and Midget fuses
Dielectric Strength 4000 V Minimum
Terminals Tin-plated brass combination solder & quick-connect
Molded Parts Black thermoplastic
Approvals UL Recognized (File: E14721)
 UL Recognized for branch circuit protection (5720CC/RCC) Class CC version
 CSA Certified (File: LR7316)

Mounting Double "D" punch - Greenlee #61092 (14-18 gauge panel thickness recommended)

Flammability Rating UL94 V-0
Base Temp Rating 110 °C

Web Resources

Additional technical information: Littelfuse.com/572