

This document is the property of Amphenol Corporation and is delivered on the express condition that it is not to be disclosed, reproduced or used, in whole or in part, for manufacture or sale by anyone other than Amphenol Corporation without its prior consent, & that no right is granted to disclose or to use any information in this document.

CUSTOMER DRAWING

REVISIONS				
SYM	ECN	DESCRIPTION	DATE	APPROVED
1	1903****	FIRST RELEASE	2019.03.06	Michael.ip
2	1904****	Add tongue to iron case opening dimensions	2019.04.22	Michael.ip
3	1905****	Increase the size of the iron shell foot position	2019.05.07	Michael.ip
4	1905****	Update package drawing	2019.05.07	Michael.ip
5	1906****	Extended the length dimension of solder tail; Modify the dimension 2.0±0.20; add the spring structure.	2019.06.28	Michael.ip
6	1907****	Change the length dimension of solder tail; Modify the solder width of mid plate.	2019.07.11	Michael.ip

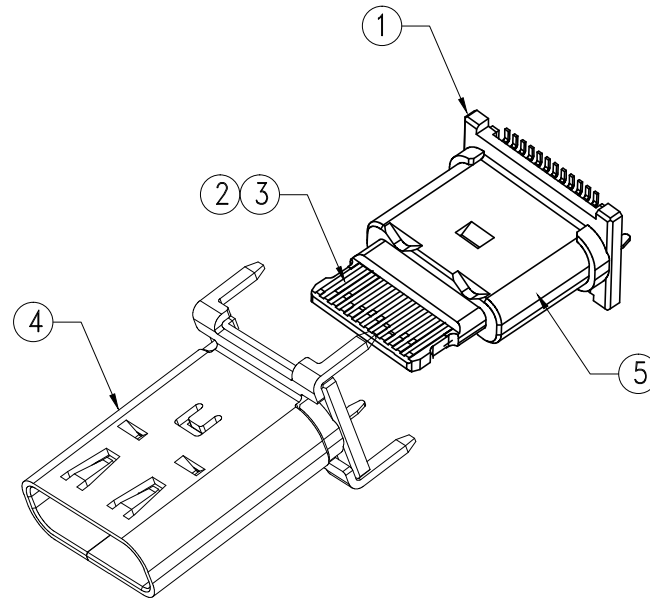
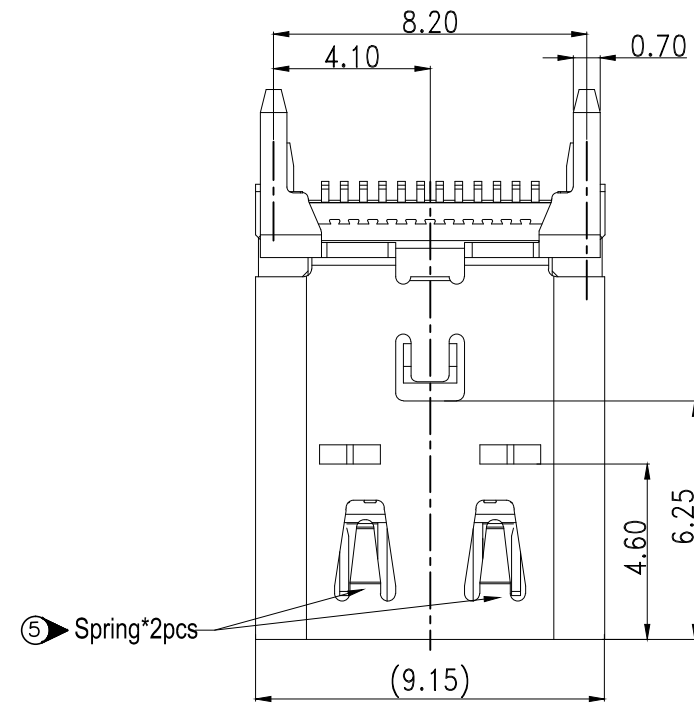

Pin No	Signal Name	Mating Sequence	Pin No	Signal Name	Mating Sequence
A1	GND	First	B12	GND	First
A2	TX1+	Second	B11	RX1+	Second
A3	TX1-	Second	B10	RX1-	Second
A4	VBUS	First	B9	VBUS	First
A5	CC1	Second	B8	SBU2	Second
A6	D+	Second	B7	D-	Second
A7	D-	Second	B6	D+	Second
A8	SBU1	Second	B5	CC2	Second
A9	VBUS	First	B4	VBUS	First
A10	RX2-	Second	B3	TX2-	Second
A11	RX2+	Second	B2	TX2+	Second
A12	GND	First	B1	GND	First

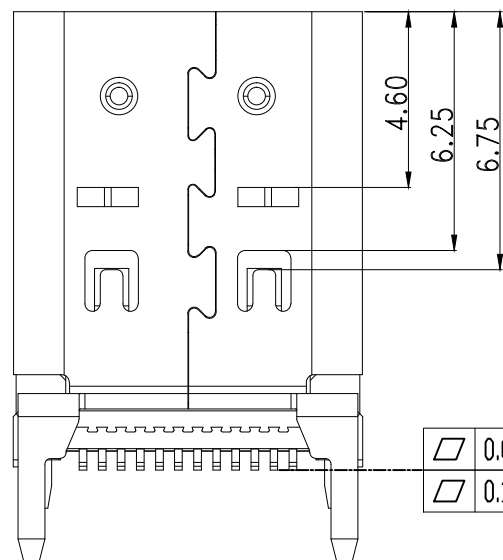
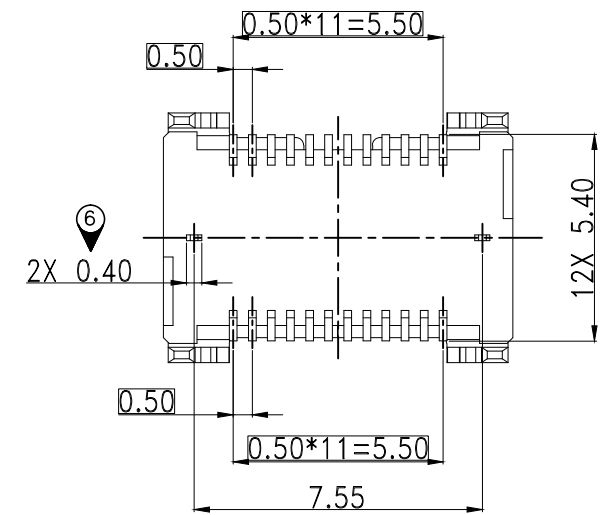
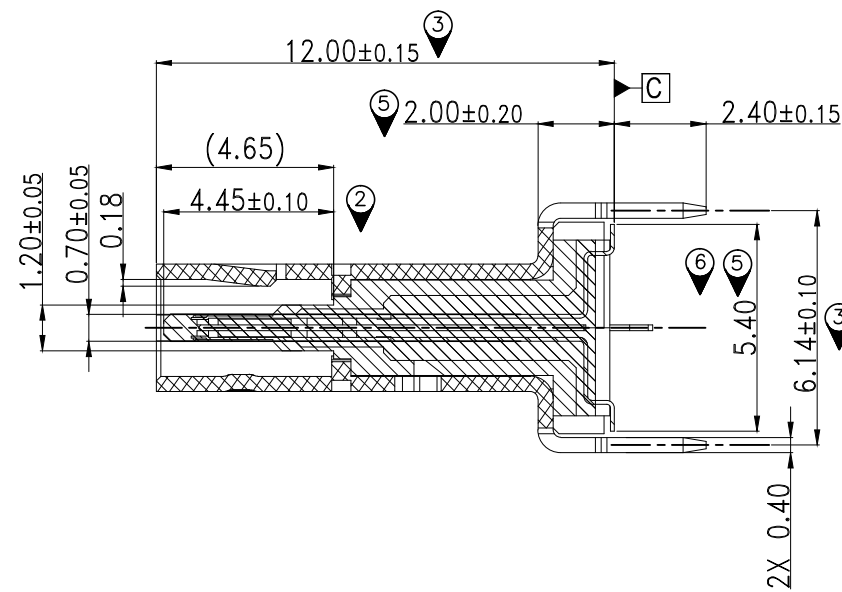
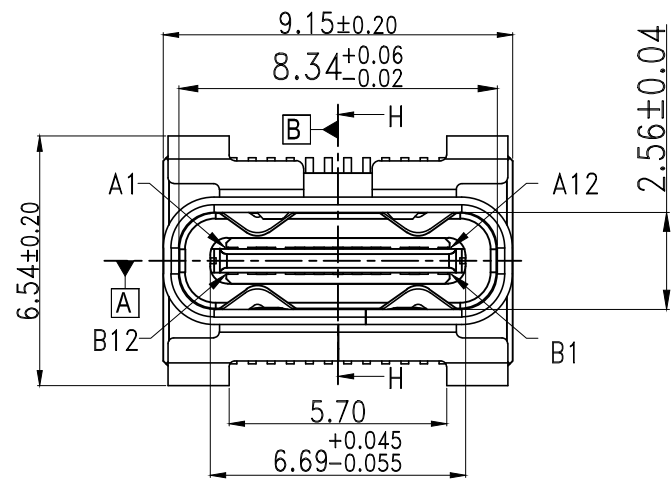

- 0.08 24X SMT Tails (Before IR)
- 0.10 24X SMT Tails (After IR)



Item	Description	Q'TY	Material	
6	Cap	1	High Temperature Plastic	Black,UL 94V-0
5	Mid Plate	1	Stainless Steel	Nickel : 50u" min
4	Main Shell	1	Stainless Steel	Solder Nickel : 50u" min
3	Bottom Terminal	1	Copper Alloy	See NOTES
2	Top Terminal	1	Copper Alloy	See NOTES
1	Molding Housing	1	High Temperature Plastic	Black,UL 94V-0

Bill Of Material

UNLESS OTHERWISE SPECIFIED TOLERANCES		APPROVAL		DATE
U.S. METRIC		DRAWN Allan.Lai		07/11/19
.X	+/- 0.50	CHECKED Michael.Qin		07/11/19
.XX	+/- 0.15	CHECKED Michael.Qin		
.XXX	+/- 0.10	DRAWING FILE :		
FRACTIONS +/-	3°	ANGLE OF PROJECTION		
ANGLES +/-		REMOVE SHARP EDGES		
FOR MATERIALS AND FINISHES SEE NOTES		DIMENSIONS		
U.S. INCHES		U.S. INCHES		
(METRIC) (MM)		(METRIC) (MM)		

Amphenol
Amphenol East Asia Limited

TITLE Customer Drawing For
USB 3.1 ,Type C socket connector,
Vertical type, L=12mm, No Water proof

SIZE	DRAWING NO.	REV.
A3	C 12401951	6
SCALE	NONE	SHEET 1 OF 2

This document is the property of Amphenol Corporation and is delivered on the express condition that it is not to be disclosed, reproduced or used, in whole or in part, for manufacture or sale by anyone other than Amphenol Corporation without its prior consent, & that no right is granted to disclose or to use any information in this document.

CUSTOMER DRAWING

REVISIONS

SYM	ECN	DESCRIPTION	DATE	APPROVED
		please see sheet 1/2		

NOTES:

- Material : See Bill Of Material
- Waterproof : No Waterproof
- Electrical Characteristics:
 - Low Level Contact Resistance: 40mΩ Max
 - Insulation resistance :100MΩ Min
 - Dielectric Withstanding Voltage:100 VAC
 - Contact Current Rating ::5A Max
- Mechanical Characteristics:
 - Insertion Force: 5~20N
 - Extraction Force: 8~20N
 - After Durability Extraction Force: 6~20N
- Durability: 10000 Cycles
- Packaging Type: Carrier Reel.
- Material Should Be Fulfilled Amphenol SPEC# SSN002 And Customer Requirements, For HALOGEN FREE Products, Also Need To Meet SSN004
- Part Number:12401951XX12A

Plating Spec: _____
 E4: Mating Area: Au 30u" Min
 Solder Area: 100u" Min Matte Tin
 50u"Min Nickel Under Plating Over All

A:HF
 Package Spec.
 2:Reel
 Date Code Description
 1:With D/C

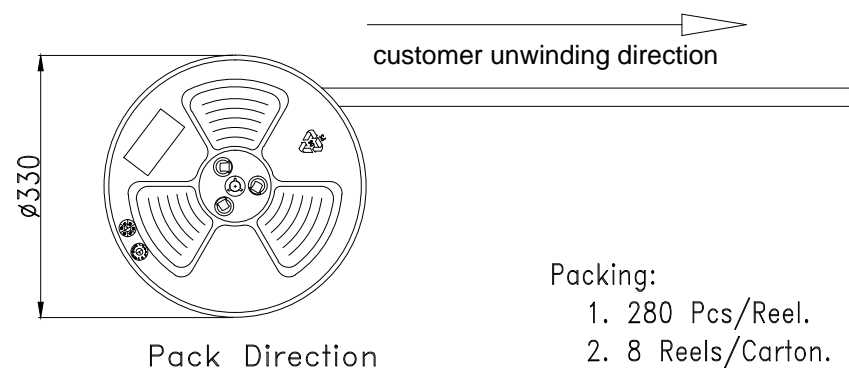
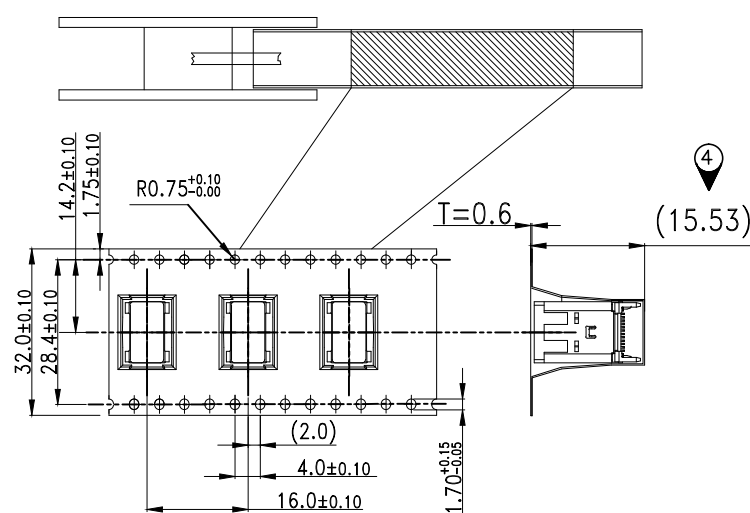
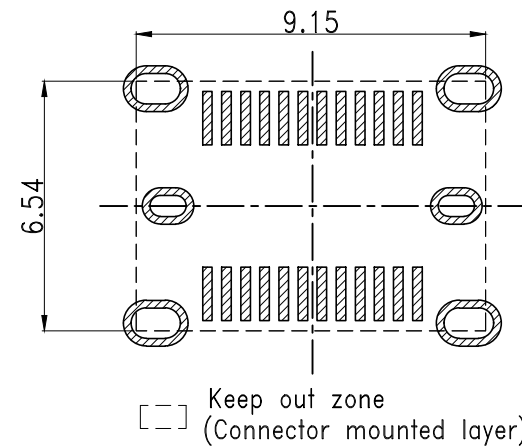
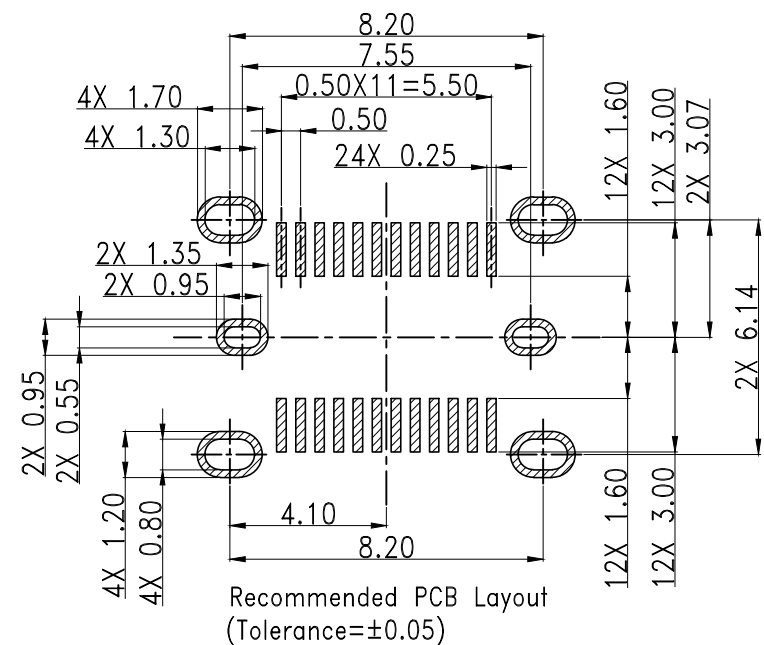

Packing:
 1. 280 Pcs/Reel.
 2. 8 Reels/Carton.

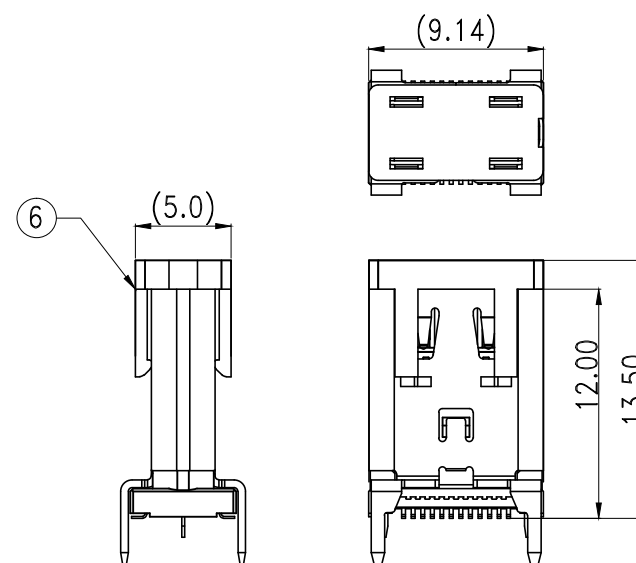

Packing quantity:

UNLESS OTHERWISE SPECIFIED TOLERANCES		APPROVAL	DATE	Amphenol Amphenol East Asia Limited
	U.S. METRIC	Michael.Qin	07/11/19	
.X	+/- 0.50	Michael.Qin	07/11/19	TITLE Customer Drawing For USB 3.1, Type C socket connector, Vertical type, L=12mm, No Water proof
.XX	+/- 0.25			
.XXX	+/- 0.10			SIZE DRAWING NO. REV. A3 C 12401951 6
FRACTIONS +/-	3°			SCALE NONE SHEET 2 OF 2
ANGLES +/-				
FOR MATERIALS AND FINISHES SEE NOTES		DRAWING FILE :		
REMOVE SHARP EDGES		ANGLE OF PROJECTION		
DIMENSIONS				
U.S.	INCHES			
(METRIC)	(MM)			