

REVISIONS			
REV	DESCRIPTION	DATE	APPROVED
A	ECN #7807	01/19/10	A.D.M.

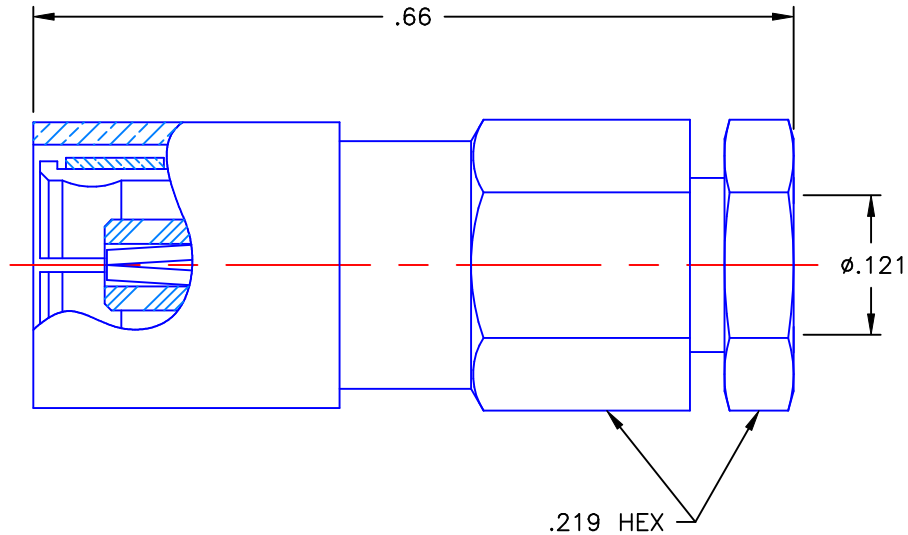

NOTES: COMFORMS TO MIL-PRF-39012 SMB SERIES.

MATERIALS:

- CONTACT & SPRING = BERYLLIUM COPPER PER ASTM B196, ALLOY C17300, TEMPER TD04.
- INSULATOR = VIRGIN WHITE TEFLON PER ASTM D1710, GRADE 1, TYPE I, CLASS "B".
- ALL OTHER METAL PARTS = BRASS PER ASTM B16, ALLOY C36000, TEMPER H02.

FINISHES:

- CONTACT = GOLD PLATE PER MIL-G-45204, TYPE II, CLASS 1, GRADE C, OVER .00010 TO .00020 STRESS FREE SULFAMATE NICKEL PER QQ-N-290.
- ALL OTHER METAL PARTS = NICKEL PLATE PER QQ-N-290, CLASS 1, GRADE G, EXCEPT .0001 TO .0002 THICK OVER .00005 TO .0001 THICK COPPER PER MIL-C-14550.

Property of Radiall Incorporated
This document cannot be reproduced or communicated to a third party without prior written permission of RADIALL Incorporated.

UNLESS OTHERWISE SPECIFIED DIMENSIONS ARE IN INCHES TOLERANCES ON	DWN:	DATE	
	A.D.M.	01/19/10	
	CHKD:	DATE	
DECIMAL	ANGLE	D.N.	01/19/10
		APVD:	DATE
		J.M.	01/19/10



APPLIED ENGINEERING PRODUCTS

104 John W. Murphy Dr.
New Haven, CT 06513

SMB STRAIGHT FEMALE PLUG
CLAMP TYPE
FOR RG-316 & SIMILAR CABLES

REFERENCE:	MATERIALS & FINISHES:
ORIGINATOR: D.N. DATE: 01/19/93	SEE NOTES

SIZE A	FSCM NO. 19505	DWG. NO. 2002-7551-003	REV A
SCALE 6:1	THIRD ANGLE PROJECTION		SHEET 1 OF 1

2002-7551-003