

HAOYU

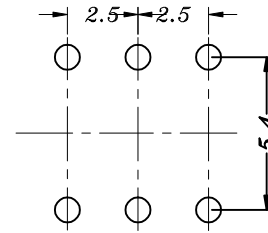

P.C.B LAYOUT

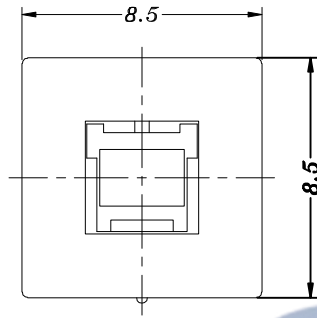
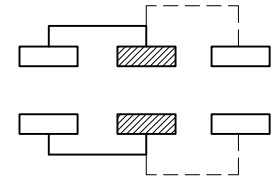

SCHEMATIC

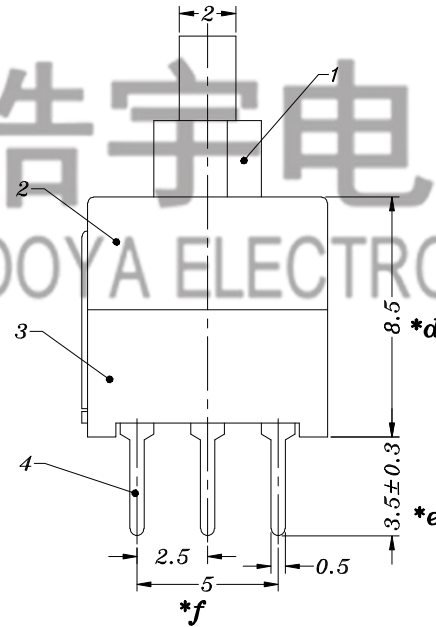
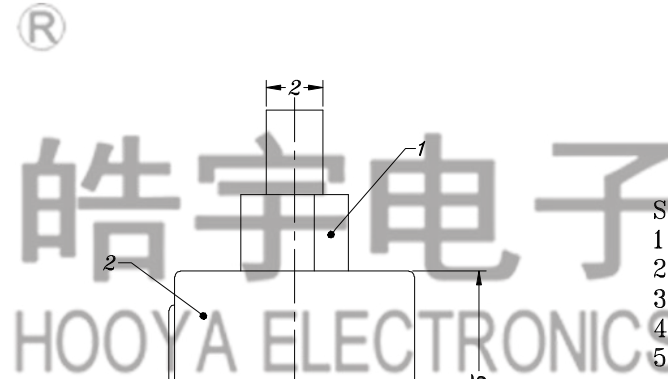
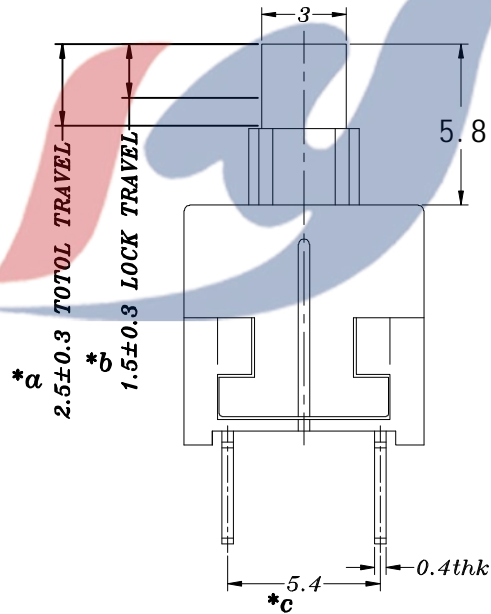

SPECIFICATION

1. Rating: DC 12V 0.3A
2. Function: 2P2T
3. Contact Resistance: $\leq 70m\Omega$ MAX
4. Operating Force: 180±50gf, 250±80gf
5. Life test: 10,000 cycles

电话 : 0769-82320511-867

				TOLERANCE		3	2015.1.20	零件编号填加			
				UNLESS SPECIFIED		2	2014.10.15	盖子材料修正			
				UP TO 5mm: ±0.1	ANGULAR	1	2014.5.19	添加胶柄黑色			
				ABOVE 5mm: ±0.2	±1°	NO	DATE	REVISIONS		BY	APPD
6	PB22E85 SPRING	SUS	1	WASHING	TITLE: PUSH SWITCH		UNIT : MM	ROHS	DWN		
5	PB22E85 CONTACT CLIP	PBS	2	Ag CLAD	MODEL: PB-22E85-N-E		SCALE: 5:1	COMPLIANT	CHK'D		
4	PB22E85 TERMINAL	PA66/0.4mm BRASS	2	BLACK/Ag PLATED	HAOYU(HONGKONG)LIMITED 皓宇(香港)有限公司		APPD		PRO.AGL: REV :A2		
3	PB22E85 CASE	PA66	1	BLACK							
2	PB22E85 COVER	POM/PA66	1	BLACK/蓝灰色							
1	PB22E85-HA KNOB	POM/PA66	1	WHITE/YELLOW/BLACK							
NO.	PART NAME	MATERIAL	QTY	FINISHING							