

SCHEMATIC

P.C.B LAYOUT

注：接触片分两种  
1. 镀铜接触片  
2. 磷铜接触弹线

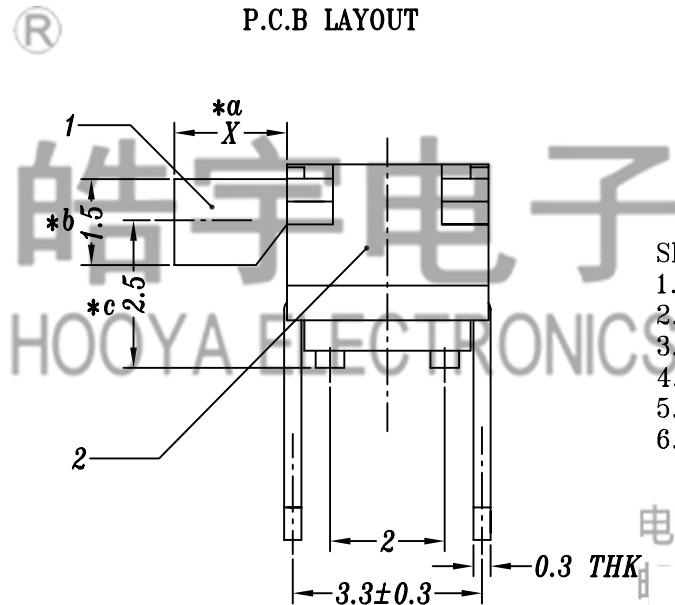
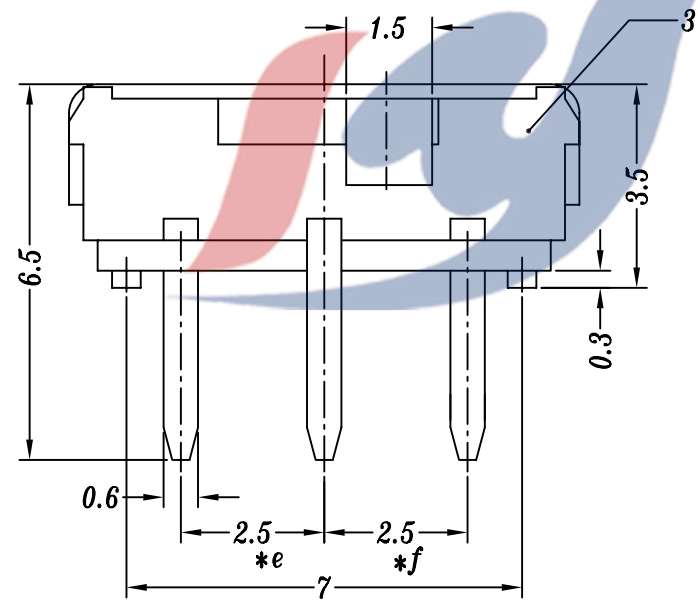

- SPECIFICATION
1. Rating: DC 12V 0.3A
  2. Travel: 2 mm
  3. Function: 1P2T
  4. Contact Resistance:  $\leq 70m\Omega$  MAX
  5. Operating Force:  $130\pm 30gf, 200\pm 80gf$
  6. Life test: 10,000 cycles

电话：0769-82310511-867

				TOLERANCE										
				UNLESS SPECIFIED		A1	2017.5.09	更新BOM信息		GYW				
				UP TO 5mm: $\pm 0.1$	ANGULAR	A0	2016.12.24	首次发行		GYW				
				ABOVE 5mm: $\pm 0.2$	$\pm 1^\circ$	NO	DATE	REVISIONS		BY	APPD			
4	MK22D10 SPRING	BERYLLIUM/PBS	1	Ag PLATED/NATURAL	TITLE:MINI SLIDE SWITCH		UNIT : MM	ROHS COMPLIANT	DWN					
3	NK12D10 CASE	PA6T/0.3mm BRASS STRIP	1	BLACK/Ag(Ni) PLATED	MODEL: MK-12D10G2-B		SCALE: 7:1	CHK'D						
2	MK22D10 COVER	0.2mm SUS	1	WASHING	<b>HAOYU(HONGKONG)LIMITED</b> 皓宇(香港)有限公司							APPD		
1	MK22D10 KNOB	PA66/PA6T	1	WHITE/BLACK								PRO.AGL:		REV :A1
NO.	PART NAME	MATERIAL	QTY	FINISHING										