

# Type RALT Resettable Fuse (PTC's) Battery Strap



www.optifuse.com (619) 593-5050

## Application:

- Rechargeable battery packs
- Lithium cell and battery packs

## Product Features:

Low profile, Solid State

**Operation Current:** 700mA ~ 3.4A

**Maximum Voltage:** 24V

**Temperature Range:** -40°C to 85°C

## Agency Standards and Listings:



## Electrical Characteristics (23°C)

Part Number	Hold Current $I_H, A$	Trip Current $I_T, A$	Rated Voltage $V_{MAX}, V_{dc}$	Max Current $I_{MAX}, A$	Typical Power $P_d, W$	Resistance Tolerance		
						$R_{MIN}$ $\Omega$	$R_{MAX}$ $\Omega$	$R1_{MAX}$ $\Omega$
<b>RALT-070</b>	0.7	1.5	24	100	1.1	0.100	0.200	0.340
<b>RALT-100</b>	1.0	2.5	24	100	1.5	0.070	0.130	0.260
<b>RALT-180</b>	1.8	3.8	24	100	2.0	0.040	0.068	0.120
<b>RALT-190</b>	1.9	4.2	24	100	1.9	0.030	0.057	0.100
<b>RALT-260</b>	2.6	5.2	24	100	2.3	0.025	0.042	0.076
<b>RALT-300</b>	3.0	6.3	24	100	2.0	0.015	0.031	0.055
<b>RALT-310</b>	3.1	6.0	24	100	2.5	0.018	0.030	0.055
<b>RALT-340</b>	3.4	6.8	24	100	2.7	0.016	0.027	0.050

$I_H$  = **Hold Current** – Maximum current at which the device will not trip at 23°C still air.

$I_T$  = **Trip Current** – Minimum current at which the device will always trip at 23°C still air.

$V_{MAX}$  = Maximum voltage device can withstand without damage at it's rated current.

$I_{MAX}$  = Maximum fault current device can withstand without damage at rated voltage (V max).

$P_d$  = Maximum power dissipated from device when in the tripped state in 23°C still air environment.

$R_{MIN}$  = Minimum device resistance at 23°C.

$R1_{MAX}$  = Maximum device resistance at 23°C, 1 hour after tripping.

## Physical Specifications:

**Lead Material:** 0.13mm nominal thickness, quarter hard nickel

**Insulating Material:** Polyester tape

Note: All specifications subject to change without notice.

Rev B 11/2012 - Page: 1/3  
Code F01-01H

# Type RALT Resettable Fuse (PTC's) Battery Strap



www.optifuse.com (619) 593-5050

## RALT Product Dimensions (millimeters)

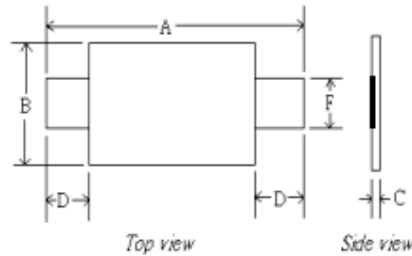

Part Number	A		B		C		D		F	
	Min	Max	Min	Max	Min	Max	Min	Max	Min	Max
RALT-070	19.9	22.1	4.9	5.2	0.7	1.2	5.5	7.5	3.9	4.1
RALT-100	20.9	23.1	4.9	5.2	0.6	1.0	4.1	5.5	3.9	4.1
RALT-180	24.0	26.0	4.9	5.2	0.6	1.0	4.1	5.5	3.9	4.1
RALT-190	21.3	23.4	10.2	11.0	0.5	1.1	5.0	7.6	4.8	5.4
RALT-260	24.0	26.0	10.8	11.9	0.6	1.0	5.0	7.0	5.9	6.1
RALT-300	28.4	31.8	13.0	13.5	0.5	1.1	6.3	8.9	6.0	6.6
RALT-310	24.0	26.0	14.8	15.9	0.6	1.0	5.0	7.0	5.9	6.1
RALT-340	24.0	26.0	14.8	15.9	0.6	1.0	4.0	5.0	5.9	6.1

## Thermal Derating Curve – RALT Series

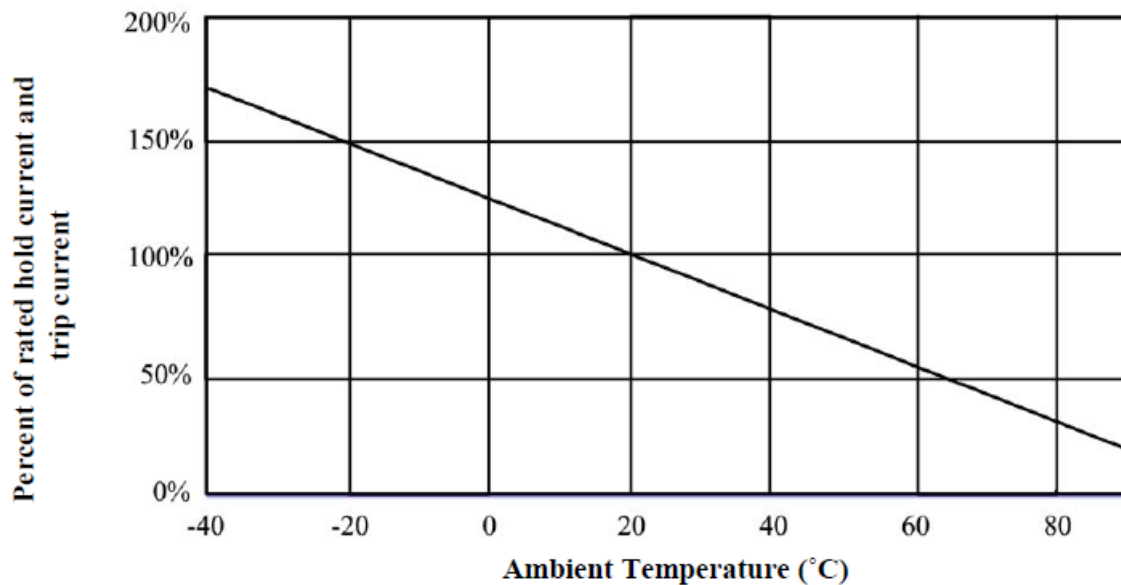

Note: All specifications subject to change without notice.

Rev B 11/2012 - Page: 2/3  
Code F01-01H

# Type RALT Resettable Fuse (PTC's) Battery Strap



www.optifuse.com (619) 593-5050

## Typical Time-To-Trip at 23°C

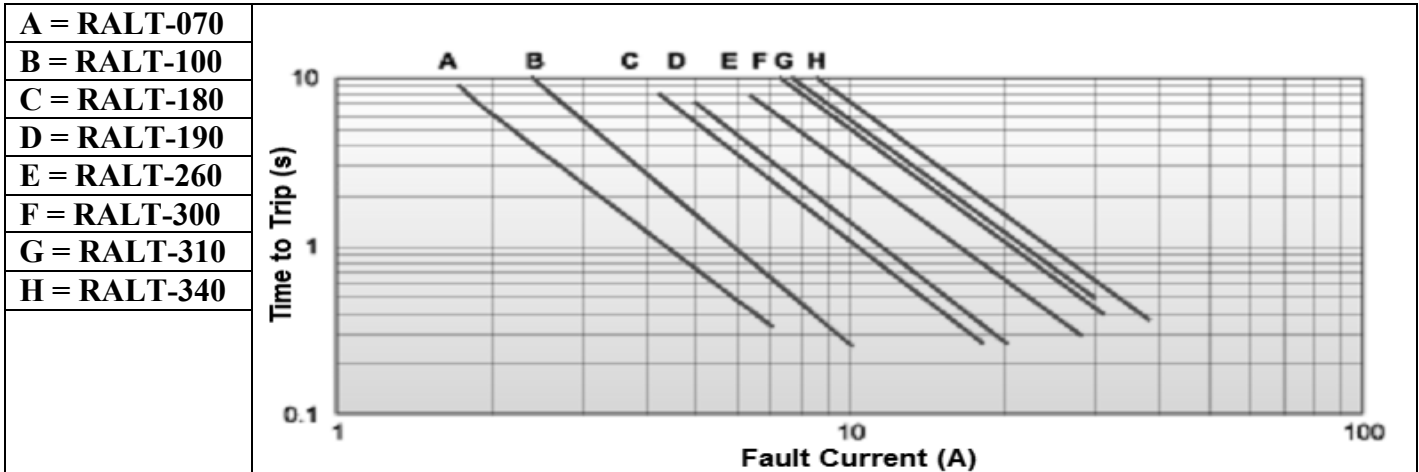

## Standard Package

Part Number	Pcs/Bag
<b>RALT-070</b>	1K
<b>RALT-100</b>	1K
<b>RALT-180</b>	1K
<b>RALT-190</b>	500
<b>RALT-260</b>	500
<b>RALT-300</b>	500
<b>RALT-310</b>	500
<b>RALT-340</b>	500

<p><b>Warning:</b></p>	<p>-Operation beyond the specified maximum ratings or improper use may result in damage and possible electrical arcing and/or flame.</p> <p>-PPTC device are intended for occasional overcurrent protection. Application for repeated overcurrent condition and/or prolonged trip are not anticipated.</p> <p>-Avoid contact of PPTC device with chemical solvent. Prolonged contact will damage the device performance.</p>
------------------------	--

Note: All specifications subject to change without notice.