

LOC	DIST	REVISIONS					
		P	LTN	DESCRIPTION	DATE	DMN	APVD
CM	00	D1		REVISED PER ECR-18-004355	18JUN2018	BDA	SG

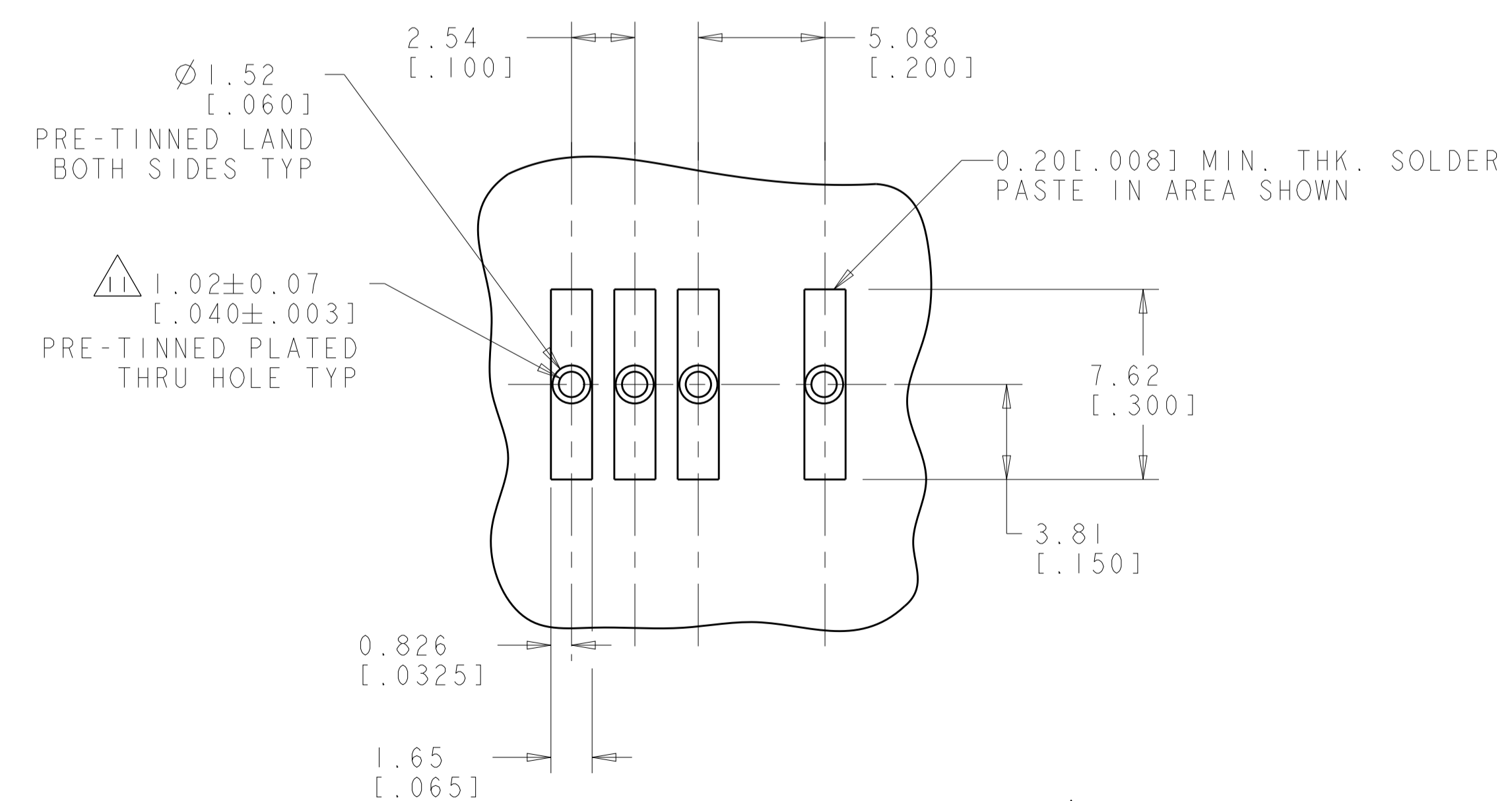
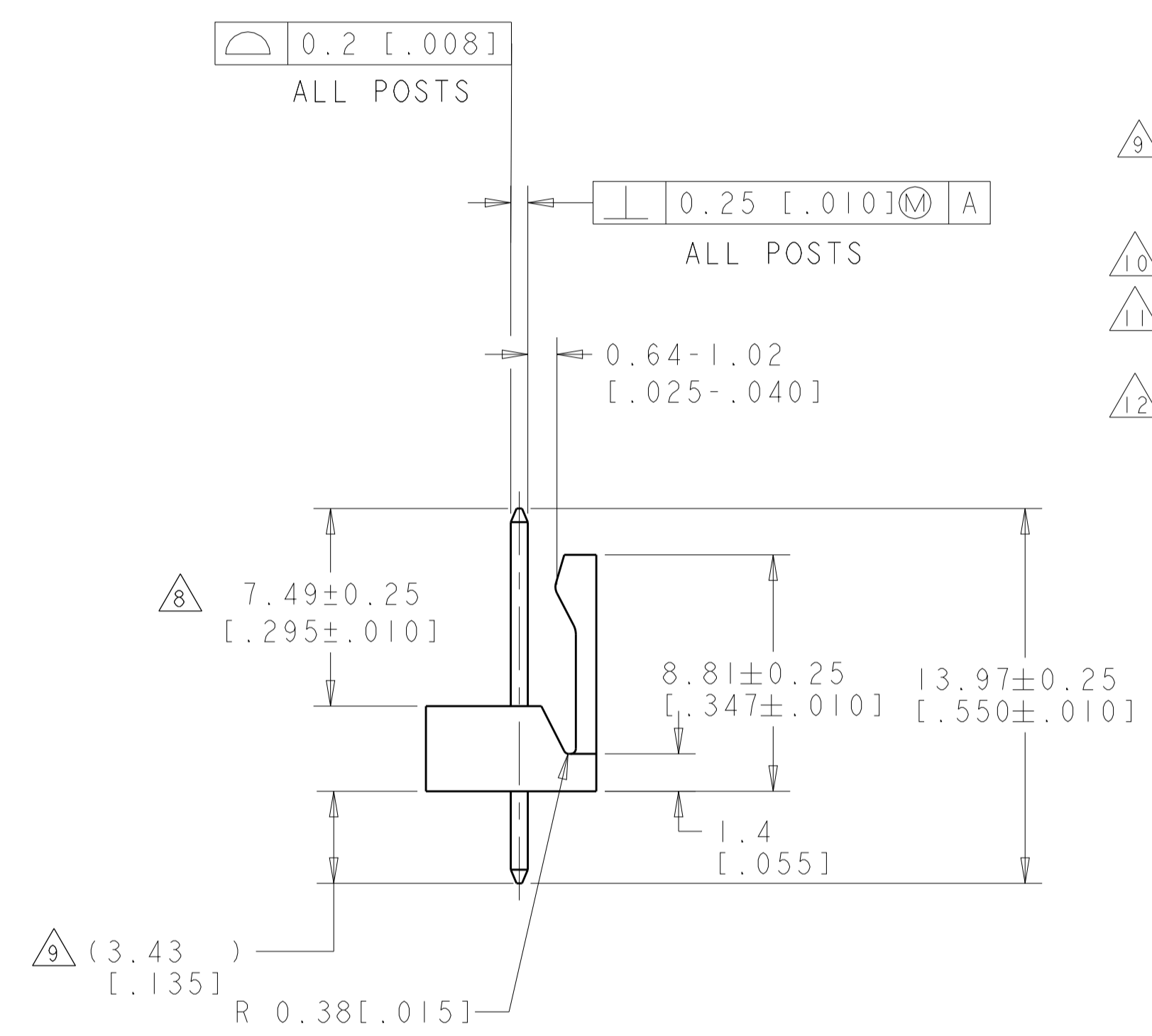
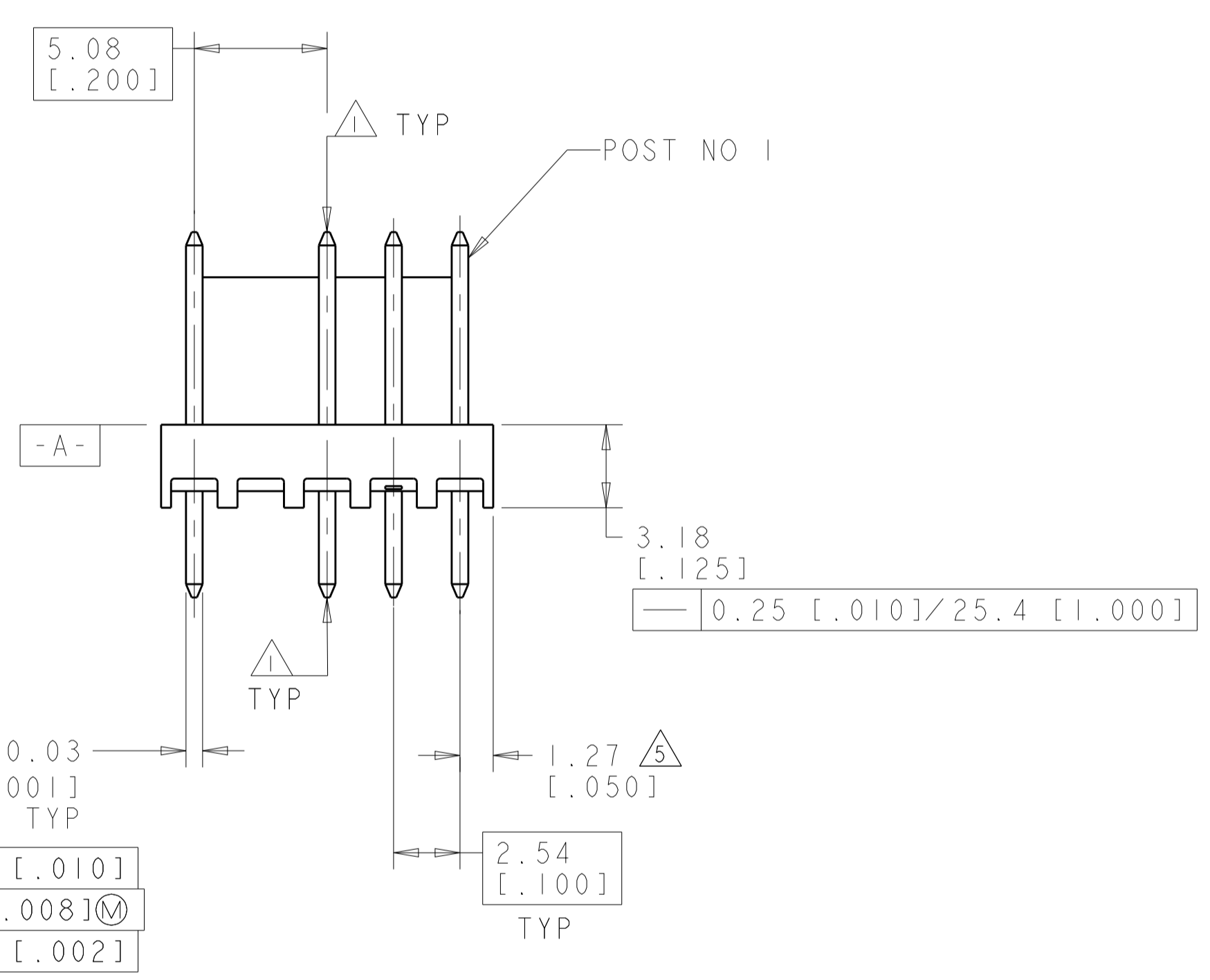
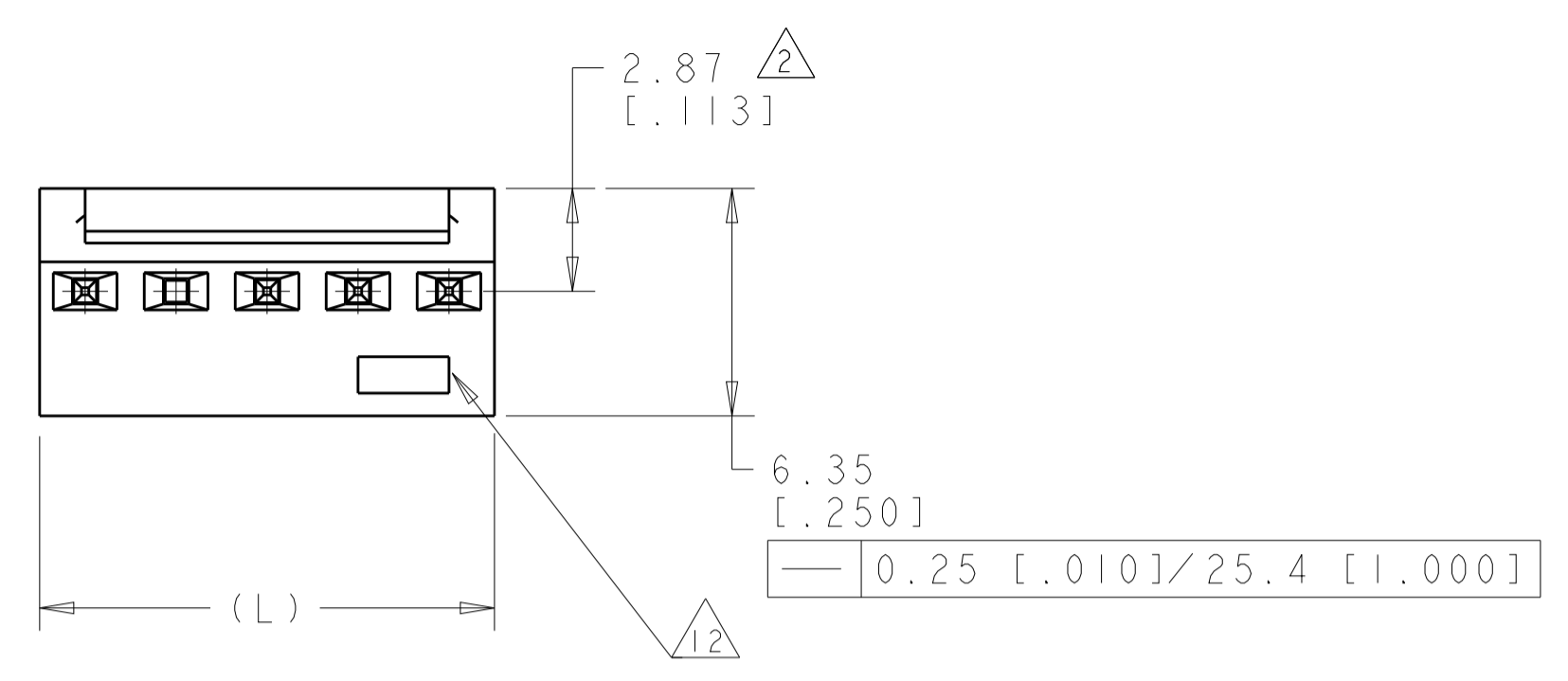

RECOMMENDED MOUNTING HOLE PATTERN  $\Delta 10$  FOR 1.57 ± 0.20 [0.062 ± 0.008] THICK P.C. BOARD

- $\Delta 1$  POST WITHSTAND 13 NEWTONS (3 LBS) MIN AXIAL FORCE IN DIRECTION SHOWN WITHOUT DISLODGING.
- $\Delta 2$  MEASURED AT [-A-].
- 3. PARTS COMPLY WITH SOLDERABILITY SPEC 109-11-2.
- $\Delta 4$  MATERIAL: HOUSING: NYLON, 4/6, HIGH TEMP, BLACK. POST: COPPER ALLOY (SEE NOTES 8 & 9 FOR PLATING.)
- $\Delta 5$  COORDINATE DIMENSION APPLIES FROM CENTER OF ACTUAL FEATURE.
- $\Delta 6$  POSTS TO BE MEASURED WHEN STRIP HELD FLAT.
- 7. DIMENSIONS IN BRACKETS ARE IN INCHES.
- $\Delta 8$  PLATING: GOLD PLATE AREA, 0.00038 [0.000015] GOLD OR 0.00008 [0.000003] MIN GOLD FLASH OVER 0.00030 [0.000012] PALLADIUM NICKEL PER TE CONNECTIVITY'S DISCRETION, ALL SIDES, OVER NICKEL UNDERPLATE, 0.00127 [0.000050] MIN, ALL SIDES AND ENTIRE LENGTH OF POST.
- $\Delta 9$  PLATING: MATTE TIN PLATE AREA, 0.00381-0.00889 [0.000150-.000350] THICK, ALL FOUR SIDES 3.18 [0.125].
- $\Delta 10$  TOLERANCES APPLY TO SOLDER SIDE OF BOARD.
- $\Delta 11$  ONE HOLE MAY BE UNDERSIZED 0.81-0.90 [0.032-.035] DIAMETER FOR ASSEMBLY RETENTION DURING PROCESSING.
- $\Delta 12$  TE LOGO, UL, AND CSA TRADEMARKS TO APPEAR ON THIS SURFACE.

YES	4	12.70 [0.500]	5	1744053-1
LEAD FREE	OMIT POST(S) NO.	L	NO OF POSN	PART NO

THIS DRAWING IS A CONTROLLED DOCUMENT.

DIMENSIONS: mm [INCHES]	TOLERANCES UNLESS OTHERWISE SPECIFIED:	DMN: R. WHITAKER 13APR04	CHK: D. BOSSI 13APR04	APVD: D. BOSSI 13APR04	NAME: MTA-100 HEADER ASSY, HIGH TEMPERATURE FRICTION LOCK, .025 SQUARE, STRAIGHT POST, .000015 GOLD, OMIT POST 4
0 PLC ±	1 PLC ±	2 PLC ±	3 PLC ±	4 PLC ±	APPLIC. SPEC
ANGLES	FINISH	WEIGHT	SIZE	CAGE CODE	DRAWING NO
			A1	00779	C=1744053

CUSTOMER DRAWING SCALE 5:1 SHEET 1 OF 1 REV D1