

CATEGORY	DESCRIPTION	P/N #
CONNECTOR	Modular Jack, 8P8C, Straddle SMT	MJ88B-BX11-RVSLX1-X

变更料号由原MJ88B-BX11-RVSLXX
变更为 MJ88B-BX11-RVSLX1-X

REV.	ECN NO	DESCRIPTION	REVISED	DATE
A02	—	变更料号, 新增包装选项	XSY	2016.05.30
A03	ECN20180129002	变更端子结构, 缩短端子脚长	XSY	2018.01.27
A04	—	新增胶带热封包装	LXY	2020.09.08

SPECIFICATIONS:

1. RJ Electrical Characteristics
 - 1-1: Voltage: 150V AC RMS
 - 1-2: Current Rating: 1.5A
 - 1-3: Contact Resistance: 40mΩ MAX.
 - 1-4: Insulation Resistance: 500MΩ MIN.
 - 1-5: Dielectric Withstand Voltage : 1000V AC
 - 1-6: Operate Temperature: -40°C~80°C

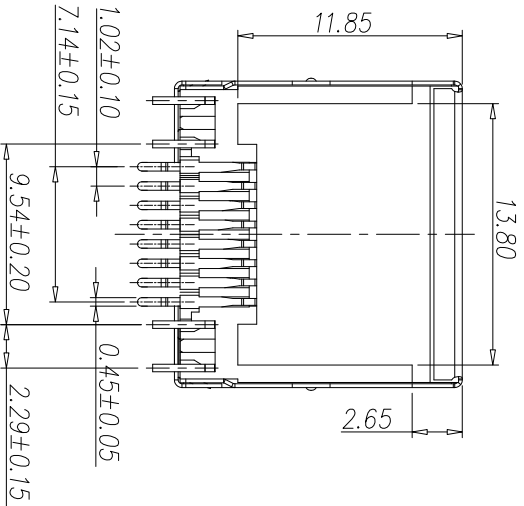
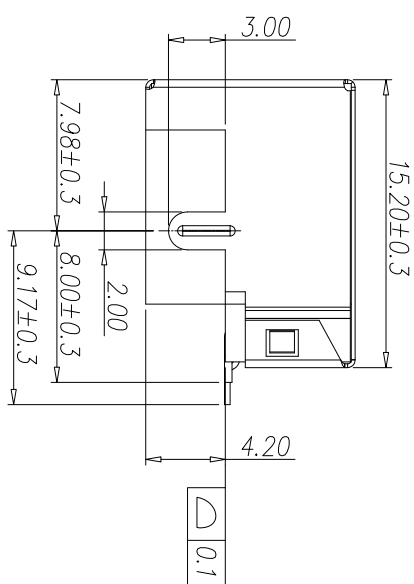
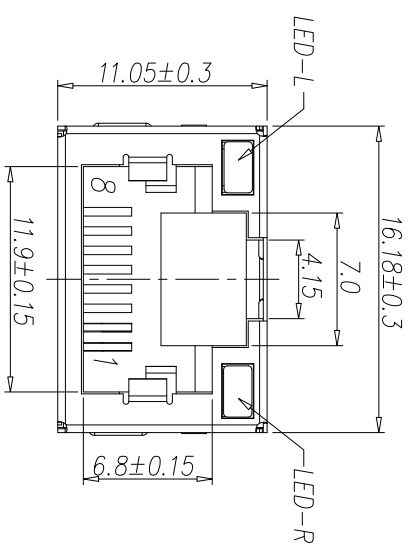

MJ88B-BX11-RVSLX1-X

Table 1

X	Terminal Plating
0	Au 1u" Plating
1	Au 3u" Plating
2	Au 6u" Plating
3	Au 15u" Plating
4	Au 30u" Plating

Table 2

X	包装方式
C	载带包装
P	吸塑盒包装
C1	载带热封包装

Table 2

X	LED-L	LED-R
1	Green	Yellow
2	Yellow	Green

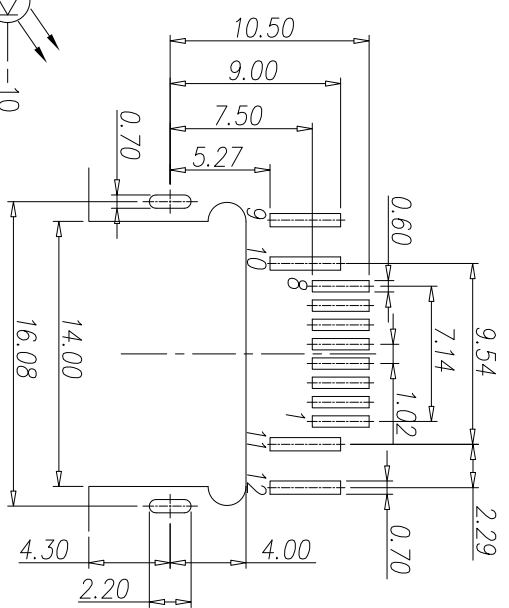
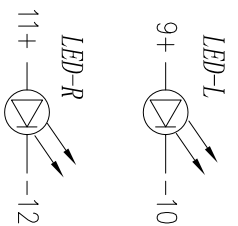

Recommend PCB layout
(Jack Top View)
Tolerance: ±0.05mm

NO.	PART NAME	QTY	MATERIAL
e	LED-R	1	See Table 2
d	LED-L	1	See Table 2
c	Shielding	1	Brass, T=0.2mm
b	Terminal	8	Phosphor Bronze, T=0.3mm
a	Housing	1	LCP UL94V-0

NO.	PART NAME	QTY	MATERIAL
e	LED-R	1	Tin Plating
d	LED-L	1	Tin Plating
c	Shielding	1	Ni Plating
b	Terminal	8	See Table 1
a	Housing	1	Black

UNLESS OTHERWISE SPECIFIED TOLERANCES
DECIMALS: ANGLES:
X : ±0.5 X : ±2°
X.X : ±0.3 X.X : ±1°
X.XX : ±0.2

SCALE: 1/1	UNIT: mm	DWG.NO:
SIZE: A3	PAGE: 1 OF 1	REV: A04
APPROVED BY	CHECKED BY	PREPARED BY
DICK	XSY	LXY

东莞市合陵电子有限公司
DongGuan Heling Electronic Co.,LTD

CUSTOMER COPY